

Site Data:
 Dillon's Store #49
 10222 W. 21st Street N.
 Wichita, KS 67205
 Zoning: LC (Limited Commercial)
 Parcel Size: 10.19 Acres
 Minimum Required Setbacks:
 20' Front Yard
 10' Rear Yard
 No Side Yard Setback

PICKERING FIRM INCORPORATED UNDERGROUND UTILITIES DISCLAIMER
 INFORMATION REGARDING THE REPUTED PRESENCE, SIZE, CHARACTER AND LOCATION OF EXISTING UNDERGROUND UTILITIES AND STRUCTURES RELATED TO UNDERGROUND UTILITIES IS SHOWN HEREON. THERE IS NO CERTAINTY OF THE ACCURACY OF THIS INFORMATION AND IT SHALL BE CONSIDERED IN THAT LIGHT BY THOSE USING THIS DRAWING. THE LOCATION AND ARRANGEMENT OF UNDERGROUND UTILITIES AND STRUCTURES RELATED TO UNDERGROUND UTILITIES SHOWN HEREON MAY BE INACCURATE AND UTILITIES AND STRUCTURES RELATED TO UNDERGROUND UTILITIES NOT SHOWN MAY BE ENCOUNTERED. THE OWNER, HIS EMPLOYEES, HIS CONSULTANTS AND HIS CONTRACTORS SHALL HEREBY DISTINCTLY UNDERSTAND THAT THE ENGINEER IS NOT RESPONSIBLE FOR THE CORRECTNESS OF SUFFICIENCY OF THIS INFORMATION REGARDING THE UNDERGROUND UTILITIES AND STRUCTURES RELATED TO UNDERGROUND UTILITIES SHOWN HEREON.

WATER/SEWER SEPARATION NOTES:
 1. WATER MAINS SHALL BE LAID AT LEAST 10' HORIZONTALLY AND 24" VERTICALLY FROM ANY SEWER OR MANHOLE (WATER OVER SEWER).
 2. WHERE LOCAL CONDITIONS PREVENT ADEQUATE VERTICAL SEPARATION, THE SANITARY SEWER MUST BE CONSTRUCTED OF DUCTILE IRON, PVC, OR REINFORCED CONCRETE, THE SEWER LINE MUST MEET REQUIREMENTS OF THE CITY OF WICHITA STANDARD SPECIFICATIONS, AND MUST BE PRESSURE TESTED PURSUANT TO CHAPTER VI OF THE KDH MINIMUM STANDARD OF DESIGN OF WATER POLLUTION CONTROL FACILITIES.
 3. JOINTS IN THE SEWER PIPE SHALL BE LOCATED A MINIMUM OF 10' FROM THE INTERSECTED WATER MAIN.
 4. WHERE A WATER MAIN IS LAID BELOW THE SANITARY SEWER, REGARDLESS OF CLEAR SPACE, THE SANITARY SEWER SHALL BE REINFORCED CONCRETE ENCASED FOR A DISTANCE OF TEN FEET EACH WAY FROM THE WATER LINE CROSSING.

SPECIAL FLOOD HAZARD STATEMENT
 BY GRAPHIC DETERMINATION, THE SUBJECT PROPERTY IS LOCATED WITHIN ZONE C, AN AREA DESCRIBED AS HAVING MINIMAL FLOODING PER FEMA/FIRM MAP NUMBER 200321 0125 A, CITY OF WICHITA, KANSAS, SEDGWICK COUNTY, EFFECTIVE DATE OF JUNE 3, 1986.

SEWER NOTES:
 1. THE CONTRACTOR SHALL BE RESPONSIBLE FOR NOTIFYING ANY UTILITY COMPANY WHICH MAINTAINS A UTILITY LINE WITHIN THE BOUNDARIES OF THE PROJECT PRIOR TO THE INITIATION OF ANY CONSTRUCTION ON THE PROJECT OR IN THE STREETS BORDERING THE PROJECT. THE CONTRACTOR SHALL ALSO ASSUME THE RESPONSIBILITY FOR ANY DAMAGE INCURRED BY ANY UTILITY COMPANY, TO THEIR LINES, WHETHER SHOWN ON THE CONSTRUCTION PLANS OR NOT, DURING WORK ON THE PROJECT.
 2. ALL SANITARY SEWER MATERIALS, TESTING, INSPECTION, AND INSTALLATION SHALL BE CONSTRUCTED IN ACCORDANCE WITH THE CITY OF WICHITA AND STATE OF KANSAS SPECIFICATIONS. 8" SANITARY SEWERS ARE REQUIRED TO BE VISUALLY INSPECTED OR WITH A TELEVISION CAMERA AND AIR TESTING BY THE CITY OF WICHITA.
 3. SEVENTY-TWO (72) HOURS BEFORE STARTING ANY EXCAVATION, THE CONTRACTOR SHALL CALL KANSAS ONE CALL AT 316-687-2470.
 4. THE CONTRACTOR SHALL FIELD VERIFY SANITARY SEWER ELEVATIONS PRIOR TO THE COMMENCEMENT OF CONSTRUCTION AND NOTIFY THE ENGINEER OF ANY DISCREPANCIES.
 5. ALL PVC SEWER LINES SHALL RATED AS SDR 26.

UTILITY NOTE:
 CONTRACTOR SHALL FIELD VERIFY LOCATION OF EXISTING NATURAL GAS, WATER, AND STORM SEWER LINES WHERE CROSSING PROPOSED SANITARY SEWER LINES OR ANY SANITARY SEWER CONSTRUCTION. CONTRACTOR SHALL PROVIDE ELEVATIONS OF EXISTING UTILITIES TO THE ENGINEER TO VERIFY ADEQUATE CLEARANCE.

1 LINE 1 - SANITARY SEWER PLAN
 SCALE: 1" = 40'

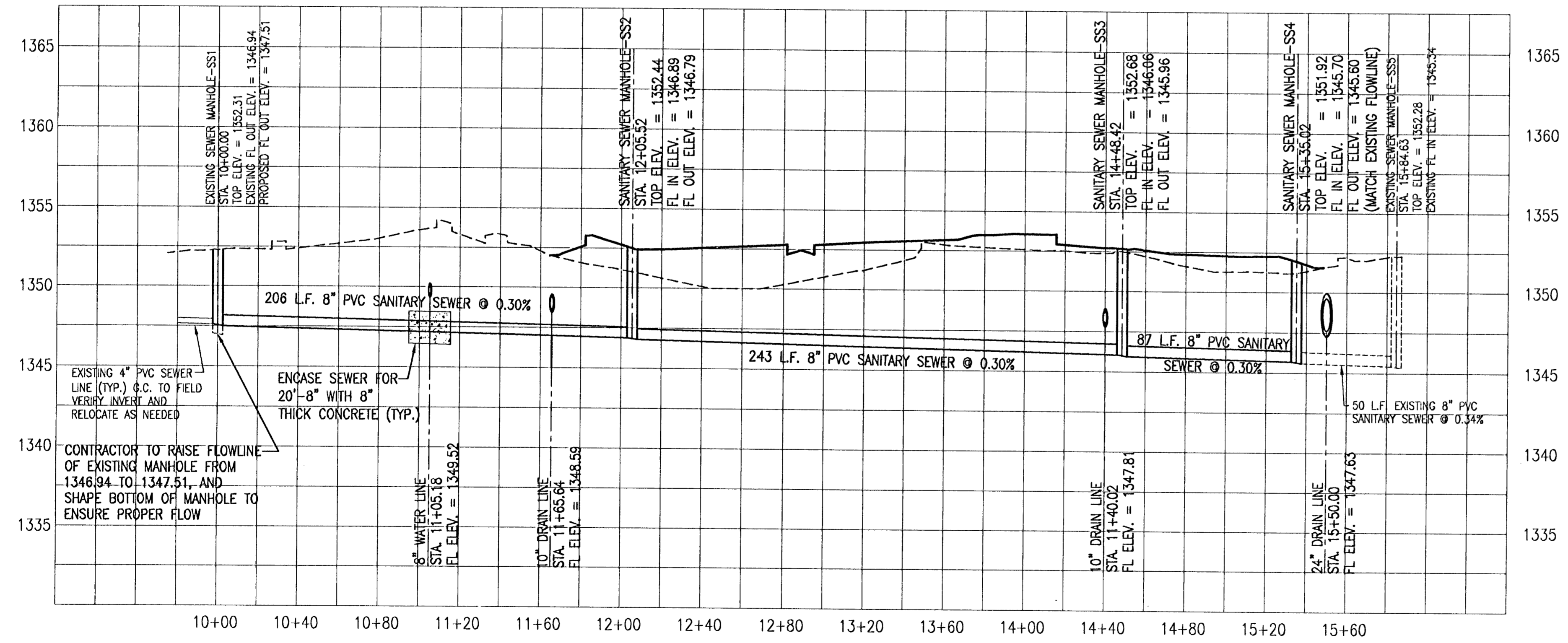

SYMBOL LEGEND

- ☆ LIGHT POLE
- ELECTRIC BOX
- ⊕ TELEPHONE PEDESTAL
- ⊙ SANITARY SEWER MANHOLE
- ⊕ WATER VALVE
- ⊕ FIRE HYDRANT
- ⊕ CURB INLET
- ⊕ DRAIN INLET
- ⊕ STORM SEWER MANHOLE
- ⊕ MONITOR WELL
- ⊕ RECOVERY WELL
- ⊕ GAS METER
- ⊕ ELECTRIC METER
- ⊕ VALVE BOX
- ⊕ CLEAN OUT
- ⊕ UTILITY ACCESS COVER
- VAULT

ABBREVIATIONS

- EP EDGE OF PAVEMENT
- ROW RIGHT OF WAY
- ⊕ CENTERLINE
- ⊕ RCP REINFORCED CONCRETE PIPE
- CONC. CONCRETE
- CMP CORRUGATED METAL PIPE
- R SUBJECT PROPERTY LINE
- TC TOP OF CURB
- BC BOTTOM OF CURB
- POB POINT OF BEGINNING
- HCR HANDICAP RAMP
- ⊕ HANDICAP PARKING/ACCESS

LINE LEGEND

- OHE—OHE—OHE— EXIST. OVERHEAD ELECTRIC LINES
- UGE—UGE—UGE— EXIST. UNDERGROUND ELECTRIC LINES
- G—G—G—G— EXIST. GAS LINE
- W—W—W—W— EXIST. WATER LINE
- SS—SS—SS—SS—SS— EXIST. SANITARY SEWER LINE
- OT—OT—OT—OT— EXIST. OVERHEAD TELEPHONE LINE
- UGT—UGT—UGT—UGT— EXIST. UNDERGROUND TELEPHONE LINE
- D—D—D—D— EXIST. DRAINAGE/STORM SEWER LINE
- X—X—X—X—X—X— FENCE
- — — — — SUBJECT AREA BOUNDARY
- OHE—OHE—OHE— OVERHEAD ELECTRIC LINES
- UGE—UGE—UGE— UNDERGROUND ELECTRIC LINES
- G—G—G—G— GAS LINE
- W—W—W—W— WATER LINE
- SS—SS—SS—SS—SS— SANITARY SEWER LINE
- OT—OT—OT—OT— OVERHEAD TELEPHONE LINE
- UGT—UGT—UGT—UGT— UNDERGROUND TELEPHONE LINE
- D—D—D—D— DRAINAGE/STORM SEWER LINE
- X—X—X—X—X—X— FENCE

NOTE:
 REPAIR ALL EXIST. ASPHALT PAVEMENT, CONCRETE CURB AND GUTTER, AND REPLACE SOD AND LANDSCAPING AS REQUIRED FOR UTILITY CONSTRUCTION

UTILITY NOTE:
 EXISTING CONDITIONS AND UTILITY INFORMATION WAS PROVIDED BY THE SAVOY COMPANY, P.A.

NOTE: ALL SYMBOLS, ABBREVIATIONS, OR LINESYLES DO NOT NECESSARILY APPEAR ON DRAWING(S). USE ONLY AS APPLICABLE.

2 LINE 1 - SANITARY SEWER PROFILE
 SCALE: 1" = 40' HORIZONTAL, 1" = 5' VERTICAL



UTILITY NOTE:
 CONTRACTOR SHALL SUPPLY AND INSTALL ALL ITEMS AND PERFORM ALL WORK NOT COVERED BY UTILITY COMPANIES. VERIFY INSTALLATION PROCEDURE WITH UTILITY COMPANY.

Pickering Firm
 Incorporated
 Planning-Architecture-Engineering-Management

9775 Leona Center Court
 Suite 200
 Merriam, KS 66203

913.728.0800
 913.728.0801
 913.728.0801 FAX

DILLON'S FOOD STORE #49 BUILDING EXPANSION
 PROJECT NAME
PLAN & PROFILE OF SANITARY SEWER LINE
 SHEET TITLE

ATP	ATP	CLM
DESIGN BY	DRAWN BY	CHECKED BY
08-18-06	21047-02	2 OF 5
DWG	JOB NUMBER	SHEET