

W:\CNAS\13\WOL\PROJECTS\2017\1010370_VERANDA_ADD\1370_CAD\SHS\05_CIVIL\GROUND\ADDITION\1370-05-1000_2ND.DWG
 W:\CNAS\13\WOL\PROJECTS\2017\1010370_VERANDA_ADD\1370_CAD\SHS\05_CIVIL\GROUND\ADDITION\1370-05-1000_2ND.DWG
 ROUTED: Pfile, February 03, 2023 @ 03:14PM

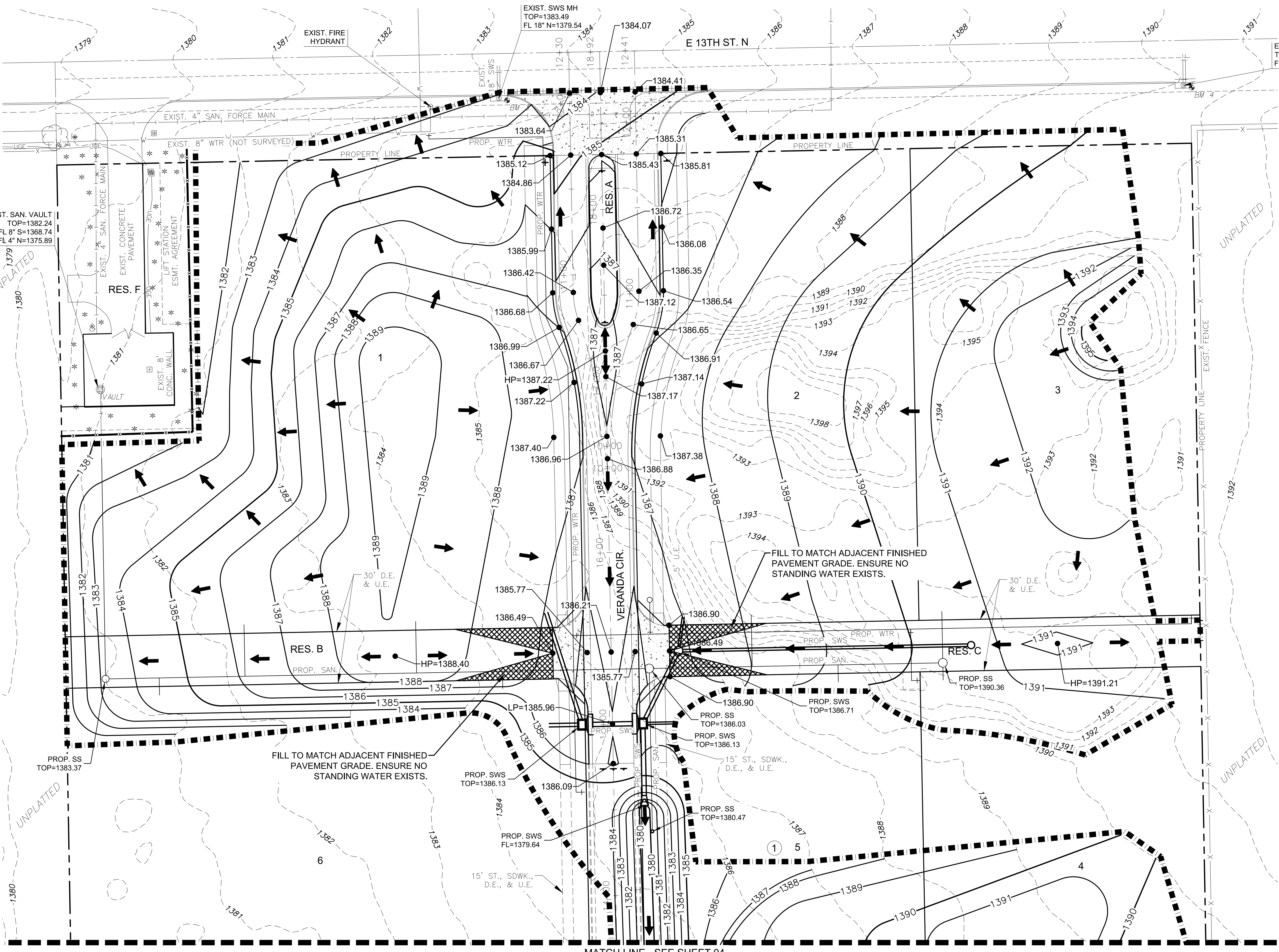

LEGEND

- 1250 EXISTING MAJOR CONTOUR
- 1250 EXISTING MINOR CONTOUR
- 1250 PROPOSED MAJOR CONTOUR
- 1250 PROPOSED MINOR CONTOUR
- EXISTING WATERLINE
- EXISTING SANITARY SEWER
- EXISTING STORMWATER SEWER
- EXISTING UNDERGROUND ELECTRICAL
- PROPOSED STORMWATER SEWER
- PROPOSED WATERLINE
- PROPOSED SANITARY SEWER
- LIMITS OF GRADING
- 1329.86 SPOT ELEVATIONS
- FLOW ARROW

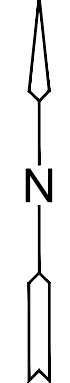

STORMWATER DRAINAGE PLANS FOR
VERANDA SECOND ADDITION
 PHASE 1

©2023
 MKEC Engineering
 All Rights Reserved
 www.mkec.com
 These drawings and their contents, including, but not limited to, all concepts, designs, & ideas are the exclusive property of MKEC Engineering (MKEC), and may not be used or reproduced in any way without the express consent of MKEC.

GRADING PLAN NORTH

PROJECT NO.	458-2022-085491
DATE	JAN. 2023
SCALE	1" = 30'
DESIGNED	MKB
DRAWN	MKB
CHECKED	SPE

NO.	REVISION	DATE