

EROSION CONTROL MEASURE	INSTALL	MAINTAIN	REMOVE
BACK OF CURB PROTECTION (LF)	0	0	0
CONSTRUCTION ENTRANCE (EA)	0	1	0
CURB INLET BARRIER (EA)	12	0	0
DITCH CHECK (EA)	15	0	0
DROP INLET PROTECTION (EA)	11	0	0
STRAW WATTLE DITCH CHECK (EA)	4	0	0
EROSION CONTROL BERM (LF)	1,570	0	0
SILT FENCE (LF)	0	2,236	0
EROSION CONTROL MAT (SY)	9,071	0	0

QUANTITIES ARE FOR INFORMATION ONLY! CONTRACTOR SHALL VERIFY QUANTITIES PER FINAL BID QUANTITY SHEET.

\* ALL EXISTING BMPs INCLUDING CONSTRUCTION ENTRANCE, SEDIMENT BARRIERS, SILT FENCE, EROSION CONTROL BERM, AND EROSION CONTROL MAT SHALL BE MAINTAINED AND REPAIRED IF NECESSARY. REPLACEMENT OR REMOVAL OF EROSION CONTROL MEASURES TO BE PAID FOR BY L.S. BID ITEM "MAINTAIN EXISTING BMPs"

**EARTH WORK TOTALS**

	C.Y. Excavation	C.Y. Compacted Fill
Mass Grading	6,535	61,608
Pond A Construction	39,934	-
Pond B Construction	23,947	-
Total	70,416	61,608

1. Excess material shall remain on-site and be stockpiled on undeveloped areas of site as indicated on sheet 22. Earthwork fill quantities are unadjusted and are for reference only. Excavation for mass grading and pond construction work to be paid for as C.Y. Excavation. All cost associated with fill & compaction shall be incidental to lump sum bid item "Grading, Mass".

2. Contractor to strip top 4-6" of soil within street right-of-way, Res. "A" and area of Pond B before mass grading and stockpile. Topsoil & dirt piles may be spread outside of proposed pavement prior to seeding. After topsoil is stripped, the contractor shall scarify, moisture condition, compact, and proof roll prior to placing fill. Any soft spots found during proof rolling shall be excavated and replaced with compacted fill that is properly moisture conditioned. Additional excavation to repair soft spots shall be paid per CY of "Excavation" and "Compacted Fill".

3. Compaction of 95% Standard Proctor Density shall be obtained in all areas. Fill from on-site excavation shall be placed in 8" maximum thickness lifts within 0% to +4% of optimum moisture content of the soil at the time of placement. All testing shall be incidental to Lump Sum bid item "Testing". Fill Clay and shale used in fills and for pond liner shall be pulverized to 1/2" or less during or prior to placing fills. See geotechnical report for more details. The geotechnical report is available upon request from the engineer.

4. It shall be the Contractor's responsibility to protect existing utilities during mass grading. Any damage done to these systems by Contractor or subcontractor shall be repaired at no additional cost to the project.

5. All areas disturbed during construction shall be seeded, mulched, and fertilized as per Cover Sheet General Notes. The approximate seeding area is 30 acres.

6. Street elevations shown on mass grading plan are top of rock (bottom of asphalt) at centerline. Grade points around cul-de-sac bulbs are located 1' behind the back of proposed curb.

7. Only trees within the street R/W or Res. "A" may be removed if necessary for grading. All other trees shall be protected from damage.

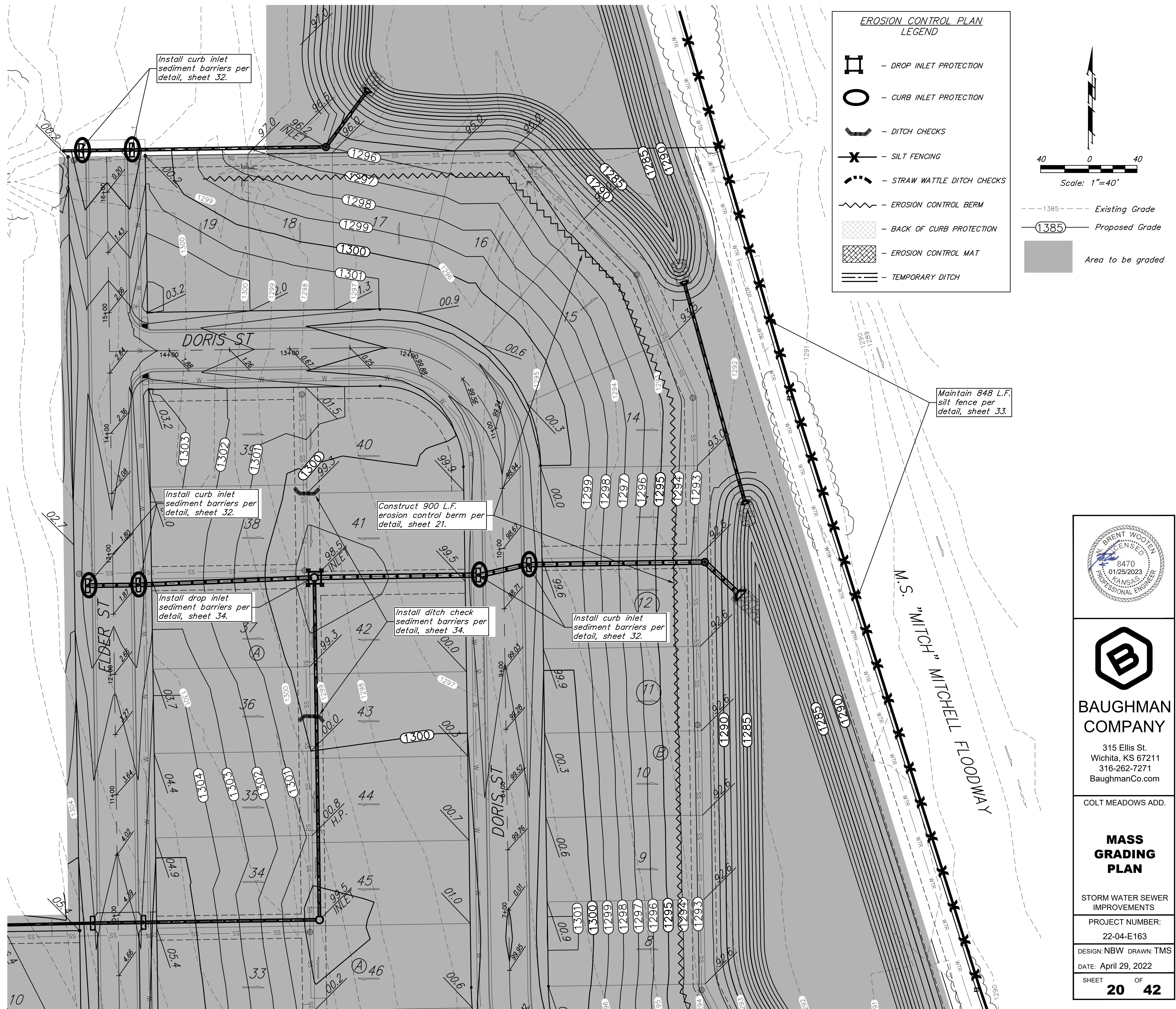

**EROSION CONTROL PLAN LEGEND**

- DROP INLET PROTECTION
- CURB INLET PROTECTION
- DITCH CHECKS
- SILT FENCING
- STRAW WATTLE DITCH CHECKS
- EROSION CONTROL BERM
- BACK OF CURB PROTECTION
- EROSION CONTROL MAT
- TEMPORARY DITCH

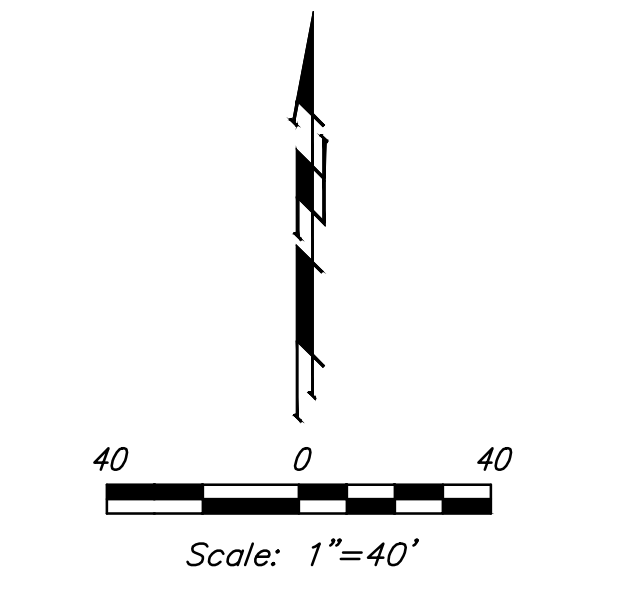

--- 1385 --- Existing Grade  
 (1385) Proposed Grade  
 Area to be graded



**BAUGHMAN COMPANY**  
 315 Ellis St.  
 Wichita, KS 67211  
 316-262-7271  
 BaughmanCo.com

COLT MEADOWS ADD.

**MASS GRADING PLAN**

STORM WATER SEWER IMPROVEMENTS

PROJECT NUMBER:  
22-04-E163

DESIGN: NBW DRAWN: TMS

DATE: April 29, 2022

SHEET **20** OF **42**

File: E:\Projects\Colt Meadows Addition\_21-01-P622\Engineering\Phase 1\SWD 22-04-E163\SWD.dwg