

Install 3,120 S.Y. Curlex II, or approved equal to be paid for as bid item "Erosion Control Mat". Erosion control mat shall be installed and anchored per manufacturer's specifications. Note: This quantity does not include excess material necessary for overlap and anchoring.

Construct pond per detail, this sheet.

EARTH WORK TOTALS		
	C.Y. Excavation	C.Y. Compacted Fill
Mass Grading	6,535	61,608
Pond A Construction	39,934	-
Pond B Construction	23,947	-
Total	70,416	61,608

Excess material shall remain on-site and be stockpiled on undeveloped areas of site as indicated on this sheet. Earthwork fill quantities are unadjusted and are for reference only. Excavation for mass grading and pond construction work to be paid for as C.Y. Excavation. All cost associated with fill & compaction shall be incidental to lump sum bid item "Grading, Mass".

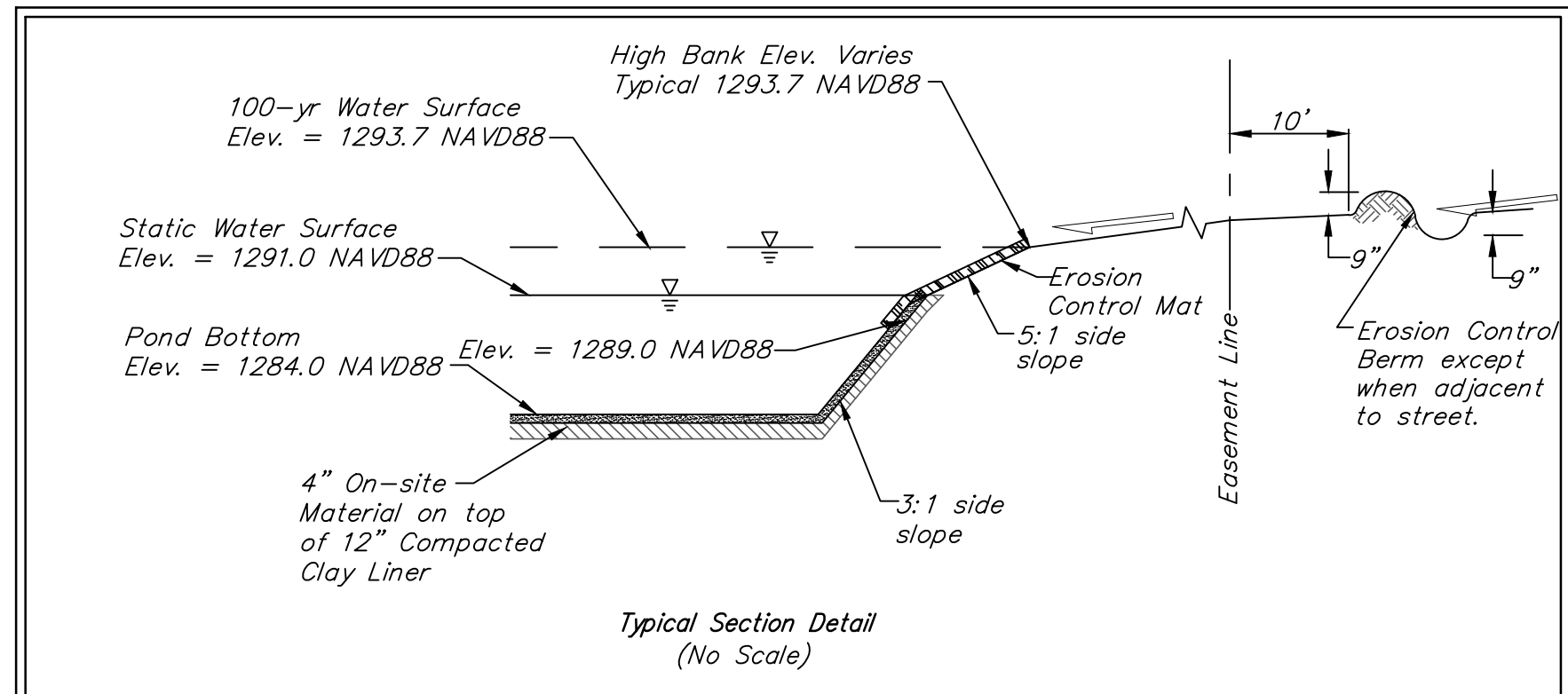

- NOTES:
- Pond bottom and sideslopes below static pool elevation shall be over-excavated 1'-4" and a 1' clay liner shall be compacted to 95% std. density. The best on-site material shall be used for the pond liner. 4" of on-site material shall be distributed on top of the clay liner below the static pool elevation. The compaction and P.I. shall be verified during construction. One Plasticity Index determination will be required for the material used for each pond liner. Cost shall be incidental to "Testing". Cost of over-excavation to install Clay Liner shall be incidental to bid item "Excavation".
 - Any excess excavation shall be stockpiled on undeveloped areas of site as indicated on this sheet.
 - All areas disturbed by construction shall be seeded as indicated on cover sheet.
 - Install Erosion Control Mat (Curlex II or approved equal) from 2' below the water surface to top bank. To be paid for as bid item "Erosion Control Mat".
 - Contractor to strip top 4-6" of soil within street right-of-way before mass grading and stockpile. Topsoil & dirt piles may be spread outside of proposed pavement prior to seeding.
 - Compaction of 95% shall be obtained in all areas. All testing shall be incidental to Lump Sum bid item "Testing".
 - Fill Clay and shale used in fills and for pond liner shall be pulverized to 1/2" or less during or prior to placing fills.

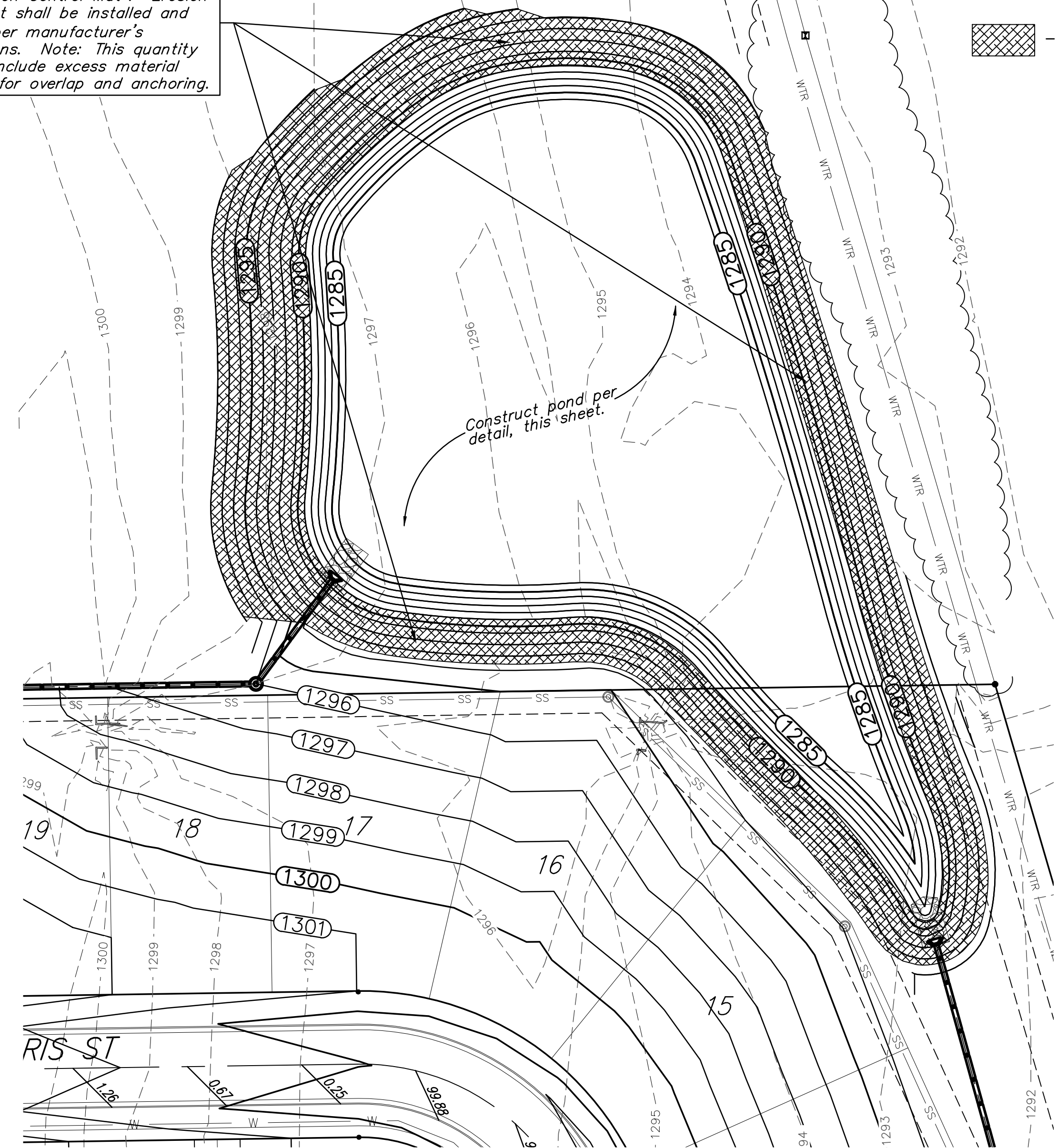

BAUGHMAN COMPANY
 315 Ellis St.
 Wichita, KS 67211
 316-262-7271
 BaughmanCo.com

COLT MEADOWS ADD.

POND PLAN "B"

STORM WATER SEWER IMPROVEMENTS
 PROJECT NUMBER:
 22-04-E163
 DESIGN: NBW DRAWN: TMS
 DATE: April 29, 2022
 SHEET **22** OF **42**

File: E:\Projects\Colt Meadows Addition_21-01-P622\Engineering\Phase 1\SWD 22-04-E163\SWD.dwg