

PLOTTED: Tuesday, August 16, 2022 @ 11:21 AM

J:\PROJECTS\2021\101010674_COW RIVERSIDE WATER MAIN REPLACEMENT\00 XXXXXX CAD\SHOTS05 CIVIL\WTRPH22\1674-05-3004-PH2.DWG

CONTRACTOR TO ENSURE 2' OF VERTICAL SEPARATION AT ALL SANITARY SEWER CROSSINGS. IF 2' SEPARATION IS NOT OBTAINABLE OR WATER IS BELOW SANITARY SEWER THEN SANITARY SEWER SHALL BE ENCASED.



RIVERSIDE WATER MAIN REPLACEMENT PHASE 2

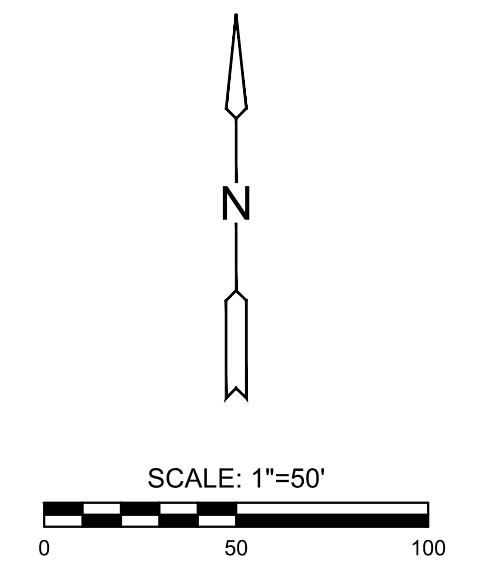
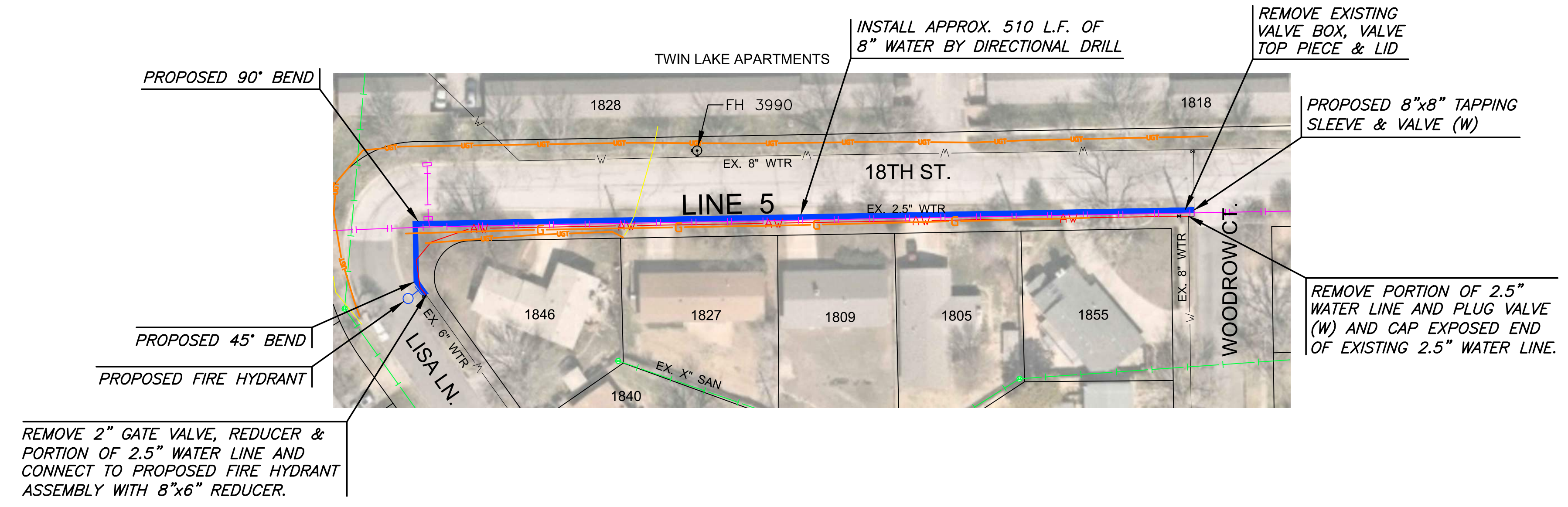

LEGEND

	EXISTING GAS
	EXISTING OVERHEAD ELECTRIC
	EXISTING UNDERGROUND ELECTRIC
	EXISTING SANITARY
	EXISTING STORM DRAIN PIPE
	EXISTING FIBER OPTIC
	EXISTING FENCE
	EXISTING WATER
	EXISTING WATER (TO BE ABANDONED)
	PROPOSED WATER

DESIGN-BUILD PLANS AND ANTICIPATED ALIGNMENTS ARE ISSUED FOR BIDDING PER THE CITY OF WICHITA'S APPROVAL



©2022 MKEC Engineering All Rights Reserved www.mkec.com
 These drawings and their contents, including, but not limited to, all concepts, designs, & ideas are the exclusive property of MKEC Engineering (MKEC), and may not be used or reproduced in any way without the express consent of MKEC.

LINE 5		
PROJECT NO.	448-2021-017906	
DATE	AUG 2022	
SCALE	1" = 50'	
DESIGNED	DRAWN	CHECKED
DFL	JWC	KDA
0	ISSUED FOR APPROVAL	08/16/22
NO.	REVISION	DATE
SHEET NO.		
15 OF 30		