

STORM WATER SEWER LINE C

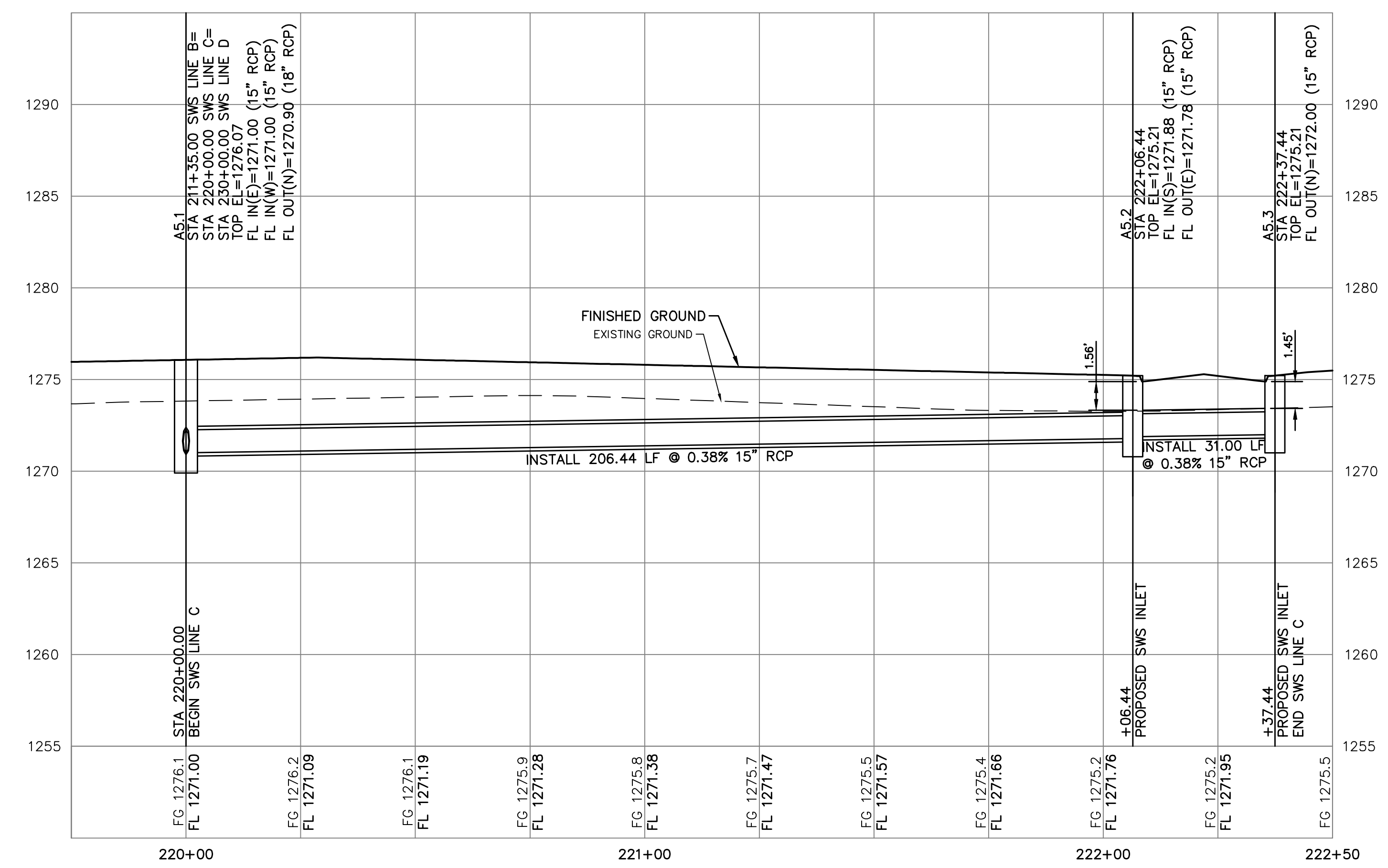

CS	CS	DSN	DWN	CHK
LDO	LDO	SRB	CC	
LDO	LDO	SRB	CC	
ADDENDUM UPDATE	ADDENDUM NO. 1	REV	DATE	DESCRIPTION
2	06/07/23	0	03/21/23	INITIAL RELEASE
1	05/16/23	1	05/16/23	ADDENDUM NO. 1
0		0		

LEON D. OSBOURN  
ENGINEER  
KS # 9772

**KAW VALLEY ENGINEERING**  
KAW VALLEY ENGINEERING, INC. IS AUTHORIZED TO OFFER ENGINEERING SERVICES BY KANSAS STATE CERTIFICATE OF AUTHORIZATION # E-113. EXPIRES 12/31/24

**SYCAMORE POND ADDITION**  
W 50TH STREET S & SYCAMORE AVE  
WICHITA, KANSAS

**PHASE 3-STORM SEWER IMPROVEMENTS**  
LINE C - PLAN AND PROFILE

PROJ. NO.	G22-2295
DESIGNER	SRB
DRAWN BY	CC
CFN	2295DPPP
SHEET	6
REV	2