

STORM WATER SEWER LINE D

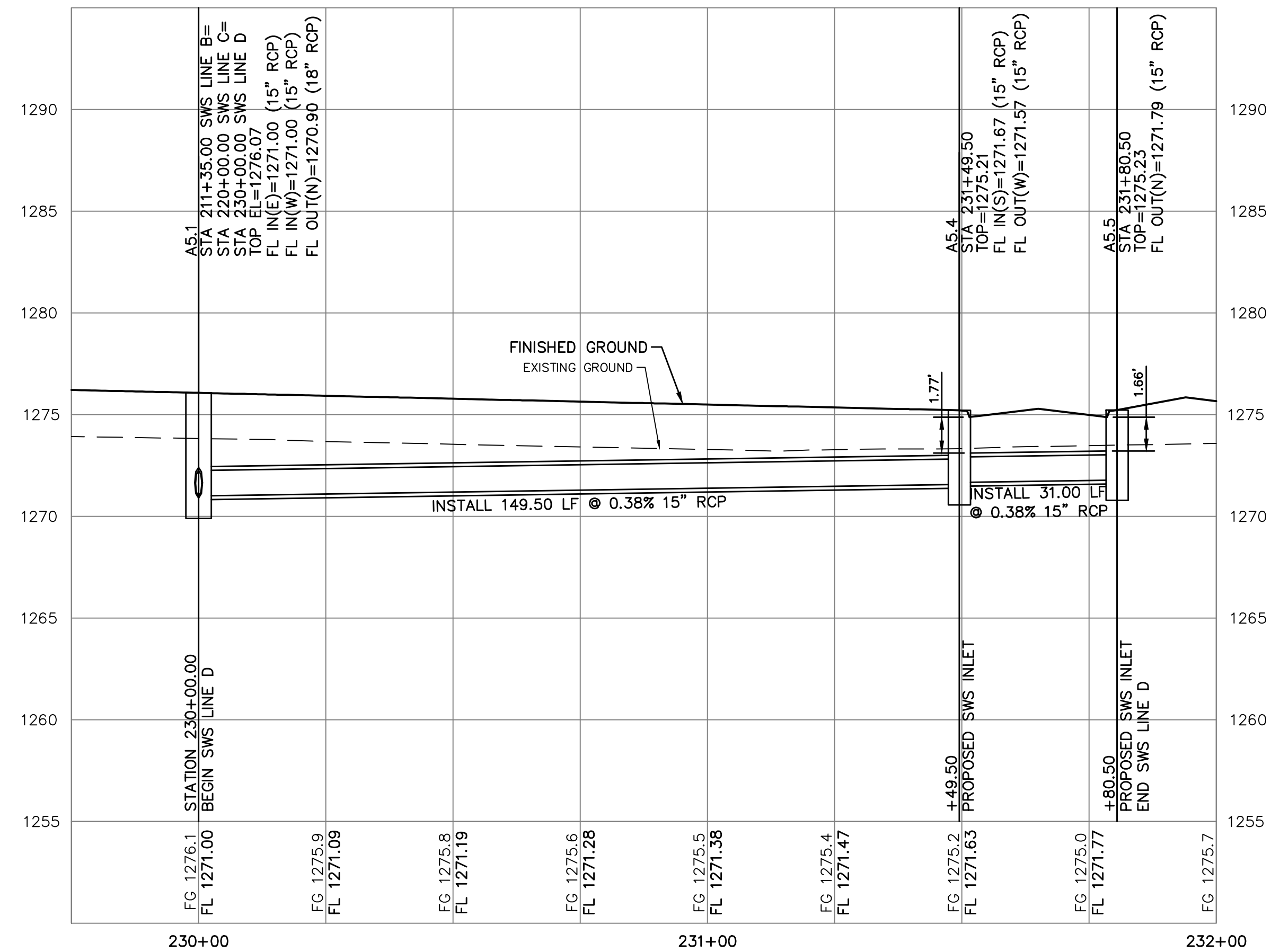

CS	CS	DSN	CHK
LDO	LDO	LDO	CC
LDO	LDO	SRB	CC
ADDENDUM NO. 1	ADDENDUM NO. 1	ADDENDUM NO. 1	ADDENDUM NO. 1
03/21/23	03/21/23	03/21/23	03/21/23
INITIAL RELEASE	INITIAL RELEASE	INITIAL RELEASE	INITIAL RELEASE
REV	DATE	DESCRIPTION	
2	06/07/23	ADDENDUM UPDATE	
1	05/16/23	ADDENDUM NO. 1	
0	03/21/23	INITIAL RELEASE	

LEON D. OSBOURN
ENGINEER
KS # 9772

KAW VALLEY ENGINEERING

200 N. EMPORIA, SUITE 100
WICHITA, KANSAS 67202
PH. (316) 440-4304
www.kveeng.com | www.kveing.com

KAW VALLEY ENGINEERING, INC., IS AUTHORIZED TO OFFER ENGINEERING SERVICES BY KANSAS STATE CERTIFICATE OF AUTHORIZATION # E-113. EXPIRES 12/31/24

SYCAMORE POND ADDITION	
W 50TH STREET S & SYCAMORE AVE	
WICHITA, KANSAS	
PHASE 3-STORM SEWER IMPROVEMENTS	
LINE D - PLAN AND PROFILE	
PROJ. NO.	G22 2295
DESIGNER	SRB
DRAWN BY	CC
CFN	2295DPP
SHEET	7
REV	2

THIS DRAWING SHALL NOT BE UTILIZED BY ANY PERSON, FIRM, OR CORPORATION IN WHOLE OR IN PART WITHOUT THE SPECIFIC PERMISSION OF KAW VALLEY ENGINEERING, INC.