

NUMBER	TYPE	LOCATION				FOR INFORMATION ONLY		
		LOT	BLOCK NO.	LINE NO.	STATION	DIRECTION	VERTICAL (FT)	HORIZONTAL (FT)
1	4" TEE	15	1	A	100+88.46	23.09' RT	4.4' LF	23.1' LF
2	4" TEE	16	1	A	101+62.42	23.12' RT	4.1' LF	23.1' LF
3	4" TEE	17	1	A	102+32.42	23.15' RT	3.0' LF	23.2' LF
4	4" TEE	18	1	A	103+02.42	23.18' RT	3.3' LF	23.2' LF
5	4" TEE	19	1	A	103+72.42	23.21' RT	3.7' LF	23.2' LF
6	4" TEE	20	1	A	104+42.42	23.24' RT	3.2' LF	23.2' LF
7	4" TEE	21	1	A	105+15.39	23.27' RT	3.4' LF	23.3' LF
8	4" MH CONNECTION	22	1	A	105+48.39	27.62' RT	1.5' LF	27.6' LF

SANITARY LINE A

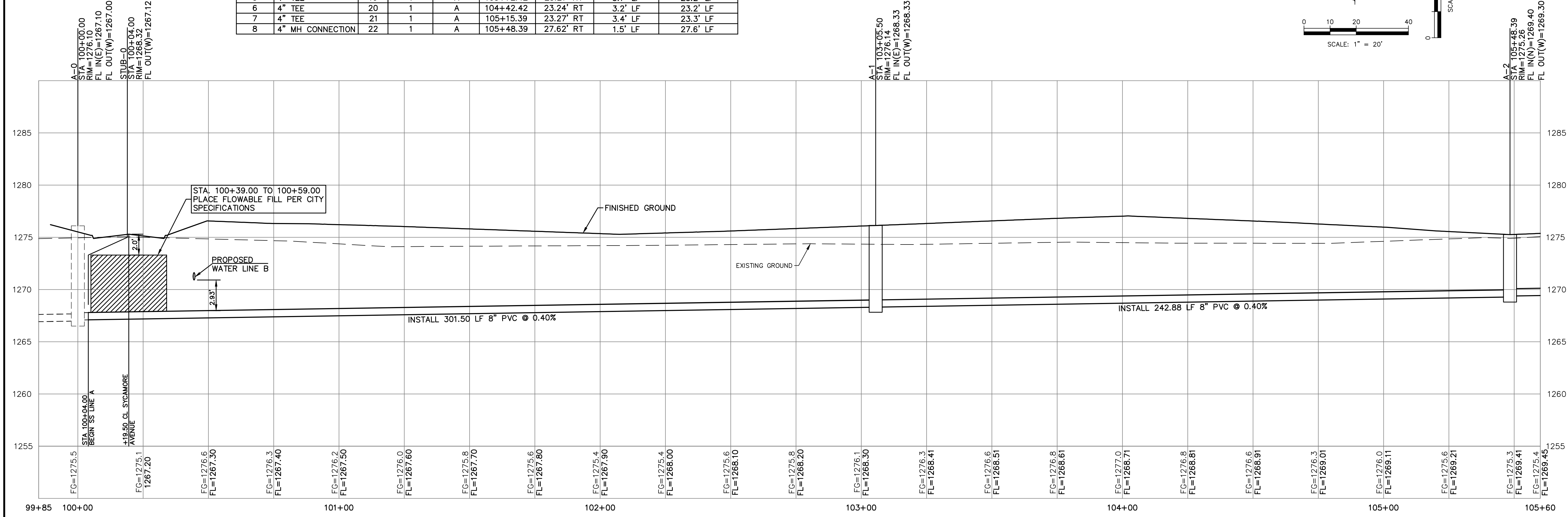
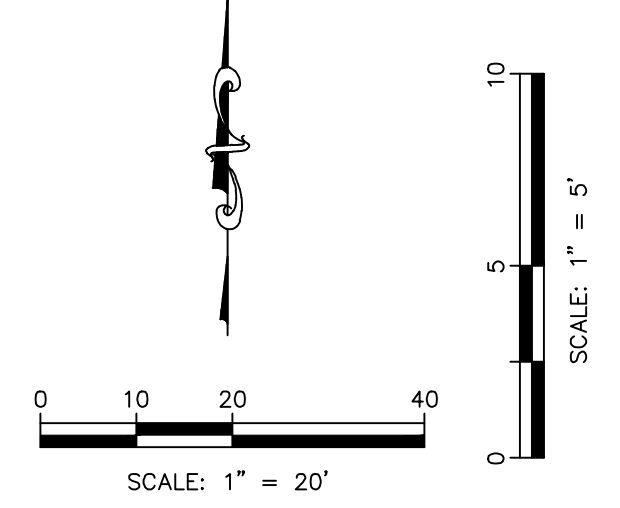

CS	DSN	CHK
LDO	LDO	JML
LDO	SRB	CC
2	06/07/23	ADDENDUM UPDATE
1	05/16/23	ADDENDUM NO. 1
0	03/21/23	INITIAL RELEASE
REV	DATE	DESCRIPTION

LEON D. OSBOURN
ENGINEER
KS # 9772

KAW VALLEY ENGINEERING
KAW VALLEY ENGINEERING, INC. IS AUTHORIZED TO OFFER ENGINEERING SERVICES BY KANSAS STATE CERTIFICATE OF AUTHORIZATION # E-113. EXPIRES 12/31/24

SYCAMORE POND ADDITION	
W 50TH STREET S & SYCAMORE AVE	
WICHITA, KANSAS	
PHASE 3 - SANITARY SEWER IMPROVEMENTS	
SS LINE A PLAN & PROFILE	
PROJ. NO.	G22 2295
DESIGNER	SRB
CFN	CC
2295SPP	
SHEET	REV
3	2

THIS DRAWING SHALL NOT BE UTILIZED BY ANY PERSON, FIRM, OR CORPORATION IN WHOLE OR IN PART WITHOUT THE SPECIFIC PERMISSION OF KAW VALLEY ENGINEERING, INC.