

SANITARY LINE A

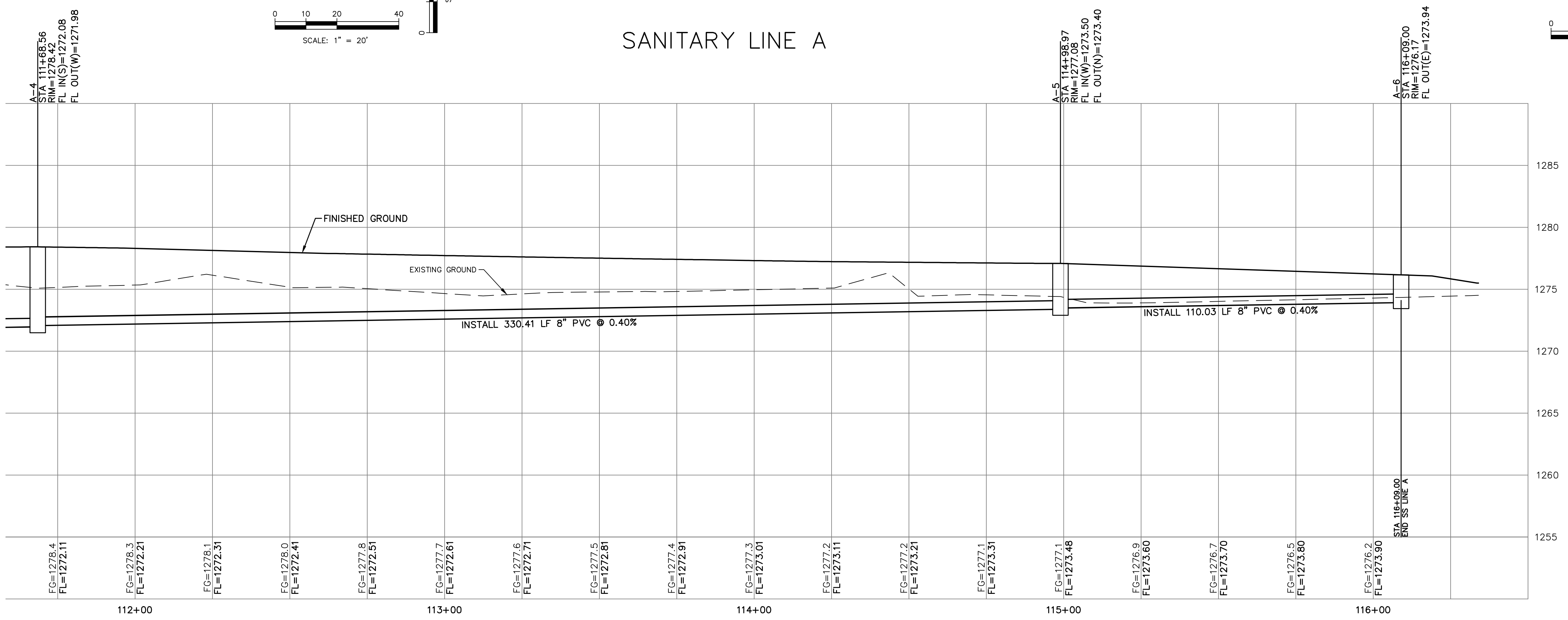

PROJ. NO. G22 2295		DESIGNER SRB	DRAWN BY CC
CFN 2295SPP		SHEET 6	
SHEET 6		REV 2	
2	06/07/23	ADDENDUM UPDATE	CS
1	05/16/23	ADDENDUM NO. 1	LDO
0	03/21/23	INITIAL RELEASE	LDO
			SRB
			JML
			CC
			DSN
			DWN
			CHK



LEON D. OSBOURN
ENGINEER
KS # 9772

200 N. EMPORIA, SUITE 100
WICHITA, KANSAS 67202
PH. (316) 440-4304
wh@kveeng.com | www.kveeng.com

KAW VALLEY ENGINEERING

KAW VALLEY ENGINEERING, INC. IS AUTHORIZED TO OFFER ENGINEERING SERVICES BY KANSAS STATE CERTIFICATE OF AUTHORIZATION # E-113. EXPIRES 12/31/24

SYCAMORE POND ADDITION
W 50TH STREET S & SYCAMORE AVE
WICHITA, KANSAS

PHASE 3 - SANITARY SEWER IMPROVEMENTS
SS LINE A PLAN & PROFILE

THIS DRAWING SHALL NOT BE UTILIZED BY ANY PERSON, FIRM, OR CORPORATION IN WHOLE OR IN PART WITHOUT THE SPECIFIC PERMISSION OF KAW VALLEY ENGINEERING, INC.