

STA 150+00.00 (LINE B)=
STA 108+65.43 (LINE A)
BEGIN SS LINE B,
CONNECT TO SS MANHOLE A-3
RIM EL.=1278.36
FL IN(E)=1270.77
FL IN(W)=1270.77
FL OUT(S)=1270.67
N 1655832.94, E 1647098.82

STA 152+47.78
CONSTRUCT SHALLOW 4' SS MANHOLE B-1
RIM EL.=1277.57
FL IN(W)=1271.86
FL OUT(E)=1271.76
SEE DETAIL SHEETS 9-10
N 1655827.80, E 1646851.10

STA 154+88.78
CONSTRUCT SHALLOW 4' SS MANHOLE B-2
RIM EL.=1276.57
FL OUT(E)=1272.82
SEE DETAIL SHEETS 9-10
N 1655822.81, E 1646610.15

SANITARY LINE B

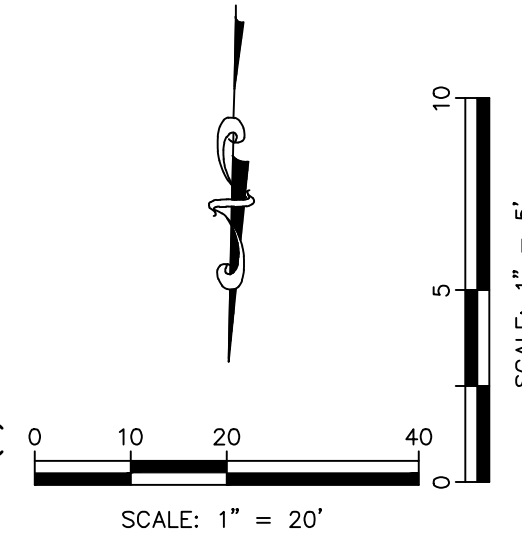
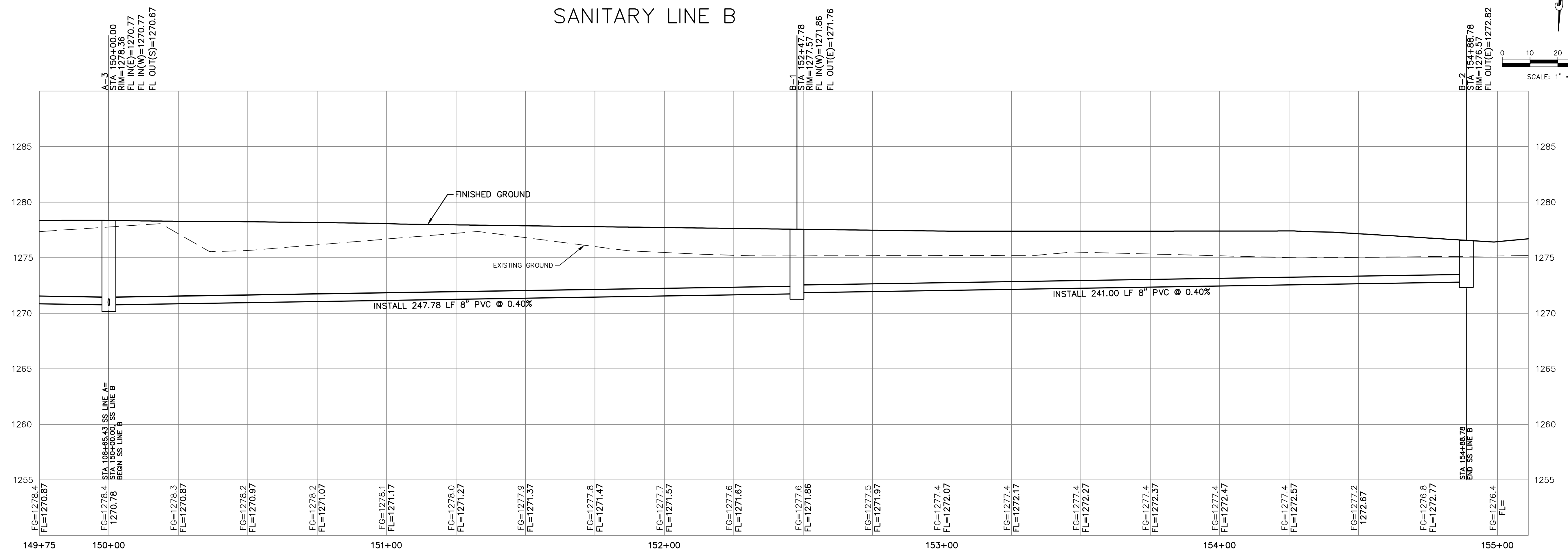

REV	DATE	DESCRIPTION
2	06/07/23	ADDENDUM UPDATE
1	05/16/23	ADDENDUM NO. 1
0	03/21/23	INITIAL RELEASE

LEON D. OSBOURN
ENGINEER
KS # 9772

KAW VALLEY ENGINEERING
KAW VALLEY ENGINEERING, INC. IS AUTHORIZED TO OFFER ENGINEERING SERVICES BY KANSAS STATE CERTIFICATE OF AUTHORIZATION # E-113. EXPIRES 12/31/24

SYCAMORE POND ADDITION
W 50TH STREET S & SYCAMORE AVE
WICHITA, KANSAS

PHASE 3 - SANITARY SEWER IMPROVEMENTS
SS LINE B PLAN & PROFILE

PROJ. NO. G22-2295
DESIGNER SRB DRAWN BY CC
CFN 2295SPP
SHEET 7 REV 2

THIS DRAWING SHALL NOT BE UTILIZED BY ANY PERSON, FIRM, OR CORPORATION IN WHOLE OR IN PART WITHOUT THE SPECIFIC PERMISSION OF KAW VALLEY ENGINEERING, INC.