

BENCHMARKS:
 BM #1: Square cut/cross on curb inlet near the SE corner of Lot 1, Block D, Castlegate 3rd Addition.
 Elev. = 1342.69 (NAVD88)

BM #2: Square cut/cross on curb inlet near the SW corner of Lot 11, Block B, Castlegate 3rd Addition.
 Elev. = 1343.08 (NAVD88)

Subdivision Bench Marks

| Street & Station | Location Description | Elevation |
|---------------------------------|--|-----------|
| Thornton 3+25.90, 15.25' Rt. | Adjacent to Fire Hydrant at S End of S Curb Return of Thornton and Thornton Ct. (Lots 14-17, Block B). | |

WATER VALVE LOCATION TABLE

| VALVE NUMBER | STREET | BASELINE STATION | OFFSET DISTANCE | OFFSET DIRECTION |
|--------------|----------|------------------|-----------------|------------------|
| V1 | Thornton | 1+75.00 | 21' | Rt. |
| V2 | Thornton | 3+25.90 | 24.60' | Rt. |

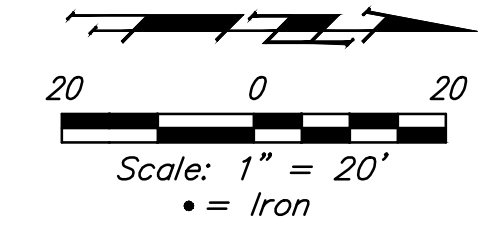

Paving contractor will be responsible to operate all water valves on the project, in the presence of the inspector, to ensure accessibility to the valves, and that all valves (except blowoffs) are left in the "ON" position when the project is completed.

Baseline = CL Thornton

| Curve #1 Curve Data Based on Centerline | | | | | | |
|--|---------|--------|---------|----------|-----------|-------------|
| Rad. = 66' Delta = 91°50'17" Tangent = 68.15' | | | | | | |
| Arc = 105.79' L.C. = 94.82' Def./Ft. = 26.04350 Min. | | | | | | |
| Face Chord Lengths | Station | Arc | 8' Left | 8' Right | Defl. | Total Defl. |
| | 3+07.14 | - | - | - | 0°00'00" | 0°00'00" |
| | 3+25.00 | 17.86' | 11.60' | 24.01' | 7°45'08" | 7°45'08" |
| | 3+28.19 | 3.19' | 2.08' | 4.30' | 1°23'05" | 9°08'13" |
| | 3+50.00 | 21.81' | 14.14' | 29.28' | 9°28'00" | 18°36'13" |
| | 3+52.24 | 2.24' | 1.46' | 3.02' | 0°58'21" | 19°34'34" |
| | 3+75.36 | 23.12' | 14.99' | 31.02' | 10°02'07" | 29°36'41" |
| | 4+00.00 | 24.64' | 15.96' | 33.03' | 10°41'43" | 40°18'24" |
| | 4+12.93 | 12.93' | 8.41' | 17.41' | 5°36'45" | 45°55'09" |

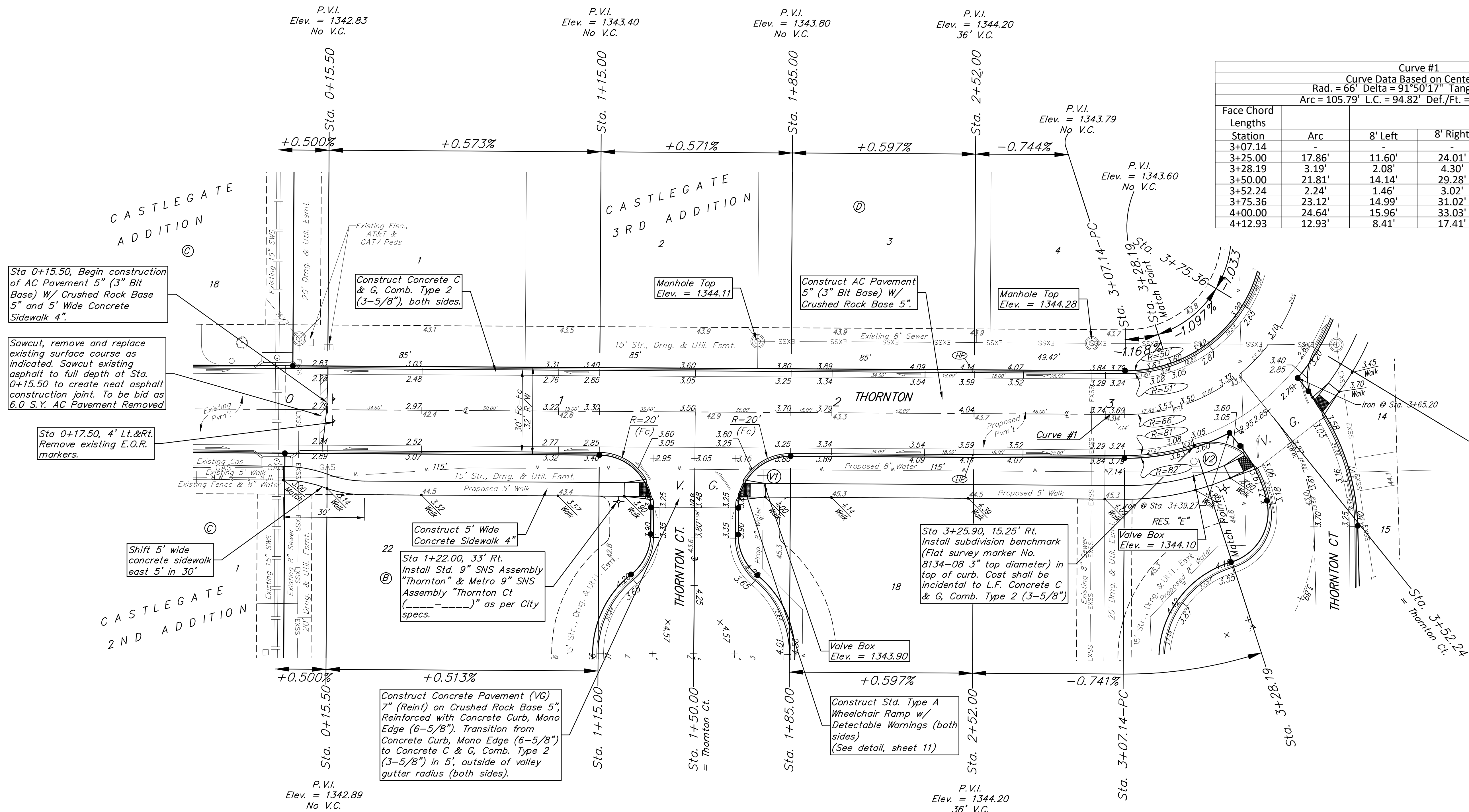

Sta 0+15.50, Begin construction of AC Pavement 5" (3" Bit Base) W/ Crushed Rock Base 5" and 5' Wide Concrete Sidewalk 4".

Sawcut, remove and replace existing surface course as indicated. Sawcut existing asphalt to full depth at Sta. 0+15.50 to create neat asphalt construction joint. To be bid as 6.0 S.Y. AC Pavement Removed

Sta 0+17.50, 4' Lt.&Rt. Remove existing E.O.R. markers.

Shift 5' wide concrete sidewalk east 5' in 30'

Construct 5' Wide Concrete Sidewalk 4"

Sta 1+22.00, 33' Rt. Install Std. 9" SNS Assembly "Thornton Ct" (---) as per City specs.

Construct Concrete Pavement (VG) 7" (Rein) on Crushed Rock Base 5", Reinforced with Concrete Curb, Mono Edge (6-5/8"). Transition from Concrete Curb, Mono Edge (6-5/8") to Concrete C & G, Comb. Type 2 (3-5/8") in 5' outside of valley gutter radius (both sides).

Sta 3+25.90, 15.25' Rt. Install subdivision benchmark (Flat survey marker No. 8134-08 3" top diameter) in top of curb. Cost shall be incidental to L.F. Concrete C & G, Comb. Type 2 (3-5/8")

Construct Std. Type A Wheelchair Ramp w/ Detectable Warnings (both sides) (See detail, sheet 11)

NOTE: ROLL TYPE CURB & GUTTER (TYPE 2) TO BE CONSTRUCTED ON THE PAVEMENT SHOWN ON THIS SHEET. TOP OF CURB ELEVATIONS ARE GIVEN FOR FULL HEIGHT CURB (TYPE 4).

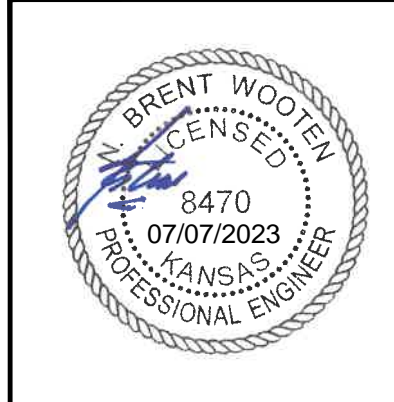

BAUGHMAN COMPANY
 315 Ellis St.
 Wichita, KS 67211
 316-262-7271
 BaughmanCo.com

CASTLEGATE 3RD ADD.
 Phase 2

THORNTON

STREET IMPROVEMENTS

PROJECT NUMBER:
 22-08-E278

DESIGN: NBW DRAWN: TMS

DATE: May 16, 2023

SHEET OF
2 23

File: E:\Projects\Castlegate 3rd Addition_18-12-P-23\Engineering\Phase 2\Streets 22-08-E278\Streets.dwg