

PLOTTED: Tuesday, July 25, 2023 @ 08:14 AM

J:\PROJECTS\2022\201010296_PERFECTION_JACOBS\135TH AND CENTRAL\00_220296_CAD\SHOTS\05_CIVIL\GRD\22296-05-1206.DWG

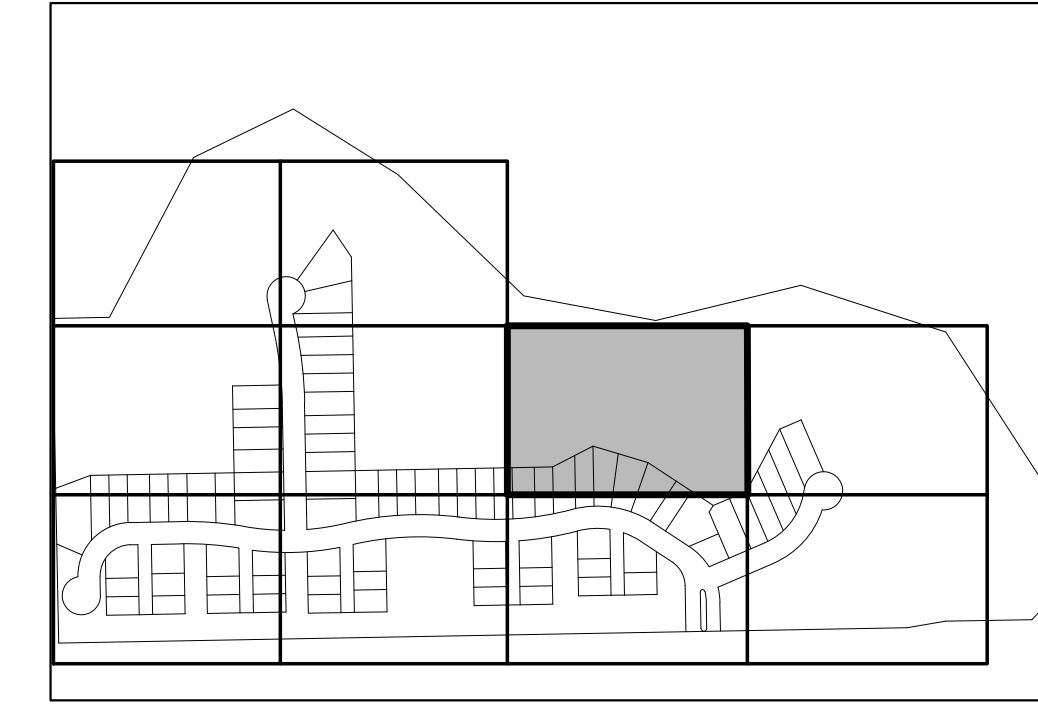
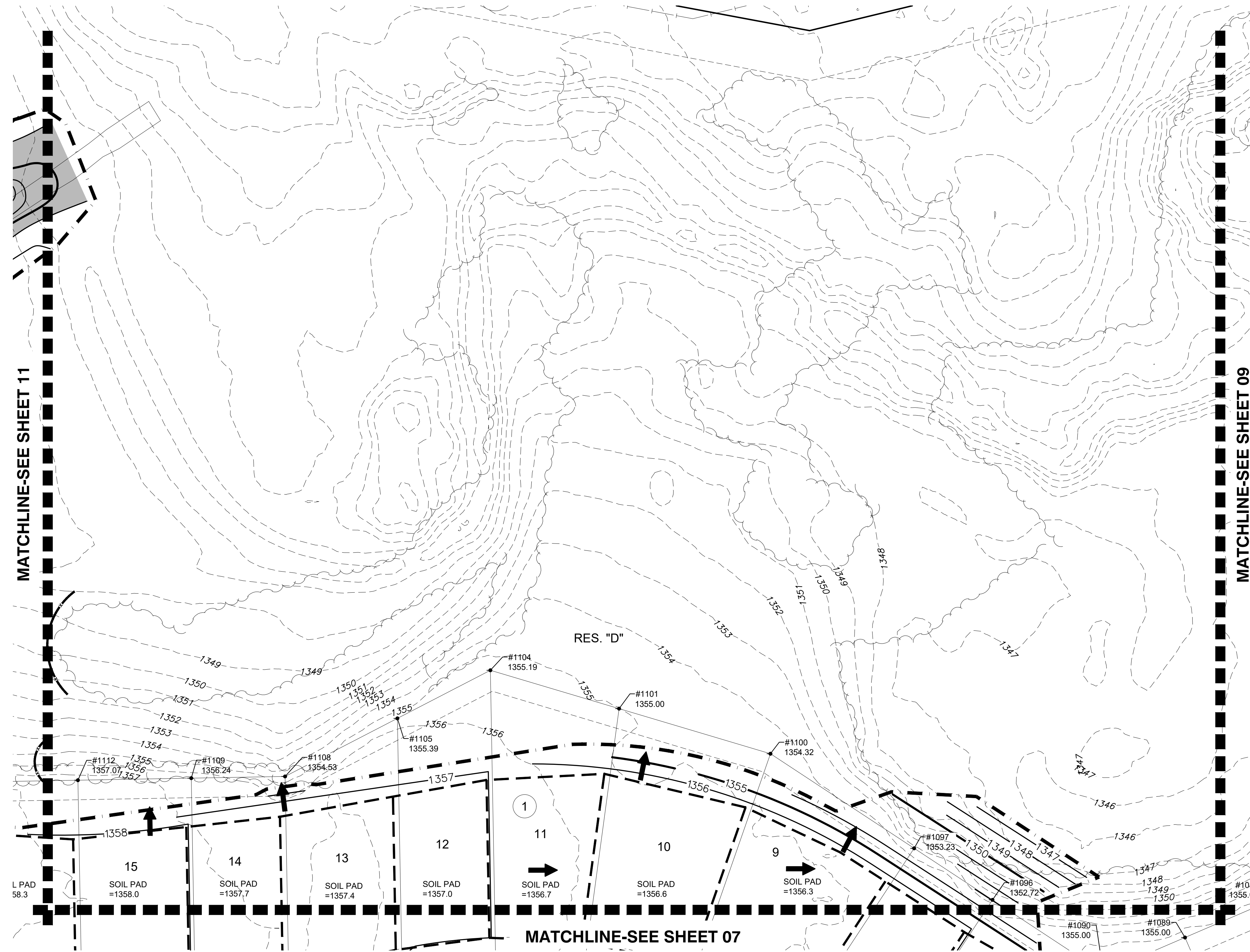

KEY MAP

NOTES:
VERTICAL DATUM USED IS NAVD88.

ALL STREET GRADES SHOWN ARE TO TOP OF PAVEMENT. CONTRACTOR SHALL OVER EXCAVATE ROADS TO TOP OF SUBGRADE. REFER TO ROAD CROSS SECTION DETAIL IN PAVING PLANS.

LEGEND

- 1250 --- EXISTING MAJOR CONTOUR
- 1250 --- EXISTING MINOR CONTOUR
- 1250 — PROPOSED MAJOR CONTOUR
- 1250 — PROPOSED MINOR CONTOUR
- W — EXISTING WATERLINE
- S — EXISTING SANITARY SEWER
- SW — EXISTING STORMWATER SEWER
- UGT — EXISTING UNDERGROUND TELEPHONE
- UGE — EXISTING UNDERGROUND ELECTRICAL
- OHE — EXISTING OVERHEAD ELECTRICAL
- G — EXISTING GASLINE
- FOC — EXISTING FIBER OPTIC LINE
- SW — PROPOSED STORMWATER SEWER
- — — LIMITS OF GRADING
- 1329.86 SPOT ELEVATIONS
- ➔ FLOW ARROW
- — — SWALE FLOWLINE
- — — TREE PROTECTION FENCE

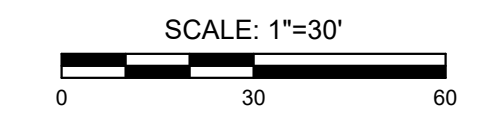
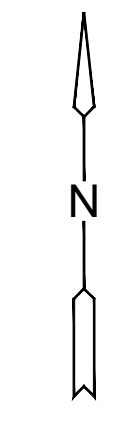

STORMWATER DRAIN #507 IMPROVEMENTS TO SERVE
COURTYARDS AT JACOBS FARM
WICHITA, KS

©2023 MKEC Engineering All Rights Reserved www.mkec.com
These drawings and their contents, including, but not limited to, all concepts, designs, & ideas are the exclusive property of MKEC Engineering (MKEC), and may not be used or reproduced in any way without the express consent of MKEC.

GRADING PLAN

PROJECT NO.	472-2023-085532
DATE	JULY 2023
SCALE	1" = 30'
DESIGNED	DML
DRAWN	DML
CHECKED	SPE

NO.	REVISION	DATE

SHEET NO.
10 OF 26