

J:\PROJECTS\2022\2201010296_PERFECTION_JACOBS\135TH AND CENTRAL\00_220296_CAD\SHOTS\05_CIVIL\GRD\220296-05-1208.DWG
 PLOTTED: Tuesday, July 25, 2023 @ 08:15AM

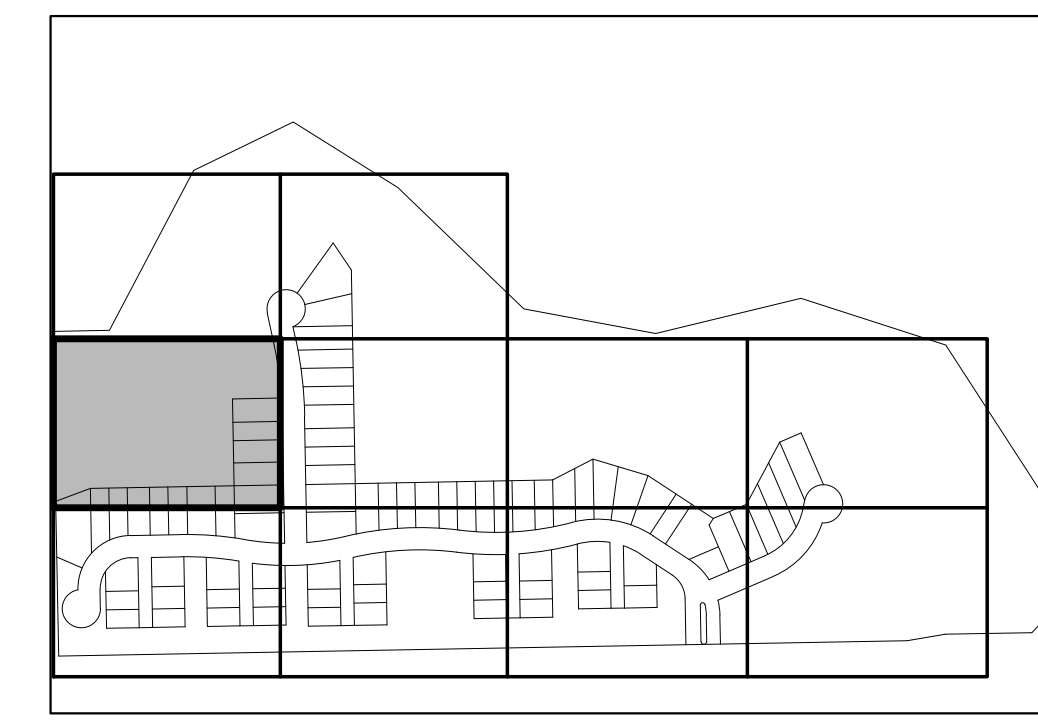
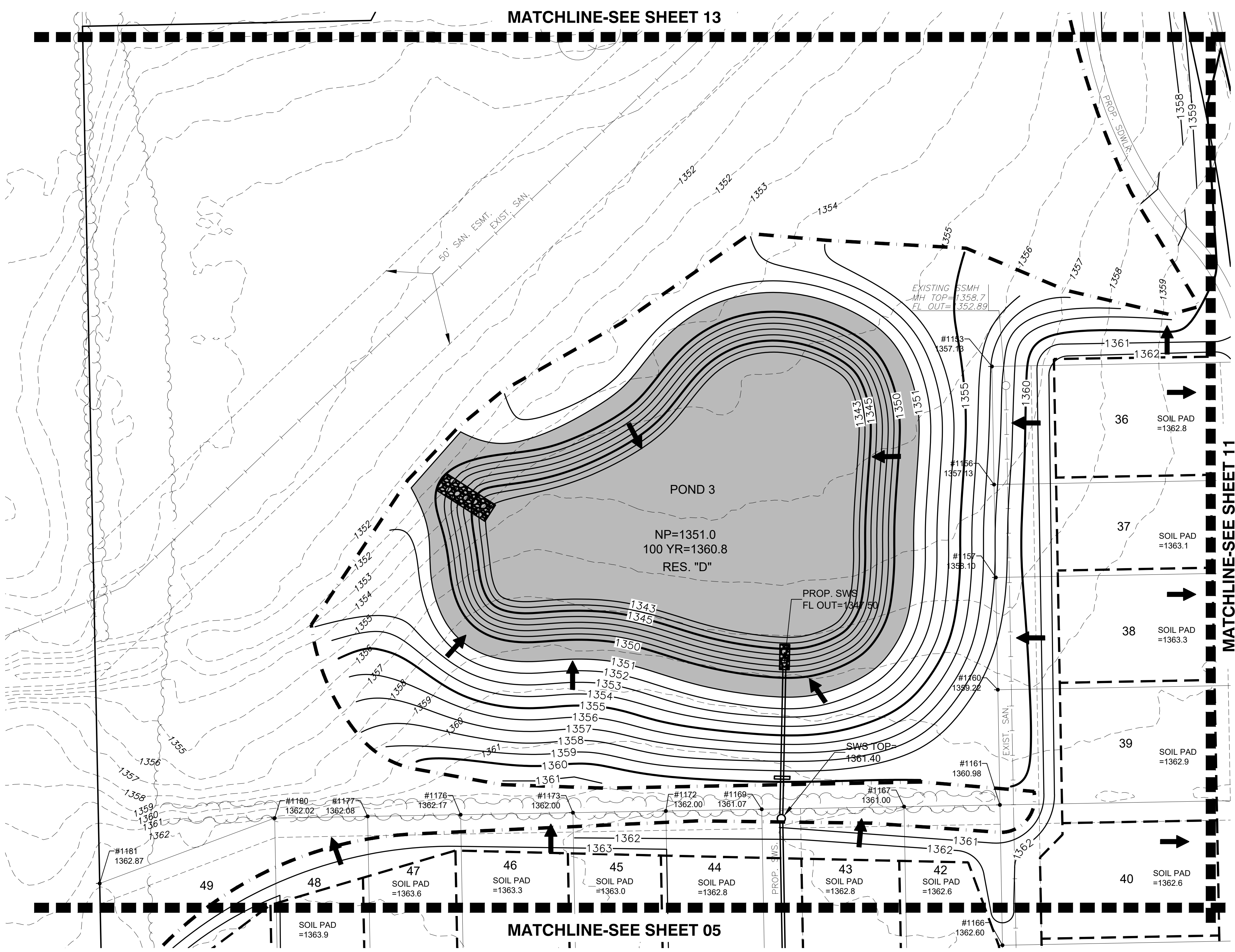

KEY MAP

NOTES:
 VERTICAL DATUM USED IS NAVD88.
 ALL STREET GRADES SHOWN ARE TO TOP OF PAVEMENT. CONTRACTOR SHALL OVER EXCAVATE ROADS TO TOP OF SUBGRADE. REFER TO ROAD CROSS SECTION DETAIL IN PAVING PLANS.

- LEGEND**
- 1250 --- EXISTING MAJOR CONTOUR
 - 1250 --- EXISTING MINOR CONTOUR
 - 1250 — PROPOSED MAJOR CONTOUR
 - 1250 — PROPOSED MINOR CONTOUR
 - W — EXISTING WATERLINE
 - S — EXISTING SANITARY SEWER
 - S — EXISTING STORMWATER SEWER
 - UGT — EXISTING UNDERGROUND TELEPHONE
 - UGE — EXISTING UNDERGROUND ELECTRICAL
 - OHE — EXISTING OVERHEAD ELECTRICAL
 - G — EXISTING GASLINE
 - FOC — EXISTING FIBER OPTIC LINE
 - S — PROPOSED STORMWATER SEWER
 - --- LIMITS OF GRADING
 - 1329.86 SPOT ELEVATIONS
 - ➔ FLOW ARROW
 - — SWALE FLOWLINE
 - — TREE PROTECTION FENCE

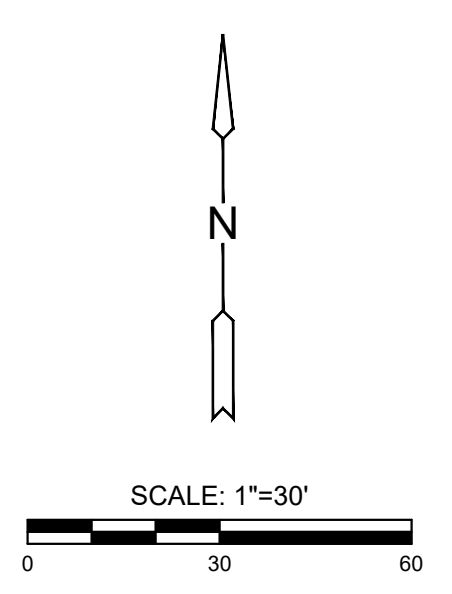

STORMWATER DRAIN #507 IMPROVEMENTS TO SERVE
COURTYARDS AT JACOBS FARM
 WICHITA, KS

©2023
 MKEC Engineering
 All Rights Reserved
 www.mkec.com
 These drawings and their contents, including, but not limited to, all concepts, designs, & ideas are the exclusive property of MKEC Engineering (MKEC), and may not be used or reproduced in any way without the express consent of MKEC.

GRADING PLAN

PROJECT NO.	472-2023-085532	
DATE	JULY 2023	
SCALE	1" = 30'	
DESIGNED	DML	
DRAWN	DML	
CHECKED	SPE	
NO.	REVISION	DATE