

J:\PROJECTS\2022\2201010296\_PERFECTION\_JACOBS\135TH AND CENTRAL\00\_220296\_CAD\SHOTS\05\_CIVIL\PAV\220296-05-5206.DWG  
 PLOTTED: Tuesday, July 25, 2023 10:28AM

SUBDIVISION BENCH MARKS				
NO.	STREET AND STATION	FROM CL	DESCRIPTION	ELEVATIONS
1	BARN OWL ST., STA. 12+57.14	14.5' RT	TOP OF CURB AT FIRE HYDRANT	

NOTE: CONTRACTOR SHALL INSTALL SUBDIVISION BENCH MARKS ("FLAT SURVEY MARKERS NO. 8134-08 3" TOP DIAMETER" PROVIDED BY KANSAS BLUE PRINT CO., INC.) COSTS TO BE CONSIDERED SUBSIDIARY TO CONSTRUCTION OF COMBINED CURB AND GUTTER.

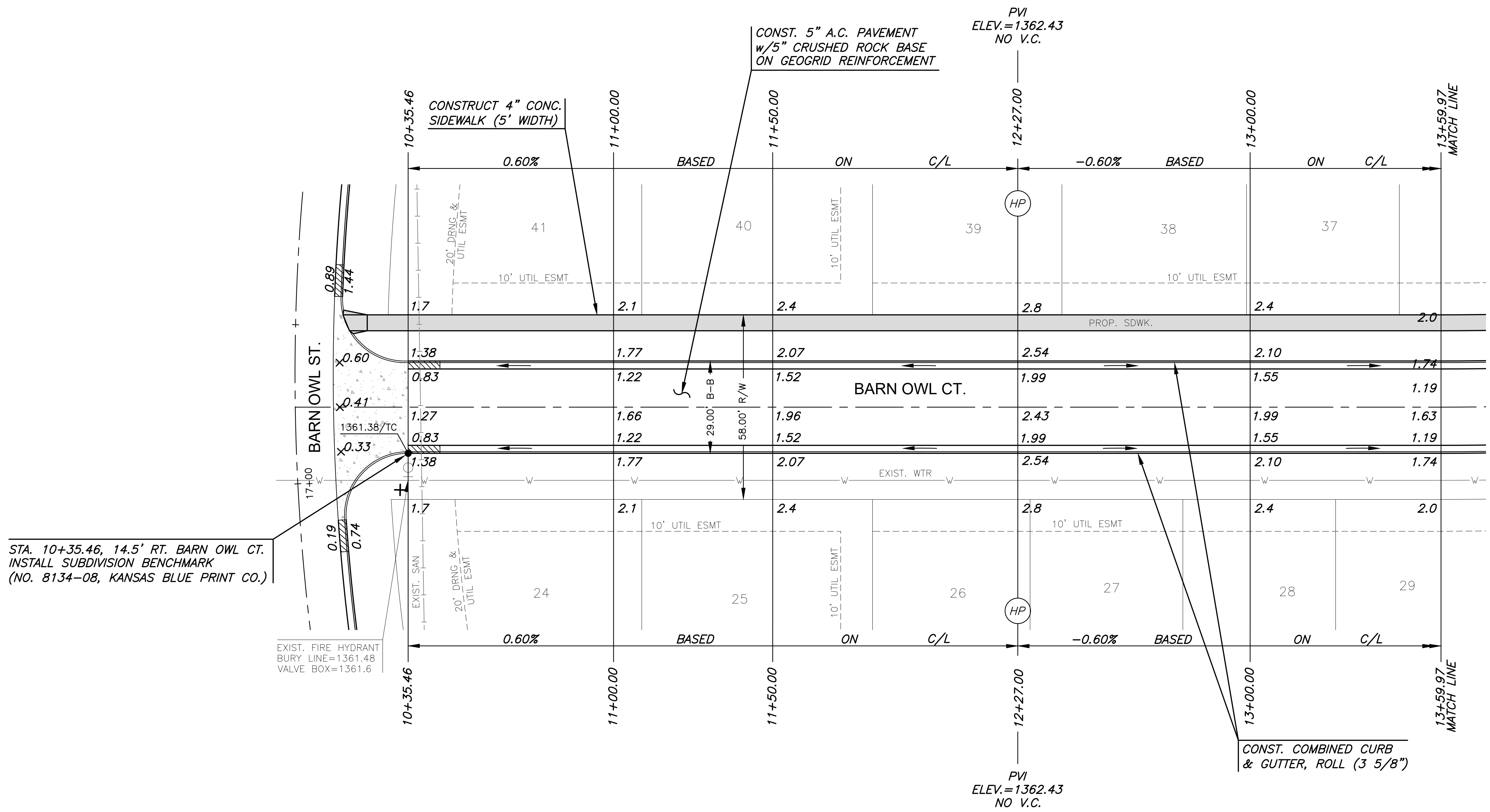

STA. 10+35.46, 14.5' RT. BARN OWL CT. INSTALL SUBDIVISION BENCHMARK (NO. 8134-08, KANSAS BLUE PRINT CO.)

EXIST. FIRE HYDRANT BURY LINE=1361.48 VALVE BOX=1361.6

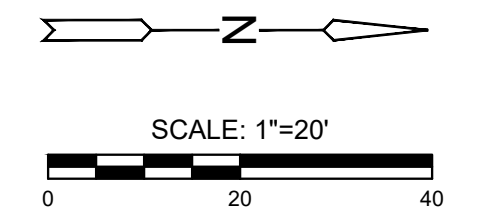

**LEGEND**

- STREET SIGN & SIGN LOCATION (SEE SIGN ASSEMBLY TABLE FOR TYPE & STATION OF SIGN)
- 10' TRANSITION FROM FULL TO ROLL CURB

NOTE:  
 1. TOP OF CURB ELEVATIONS SHOWN ARE FOR FULL CURB. CONSTRUCT CURB AND GUTTER AS NOTED.  
 2. SCH. 40 PVC SLEEVES TO BE BURIED AT A DEPTH OF 2' TO TOP OF SLEEVE, MINIMUM



PAVING & INCIDENTAL DRAINAGE PLANS TO SERVE  
**COURTYARDS AT JACOBS FARM**  
 WICHITA, KS

©2023 MKEC Engineering All Rights Reserved www.mkec.com  
 These drawings and their contents, including, but not limited to, all concepts, designs, & ideas are the exclusive property of MKEC Engineering (MKEC), and may not be used or reproduced in any way without the express consent of MKEC.

**BARN OWL CT. (WEST)**

PROJECT NO.	472-2023-085880	
DATE	JULY 2023	
SCALE	1" = 20'	
DESIGNED	DRAWN	CHECKED
DFL	LAL	SPE
NO.	REVISION	DATE
SHEET NO.		
14 OF 65		