

PLOTTED: Tuesday, July 25, 2023 @ 10:28AM

J:\PROJECTS\2022\2201010296\_PERFECTION\_JACOBS\135TH AND CENTRAL\00\_220296\_CAD\SHOTS\05\_CIVIL\PAV\22296-05-507.DWG

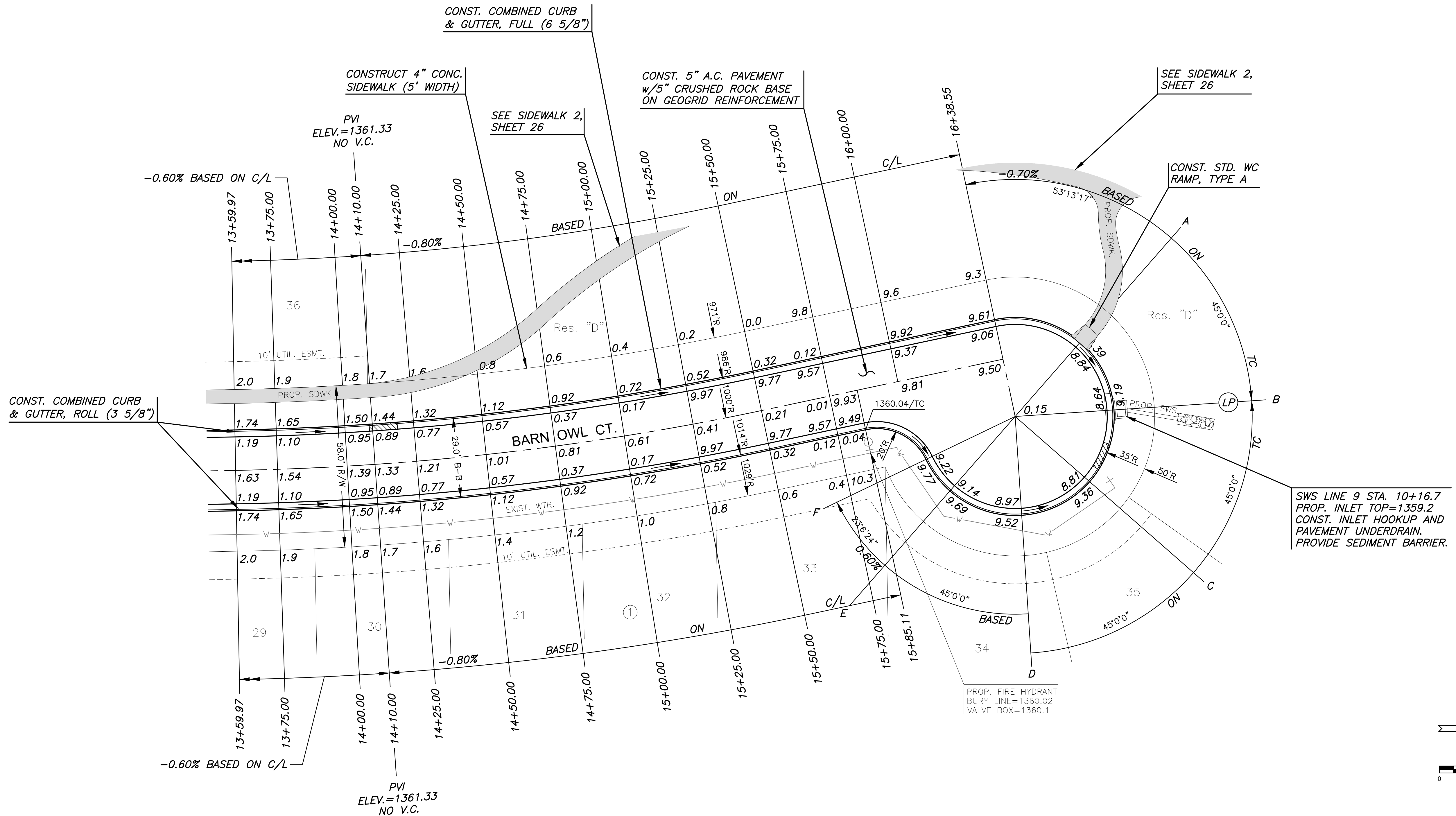

# PAVING & INCIDENTAL DRAINAGE PLANS TO SERVE COURTYARDS AT JACOBS FARM WICHITA, KS



SWS LINE 9 STA. 10+16.7  
PROP. INLET TOP=1359.2  
CONST. INLET HOOKUP AND  
PAVEMENT UNDERDRAIN.  
PROVIDE SEDIMENT BARRIER.

PROP. FIRE HYDRANT  
BURY LINE=1360.02  
VALVE BOX=1360.1

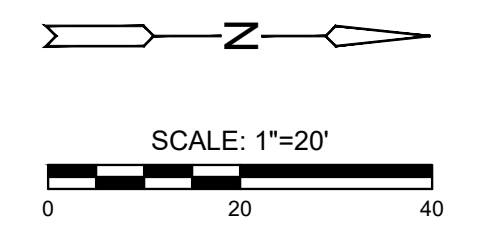

### LEGEND

- ✦ + STREET SIGN & SIGN LOCATION  
(SEE SIGN ASSEMBLY TABLE  
FOR TYPE & STATION OF SIGN)
- ▨ 10' TRANSITION FROM  
FULL TO ROLL CURB

NOTE:  
1. TOP OF CURB ELEVATIONS SHOWN  
ARE FOR FULL CURB. CONSTRUCT  
CURB AND GUTTER AS NOTED.  
2. SCH. 40 PVC SLEEVES TO BE  
BURIED AT A DEPTH OF 2' TO TOP  
OF SLEEVE, MINIMUM

©2023  
MKEC Engineering  
All Rights Reserved  
www.mkec.com  
These drawings and their contents,  
including, but not limited to, all concepts,  
designs, & ideas are the exclusive  
property of MKEC Engineering (MKEC),  
and may not be used or reproduced in any  
way without the express consent of MKEC.

### BARN OWL CT. (WEST CONT.)

PROJECT NO.	472-2023-085880	
DATE	JULY 2023	
SCALE	1" = 20'	
DESIGNED	DRAWN	CHECKED
DFL	LAL	SPE
NO.	REVISION	DATE
SHEET NO.		
15 OF 65		