

# STORM WATER DRAIN #286

## TO SERVE LOTS 1-60 BLOCK 1, LOTS 1-3 BLOCK 2 OF EMERALD BAY ESTATES

### PROJECT NUMBER 468-84140

### OCA # 751417

#### GENERAL NOTES

1. Contractor will be required to provide a minimum advance notice of forty-eight (48) hours to utility companies prior to starting any excavation as follows:

Kansas One-Call 687-2470

The Contractor must notify the following in case of an emergency:

Cox Communications 262-0661  
 Kansas Gas Service 383-8600  
 Westar 383-8600  
 Aquila Energy 1-800-303-0357  
 SBC 1-800-286-8313  
 City of Wichita Water Department 262-6000  
 City of Wichita Sewer Maintenance 262-6000

2. Existing utilities and their location, as shown on the plans, represent the best information obtainable for design. Location information has been obtained from the various utility companies and is either from company record drawings or company-provided field locations. The Contractor will be required to work around existing utilities within the right-of-way which do not conflict with proposed construction.

3. Underground utility service lines and overhead utility pole lines are to be adjusted as necessary by others prior to construction unless the plans specifically call for their adjustment by the Contractor or unless the plans specifically identify a utility to be adjusted by its owner during construction. Existing utilities and their location, as shown on the plans, represent the best information obtainable for design. Location information has been obtained from the various utility companies and is either from company record drawings or company-provided field locations. The Contractor will be required to work around existing utilities within the right-of-way which do not conflict with proposed construction.

4. All areas of public R/W disturbed by construction of this project are to be restored in accordance with Administrative Regulation AR 78 of the City of Wichita.

5. Rubble from the removal of miscellaneous structures and excess excavation which is to be wasted shall be disposed of on sites to be provided by the Contractor. These sites shall be approved by the Engineer as to suitability, appearance and site location. Locations that, in the opinion of the Engineer, will leave an unsightly appearance will not be approved. All disposal sites must be approved by the Kansas Department of Health and Environment. Material either stockpiled or disposed of in a flood plain would require a Kansas State Board of Agriculture permit. Any material dumped in waters of the United States or wetlands is subject to U.S. Corps. of Engineers permitting regulations. Any material buried or stockpiled beyond approved construction limits would require additional archaeological investigations unless buried in a previously approved borrow location.

6. Properties within the project limits may have underground sprinkler systems in public right-of-way which conflict with new construction. The Contractor will be required to remove such improvements should they not be removed by their owner at the time of construction of the project. The Contractor will be required to salvage all sprinkler heads and/or valves and give such materials to their owner. Portions of underground sprinkler systems not in conflict with new construction shall be protected from damage and shall remain in place. All work in connection with underground sprinkler systems shall be considered as subsidiary to the contract pay items of work.

7. Trees and shrubs in public right-of-way shall be saved and protected from damage. Trees may be removed and reset at Contractor's option.

8. The Contractor shall give all property owners and/or tenants of developed property directly abutting the construction of this project a minimum of ten (10) days notice prior to start of construction.

9. The Contractor shall be responsible for preserving property irons. The Contractor will be required to re-establish any property irons which are damaged or destroyed by his construction operations. Such irons shall be re-established by a licensed land surveyor in accordance with state laws.

10. All lawn areas disturbed during construction shall be restored to equal or better condition than prior to construction, using grass sod of the same variety as existing.

11. All water mains and appurtenances shall be installed in accordance with City of Wichita, Kansas, Standard Specifications for the Construction of City Projects.

12. Opening and closing water valves shall be done slowly to prevent damage to the water distribution system from water hammer. All valves closed by the Contractor must be reopened as new construction permits. Project inspector must ascertain that any valve closed by the Contractor is reopened. Contractor will be permitted to operate water valves only when the project inspector assigned to the project is present.

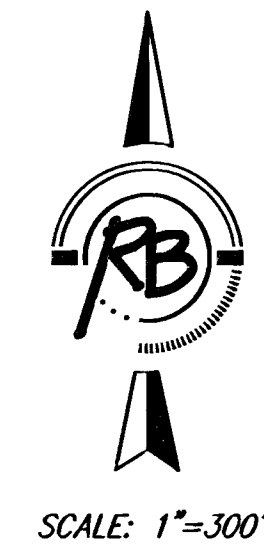
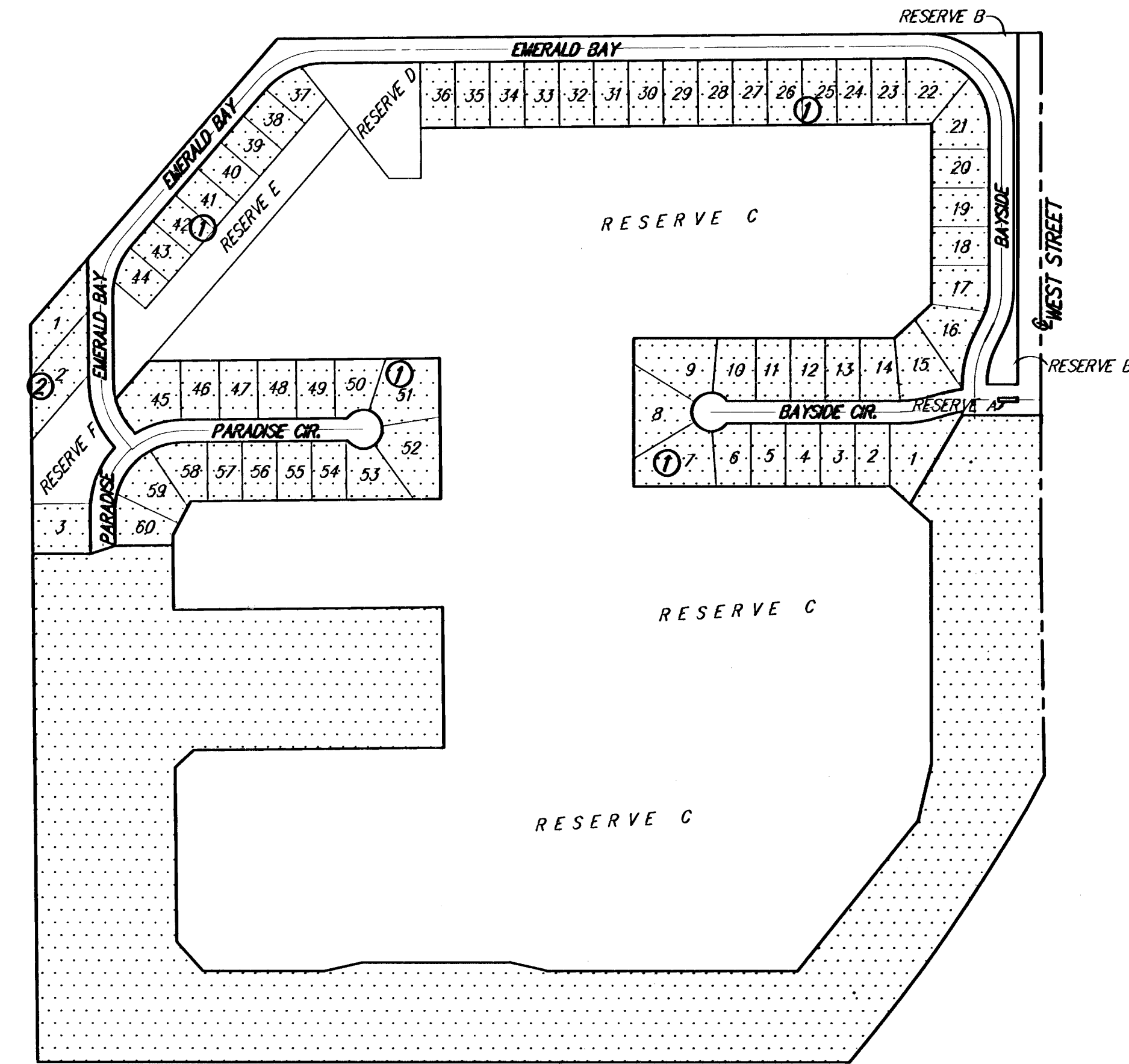

**BENEFIT DISTRICT**

**CITY OF WICHITA, KANSAS**  
**JAMES L. ARMOUR, P.E. - CITY ENGINEER**

#### INDEX OF SHEETS

1. TITLE SHEET
2. STORM SEWER PLAN & PROFILE
- 3-6. SITE GRADING
- 7-8. EROSION CONTROL PLAN
9. EROSION CONTROL PLAN
- 10-13. EROSION CONTROL DETAILS
14. TYPE "P" MANHOLE DETAIL
15. CURB INLET DETAIL
16. SITE GRADING PLAN

#### BENCHMARK

COW DISK AT NORTHWEST CORNER OF INTERSECTION OF 21ST AND HOOVER 48.50' WEST OF CENTERLINE OF HOOVER AND 28.0' NORTH OF CENTERLINE OF 21ST STREET.

ELEVATION: 1326.47 (MSL)

COW DISK AT SOUTHWEST CORNER OF INTERSECTION OF 29TH AND HOOVER, 48.50' WEST OF CENTERLINE OF HOOVER AND 26.5' SOUTH OF CENTERLINE.

ELEVATION: 1330.16 (MSL)

AS BUILT  
 3-23-07  
 WZ

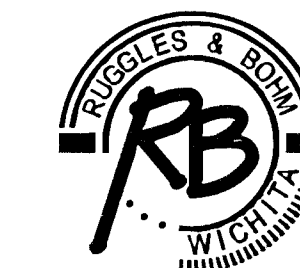
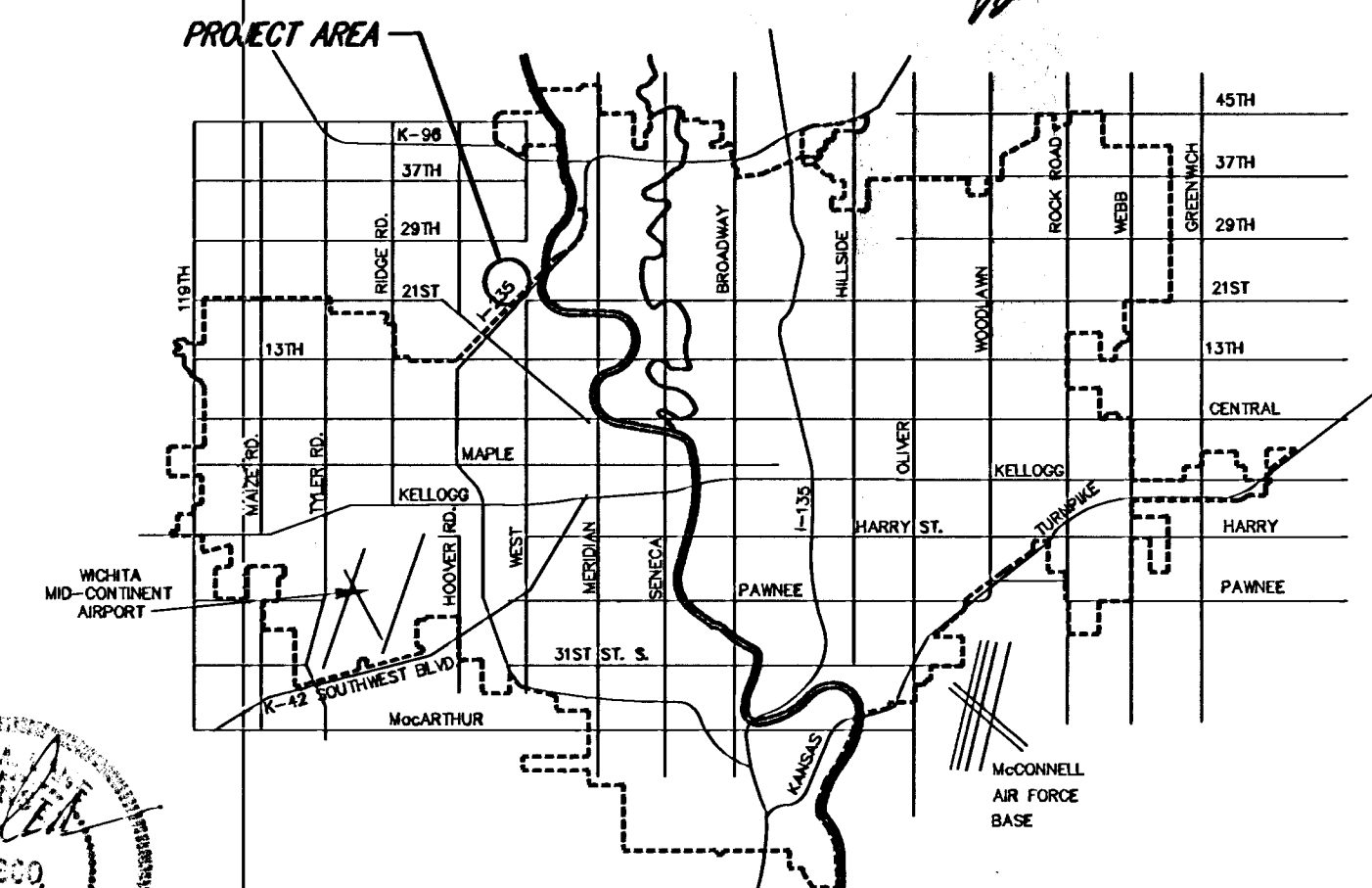

**Ruggles & Bohm, P.A.**  
 Engineering, Surveying, Land Planning  
 924 North Main (316) 264-8008  
 Wichita, Kansas 67203 (316) 264-4621 fax  
 www.rbkansas.com E-mail: info@rbkansas.com