

STA. 0+62.54 LINE 1
STREET STA. 10+52.98, 18.84' LT. (F.I.F.)
CONSTRUCT INLET TYPE 1A
L = 10'-0" W = 3'-0"
TOP ELEV. = 1383.72

STA. 0+00 LINE 1
INSTALL 30" END SECTION
FL OUT = 1376.00
INSTALL 33 S.Y. LIGHT
STONE RIP-RAP AS INDICATED

STA. 1+03.22 LINE 1
STREET STA. 10+52.98, 18.84' LT. (F.I.F.)
CONSTRUCT INLET TYPE 1A
L = 10'-0" W = 3'-0"
TOP ELEV. = 1383.72

STA. 3+16.26 LINE 1
CONSTRUCT STANDARD MH TYPE P
DIA. 5.0' W/ BEEHIVE TOP
TOP ELEV. = 1383.90

STA. 3+16.26 LINE 1
CONSTRUCT STANDARD MH TYPE P
DIA. 5.0' W/ BEEHIVE TOP
TOP ELEV. = 1383.90

STA. 5+28.49 LINE 1
STREET STA. 6+59.95, 18.34' LT. (F.I.F.)
CONSTRUCT INLET TYPE 1A
L = 10'-0" W = 3'-0"
TOP ELEV. = 1384.86

STA. 4+86.66 LINE 1
STREET STA. 6+71.70, 18.34' LT. (F.I.F.)
CONSTRUCT INLET TYPE 1A
L = 10'-0" W = 3'-0"
TOP ELEV. = 1384.91

BRENTWOOD
SOUTH

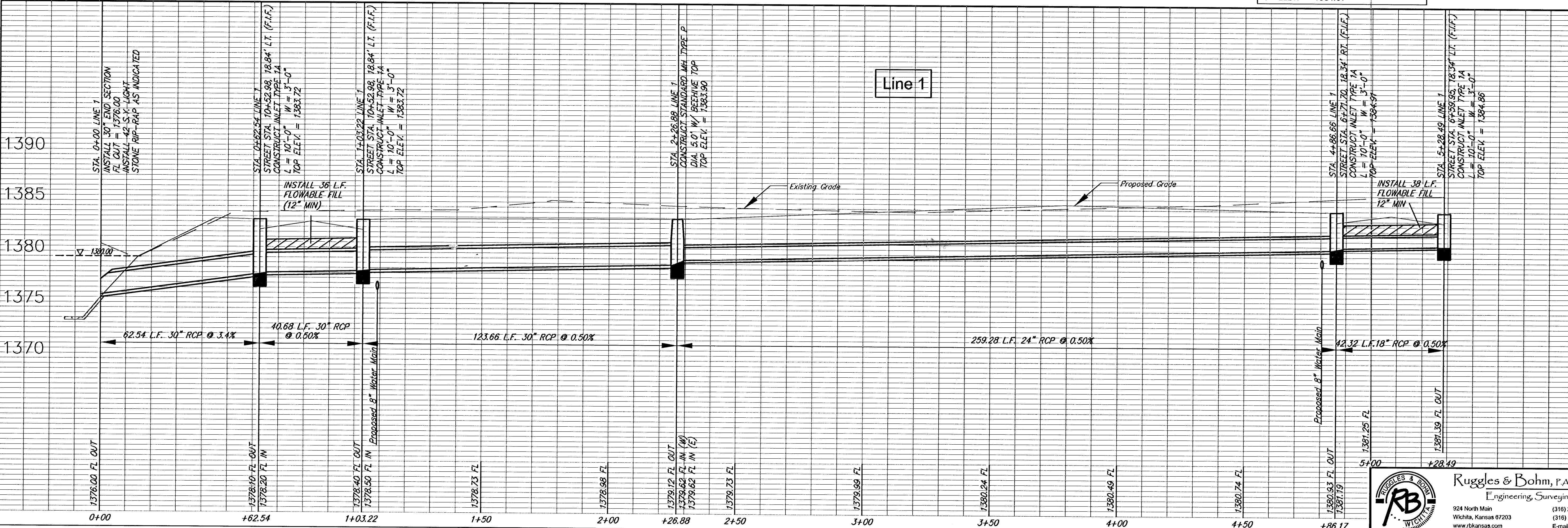
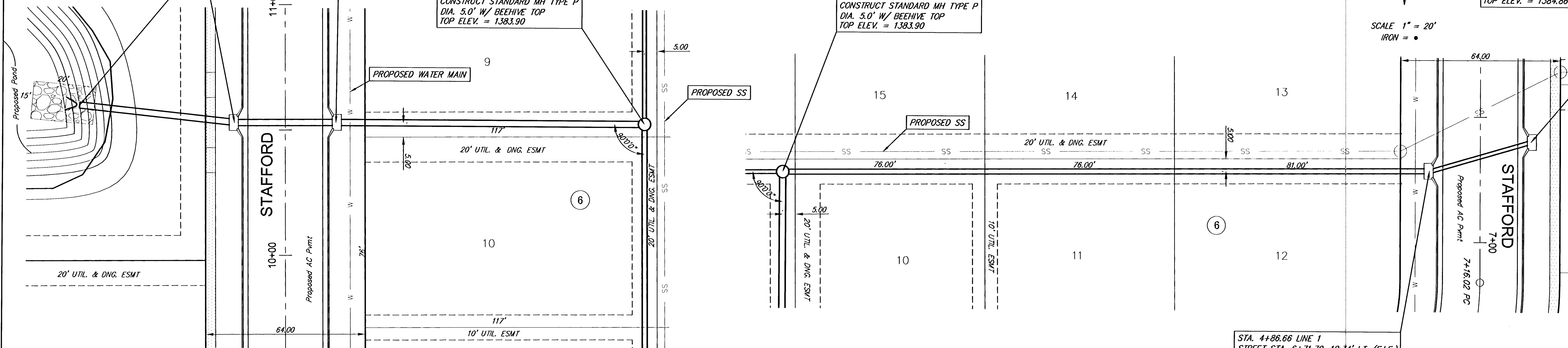
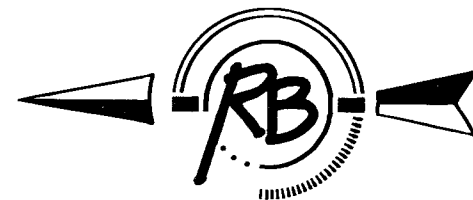

DESIGN	DRAWN	REVISION
KML	RLS	

PROJECT NUMBER	DATE	REVISION
storm sewer [s.w.s.]	Sept. 21, 2005	

Storm Sewer Improvements
SWS Line 1
WICHITA, KANSAS

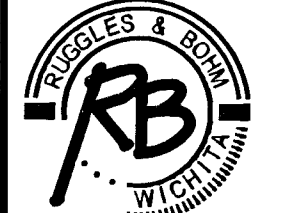

Ruggles & Bohm, P.A.
Engineering, Surveying, Land Planning
924 North Main
Wichita, Kansas 67203
www.rbkansas.com
(316) 264-0008
(316) 264-4621 fax
E-mail: info@rbkansas.com

11
OF
30