

**GENERAL NOTES:**

- Contractor will be required to provide notice to utility companies a minimum of seventy-two (72) hours prior to any excavation, as follows:  
 Kansas One-Call 687-2470  
 The Contractor must notify the following in case of an emergency:  
 Cox Communications 262-4270  
 Kansas Gas Service 1-888-492-4950  
 Evergy 383-8650  
 Black Hills 1-800-303-0357  
 AT&T 268-2245  
 City of Wichita Water Dept. 268-4563  
 City of Wichita Sewer Maint. 268-4024  
 City of Wichita Storm Sewer Maint. 268-4090  
 City of Wichita Traffic Maint. 268-4034  
 Conoco Phillips Pipeline Co. 1-877-267-2290  
 Southern Star Pipeline Co. 529-6600  
 Kinder-Morgan Pipeline Co. 1-888-844-5658

- A saw cut of at least one-half the depth of existing surface courses or one-fourth the depth of the existing total pavement thickness shall be provided at locations where proposed construction abuts the existing surface course or pavement for which partial removal of that surface or pavement is required. Sawed joint to facilitate removal within three (3) feet of existing joints will not be permitted and for such instances the limits of removal shall extend to the existing joint. Such saw cuts will not be paid for directly and this cost shall be considered as subsidiary to the removal of the surface or pavement.
- All areas disturbed by construction within Poplar Ave. R/W shall be seeded as follows:  
 Seed -- Kansas Premium Fescue Blend; 8 lbs. PLS/1000 Sq. Ft.  
 Fertilizer -- 12-24-12 Ratio; 45 Lbs./Ac.  
 Mulch -- 2 Tons Prairie Hay/Ac.
- Excess excavation shall be removed from this site and disposed of by the Contractor.
- Contractor to distribute driveway request form prior to construction to both lot owner on east side of Poplar.

- Utility service lines, poles, valve boxes, meters, and etcetera are to be adjusted as necessary by others prior to construction unless the plans specifically call for their adjustment by the Contractor or unless the plans specifically identify a utility to be adjusted by its owner during construction. Existing utilities and their location, as shown on the plans, represent the best information obtainable for design. The Contractor will be required to work around existing utilities within the right-of-way which do not conflict with proposed construction.
- Rubble from the removal of miscellaneous structures and excess excavation which is to be wasted shall be disposed of on sites to be provided by the Contractor. These sites shall be approved by the Engineer as to suitability, appearance and site location. Locations, in the opinion of the Engineer, that will leave an unsightly appearance will not be approved. All disposal sites must be approved by the Kansas Department of Health and Environment. Material either stockpiled or disposed of in a flood plain would require a Kansas State Board of Agriculture permit. Any material dumped in waters of the United States or wetlands is subject to U.S. Corps. of Engineers permitting regulations. Any material buried or stockpiled beyond approved construction limits would require additional archaeological investigations unless buried in a previously approved borrow location.
- Trees and shrubs in public right-of-way which are in direct conflict with proposed new construction shall be removed by the Contractor ONLY with the City's approval. Trees and shrubs which are not in direct conflict with proposed new construction shall be saved and protected from damage.
- The Contractor shall give all property owners and/or tenants of developed property abutting the construction of this project a minimum of ten (10) days notice prior to start of construction.
- The Contractor shall be responsible for preserving property irons. The Contractor will be required to re-establish any property irons which are damaged or destroyed by his construction operations. Such irons shall be re-established by a licensed Land Surveyor in accordance with state laws.

# POPLAR AVENUE PAVING

From the North line of E 19th St. North to the South line of E Graham St.

## CITY OF WICHITA, KANSAS

Paul Gunzelman, P.E. Interim City Engineer  
 Project Number: 472-2023-085849

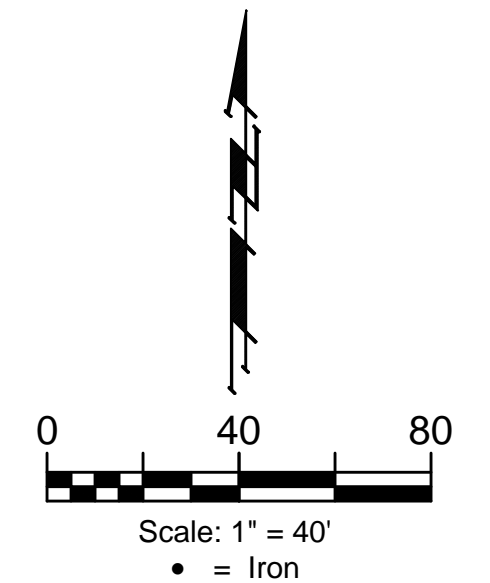

**SHEET INDEX**

Title Sheet	1
Asphalt Paving Detail	2
Poplar Avenue	3
Erosion Control Plan	4
Erosion Control BMP Details	5-9
Cross Sections	10
Coordinate Sheet	11
Copy of Plat	12

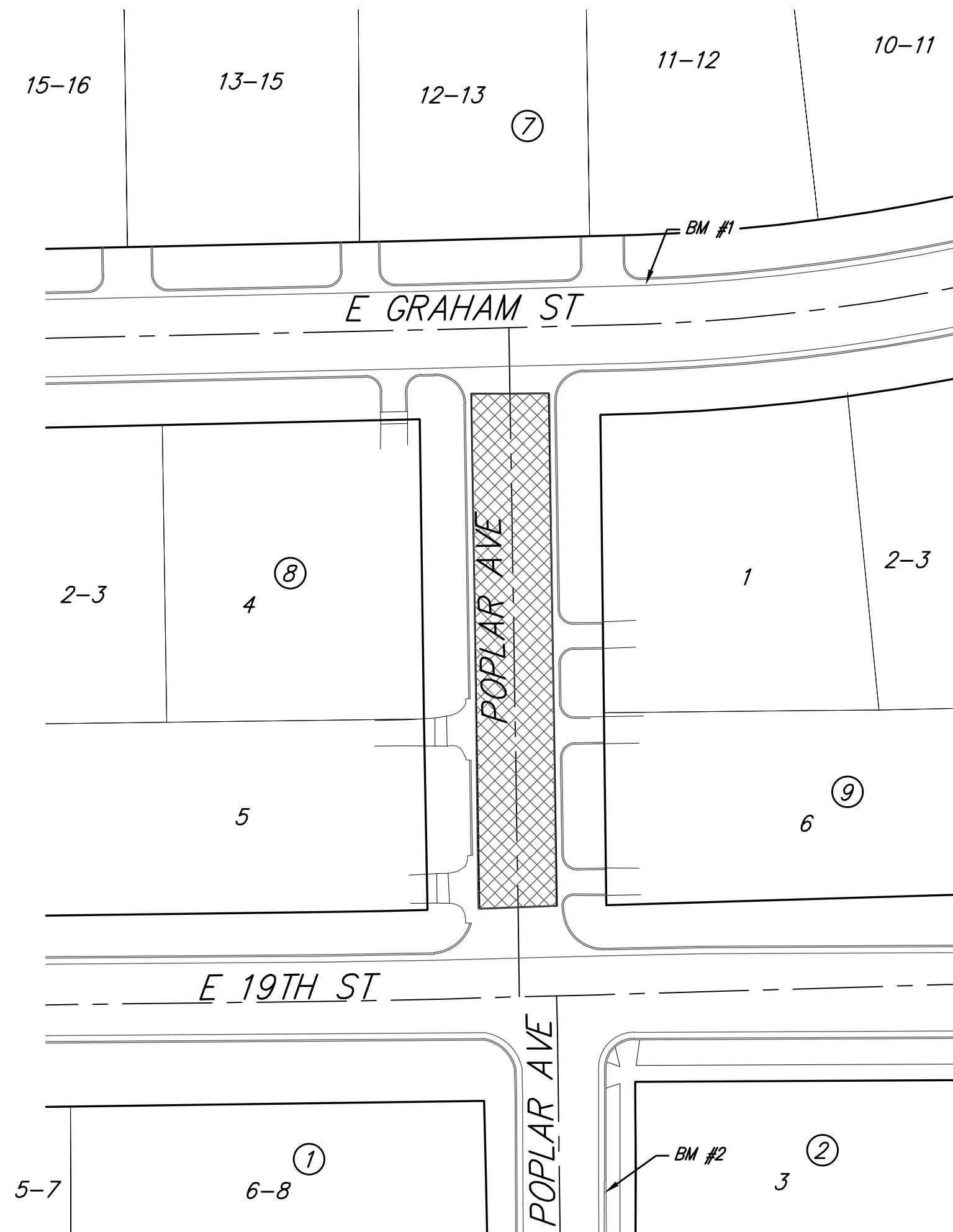

**BENCHMARKS**

**BENCHMARK #1**  
 Square cut set on the top of curb. 15 ft S and 18 ft E of W Lot corner 11-12 BLK 7.  
 Elev. = 1322.38 (NAVD88)

**BENCHMARK #2**  
 Square cut w/ "x" cut set on the top of curb. 35 ft S and 7 ft W of NW Lot corner 3 BLK 2.  
 Elev. = 1320.50 (NAVD88)

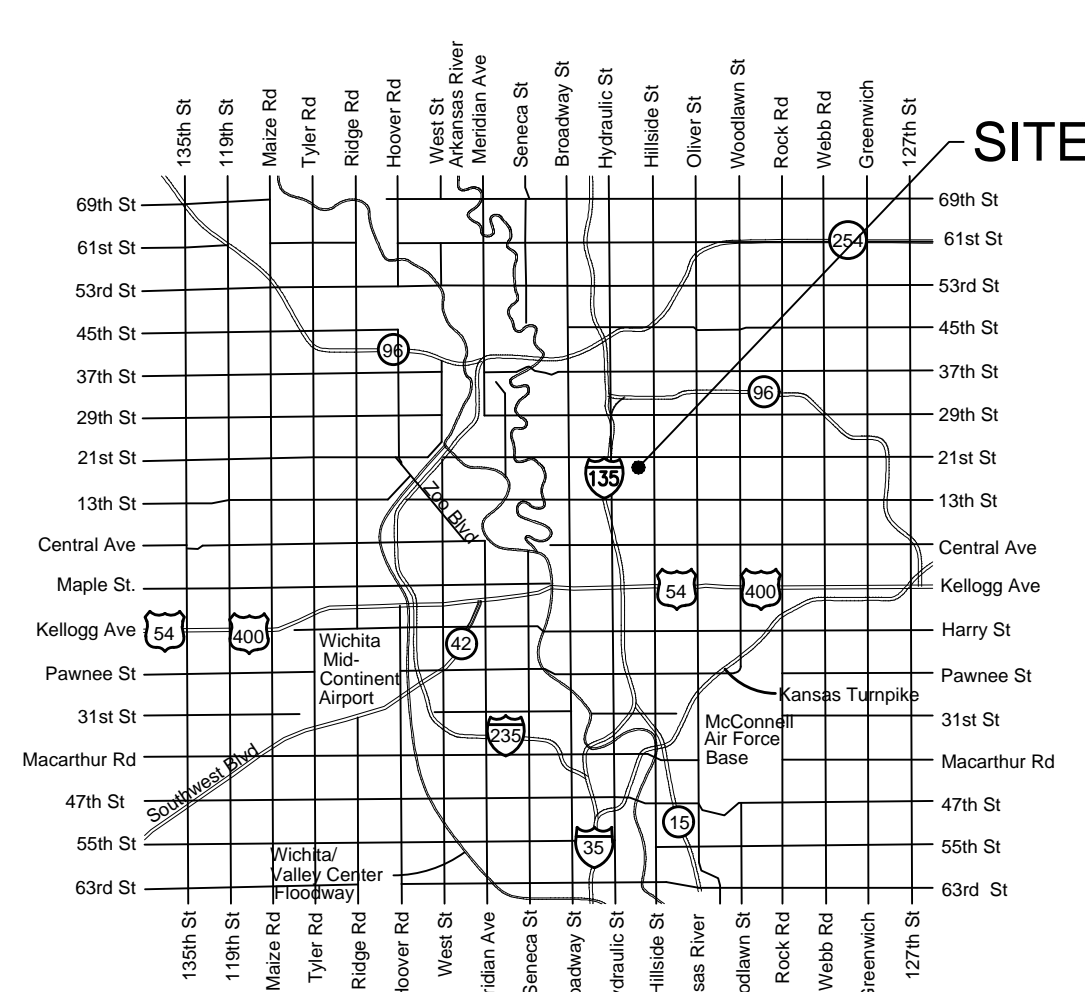

**VICINITY MAP**

Project Earthwork Totals (CY unadjusted)			
	Excavation	Compacted Fill	Loose Fill
Project Total	125	0	0
<b>Total Project Length</b>			
172 L.F. = 0.03 Miles			

PROPOSED STREETS:



Apr. 25, 2023

**BAUGHMAN COMPANY**  
 315 Ellis St. Wichita, KS 67211 316-262-7271  
 BaughmanCo.com

C:\Projects\Poplar Ave. & 10th Street 22-11-E5723\Engineering\Poplar Ave. 19th to Graham\STR Plans.dwg