

2+75 10TH ST N

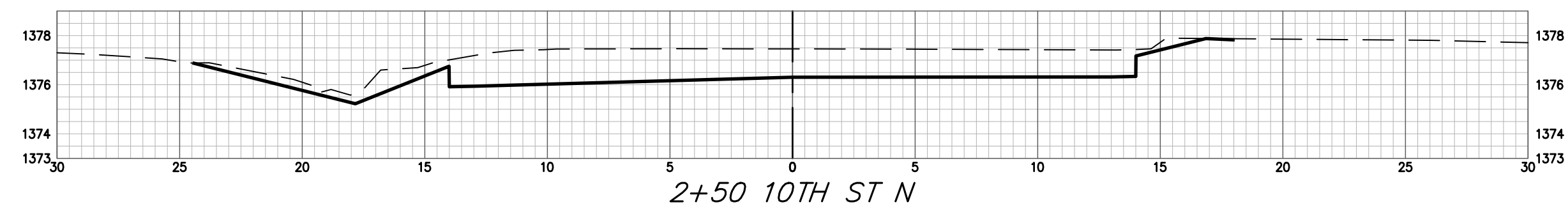

2+50 10TH ST N

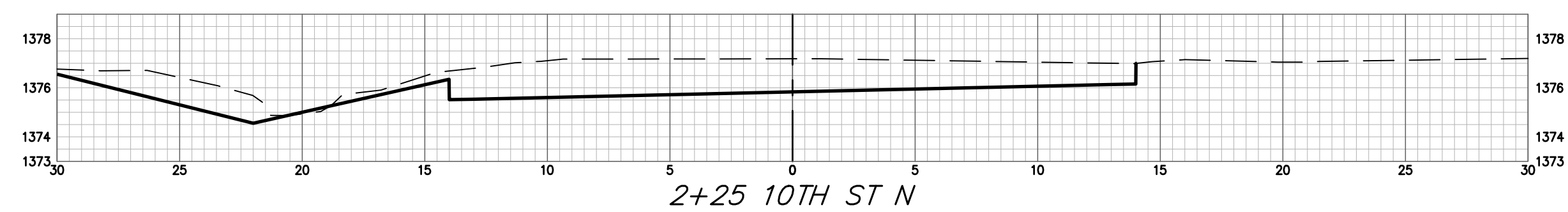

2+25 10TH ST N

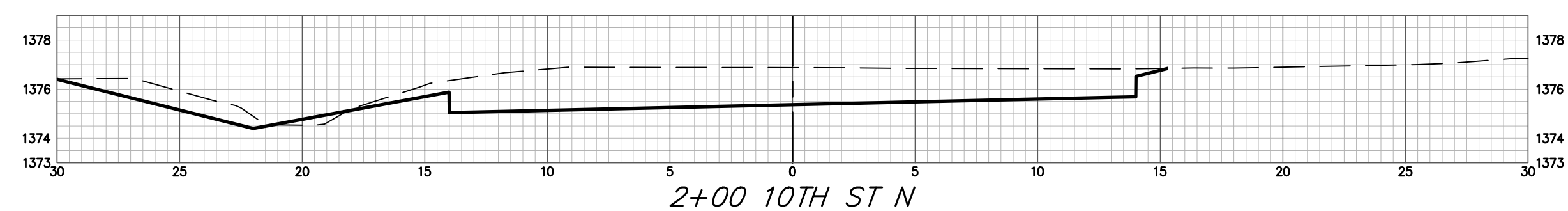

2+00 10TH ST N

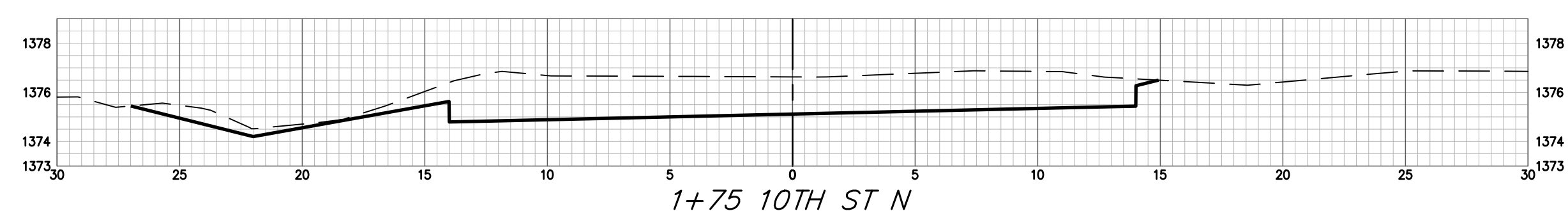

1+75 10TH ST N

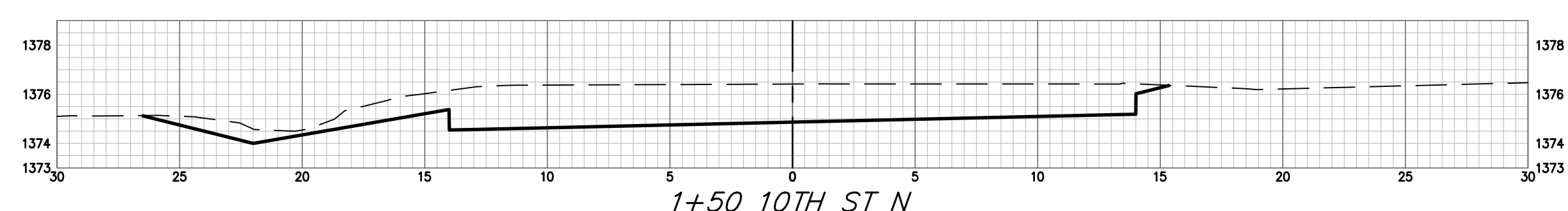

1+50 10TH ST N

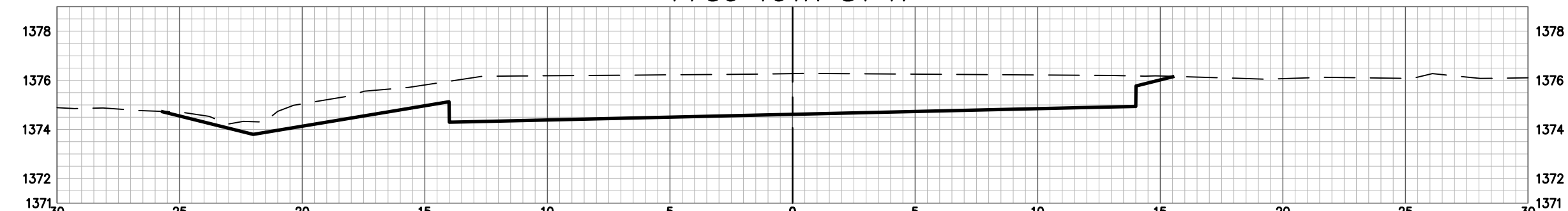

1+25 10TH ST N

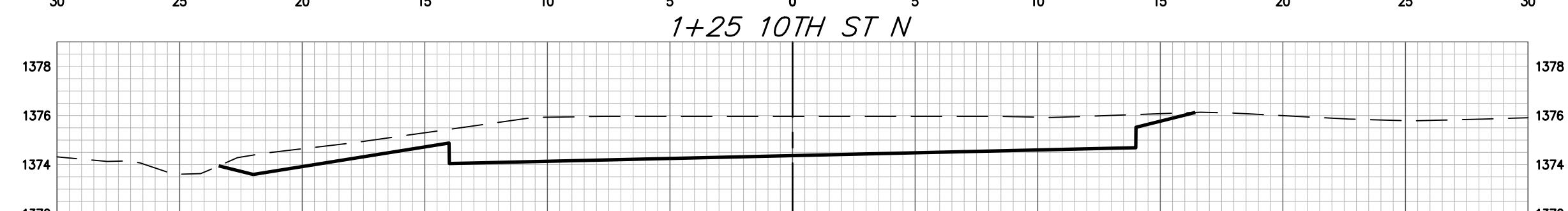

1+00 10TH ST N

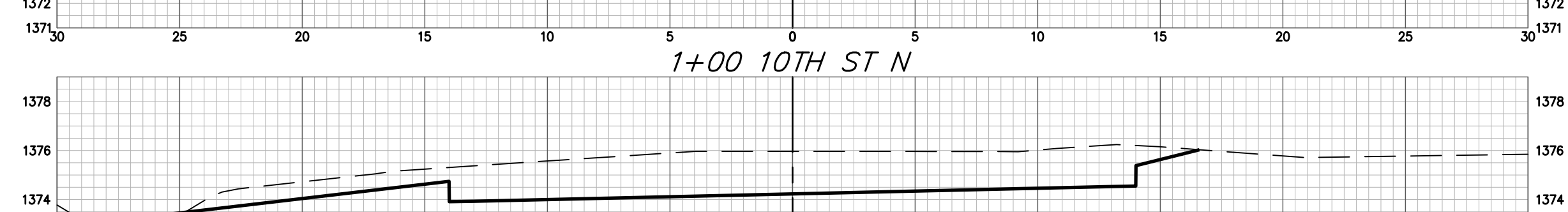

0+75 10TH ST N

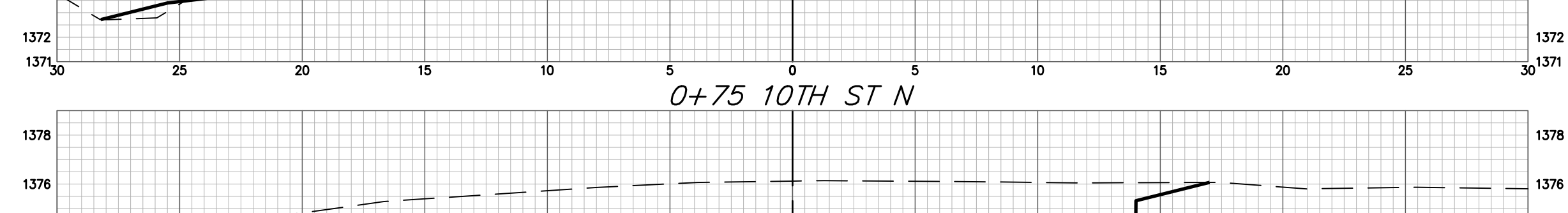

0+63 10TH ST N

10TH ST N CY Excavation (unadjusted)				10TH ST N CY loose Fill (unadjusted)			
Station	Area	Volume	Total	Station	Area	Volume	Total
0+63	60.49	0.00	0.00	0+63	0.78	0.00	0.00
0+75	53.78	25.40	25.40	0+75	0.89	0.37	0.37
1+00	50.31	48.19	73.59	1+00	0.00	0.41	0.78
1+25	52.98	47.82	121.41	1+25	0.00	0.00	0.78
1+50	49.90	47.63	169.03	1+50	0.00	0.00	0.78
1+75	49.25	45.90	214.93	1+75	0.00	0.00	0.78
2+00	47.45	44.77	259.70	2+00	0.59	0.27	1.06
2+25	44.39	42.52	302.22	2+25	0.13	0.33	1.39
2+50	38.60	38.43	340.64	2+50	0.00	0.06	1.45
2+75	29.08	31.33	371.98	2+75	0.39	0.18	1.63
2+89.93	23.50	14.54	386.52	2+89.93	0.09	0.13	1.76

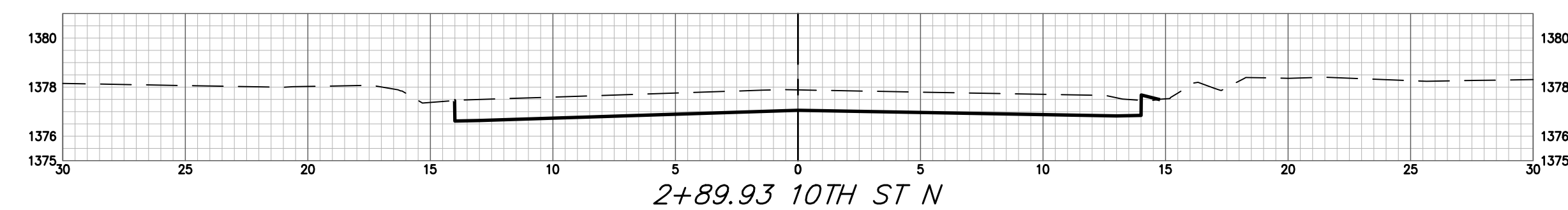

2+89.93 10TH ST N

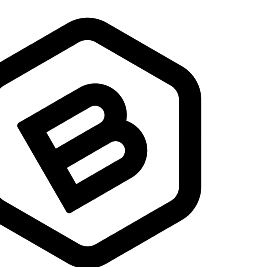

**BAUGHMAN
COMPANY**

315 Ellis St.
Wichita, KS 67211
316-262-7271
BaughmanCo.com

10th Street North

**EARTHWORK
CROSS
SECTIONS**

Paving Improvements

PROJECT NUMBER:
472-2023-085851

DESIGN: NBW DRAWN: JAK

DATE: Apr. 24, 2023

SHEET **12** OF **13**