

PLOTTED: Thursday, September 14, 2023 @ 02:24PM

J:\PROJECTS\2021\101010427_PERFECTION_COURTYARDS AT MOORINGS\DWG 210427 CAD\SH1505 CIVIL\PAVPH121427-05-500-PH1.DWG

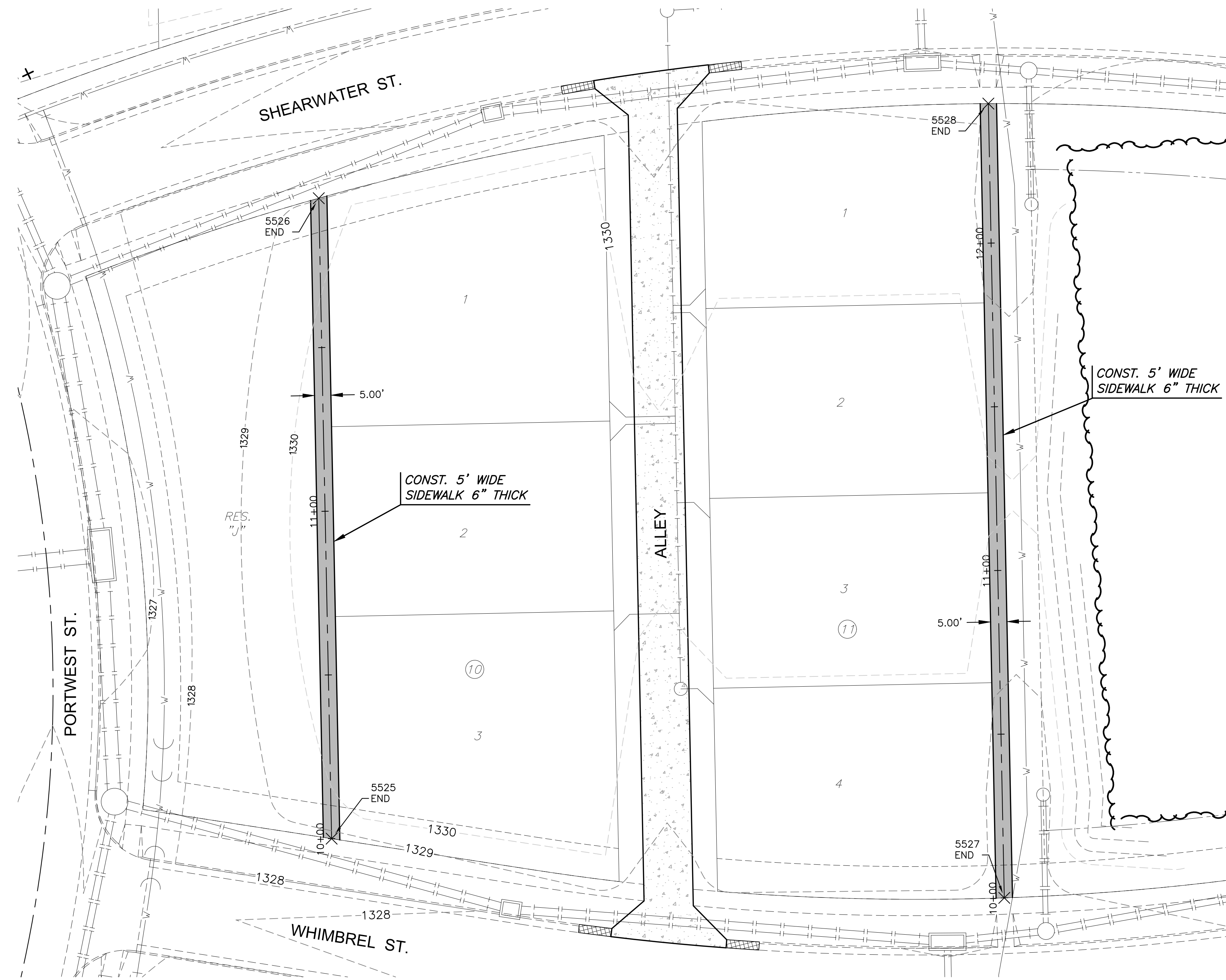

PAVING POINTS				
Point #	Northing	Easting	Desc.	Elev.
5525	1714172.95	1637232.34	END	1328.55
5526	1714368.53	1637228.41	END	1328.66
5527	1714154.86	1637437.74	END	1328.87
5528	1714397.42	1637432.87	END	1328.91

- NOTES:**
- CONTRACTOR SHALL INSTALL SIDEWALK FORMS MIN. 1 WEEK PRIOR TO CASTING CONCRETE SIDEWALK.
 - CONTRACTOR SHALL ACQUIRE MKEC'S LANDSCAPE ARCHITECT WRITTEN APPROVAL OF FORMWORK PRIOR TO SIDEWALK INSTALLATION.
 - CONTRACTOR SHALL GIVE MKEC'S REPRESENTATIVE 2 DAYS NOTICE PRIOR TO INSTALLATION OF SIDEWALK FORMS.

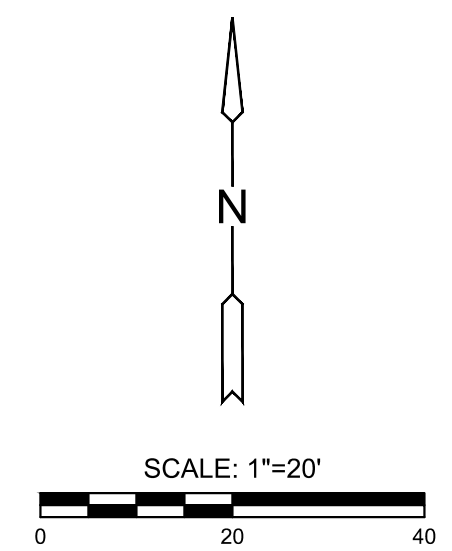

PAVING & INCIDENTAL DRAINAGE PLANS FOR

COURTYARDS AT THE MOORINGS

PHASE 1 - PART B

©2023
MKEC Engineering
All Rights Reserved
www.mkec.com
These drawings and their contents, including, but not limited to, all concepts, designs, & ideas are the exclusive property of MKEC Engineering (MKEC), and may not be used or reproduced in any way without the express consent of MKEC.

SIDEWALK LAYOUT 2 OF 2

PROJECT NO.	472-2022-085820B	
DATE	SEPT. 2023	
SCALE	1" = 20'	
DESIGNED	DRAWN	CHECKED
DFL	JWC	SPE

NO.	REVISION	DATE