

BENCHMARKS:
 BM-1#
 SQUARE CUT ON TOP OF CURB 119.3'± N.
 & 6.4'± W. OF SE. COR. LOT 7, BLOCK 2,
 TURTLE RUN 3RD ADDITION.
 ELEV. = 1390.32 NAVD88

BM-2#
 SQUARE CUT ON TOP OF CURB 118.4'± N.
 OF SE. COR. LOT 6, BLOCK 2, TURTLE
 RUN 2ND ADDITION.
 ELEV. = 1391.04 NAVD88

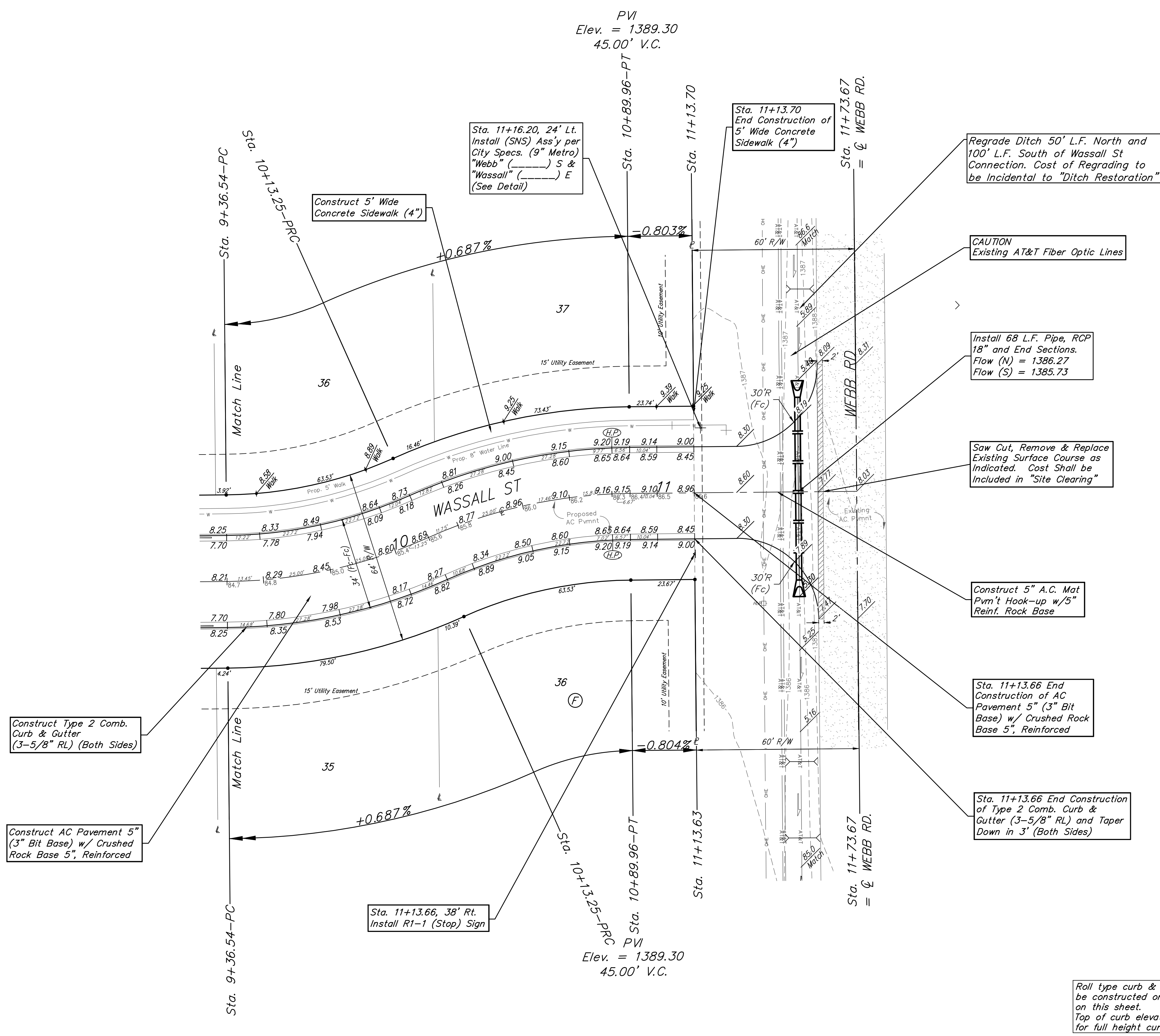
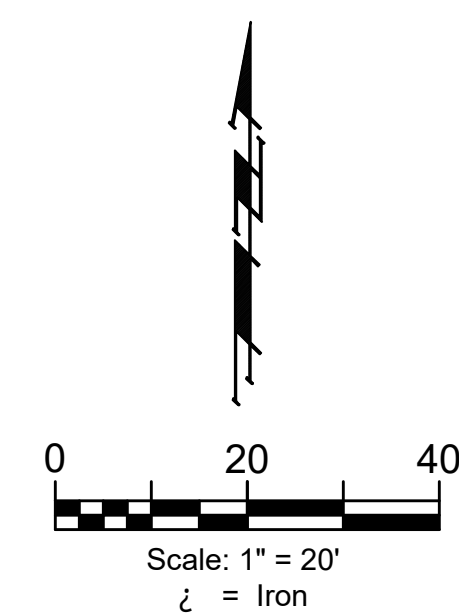

Regrade Ditch 50' L.F. North and 100' L.F. South of Wassall St Connection. Cost of Regrading to be Incidental to "Ditch Restoration"

CAUTION
Existing AT&T Fiber Optic Lines

Install 68 L.F. Pipe, RCP
18" and End Sections.
Flow (N) = 1386.27
Flow (S) = 1385.73

Saw Cut, Remove & Replace Existing Surface Course as Indicated. Cost Shall be Included in "Site Clearing"

Construct 5" A.C. Mat Pvm't Hook-up w/5" Reinf. Rock Base

Sta. 11+13.66 End Construction of AC Pavement 5" (3" Bit Base) w/ Crushed Rock Base 5", Reinforced

Sta. 11+13.66 End Construction of Type 2 Comb. Curb & Gutter (3-5/8" RL) and Taper Down in 3' (Both Sides)

Construct Type 2 Comb. Curb & Gutter (3-5/8" RL) (Both Sides)

Construct AC Pavement 5" (3" Bit Base) w/ Crushed Rock Base 5", Reinforced

Sta. 11+13.66, 38' Rt. Install R1-1 (Stop) Sign

Roll type curb & gutter to be constructed on the pavement on this sheet. Top of curb elevation are given for full height curb.

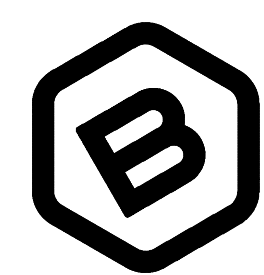

BAUGHMAN COMPANY

315 Ellis St.
Wichita, KS 67211
316-262-7271
BaughmanCo.com

TOWNE PARC 10TH ADDITION PHASE 1

WASSALL ST

Sta. 9+36.54 to Sta. 11+73.67
Street Paving Improvements

PROJECT NUMBER:

DESIGN: NBW DRAWN: JLD

DATE: 28 September 2023

SHEET OF
13 43

File: E:\Projects\Towne Parc 10th Addition_22-01-P743\Engineering\PHASE 1\STR_22-11-E355\STR.dwg