

**BENCHMARKS:**  
 BM-1#  
 SQUARE CUT ON TOP OF CURB 119.3'± N.  
 & 6.4'± W. OF SE. COR. LOT 7, BLOCK 2,  
 TURTLE RUN 3RD ADDITION.  
 ELEV. = 1390.32 NAVD88

BM-2#  
 SQUARE CUT ON TOP OF CURB 118.4'± N.  
 OF SE. COR. LOT 6, BLOCK 2, TURTLE  
 RUN 2ND ADDITION.  
 ELEV. = 1391.04 NAVD88

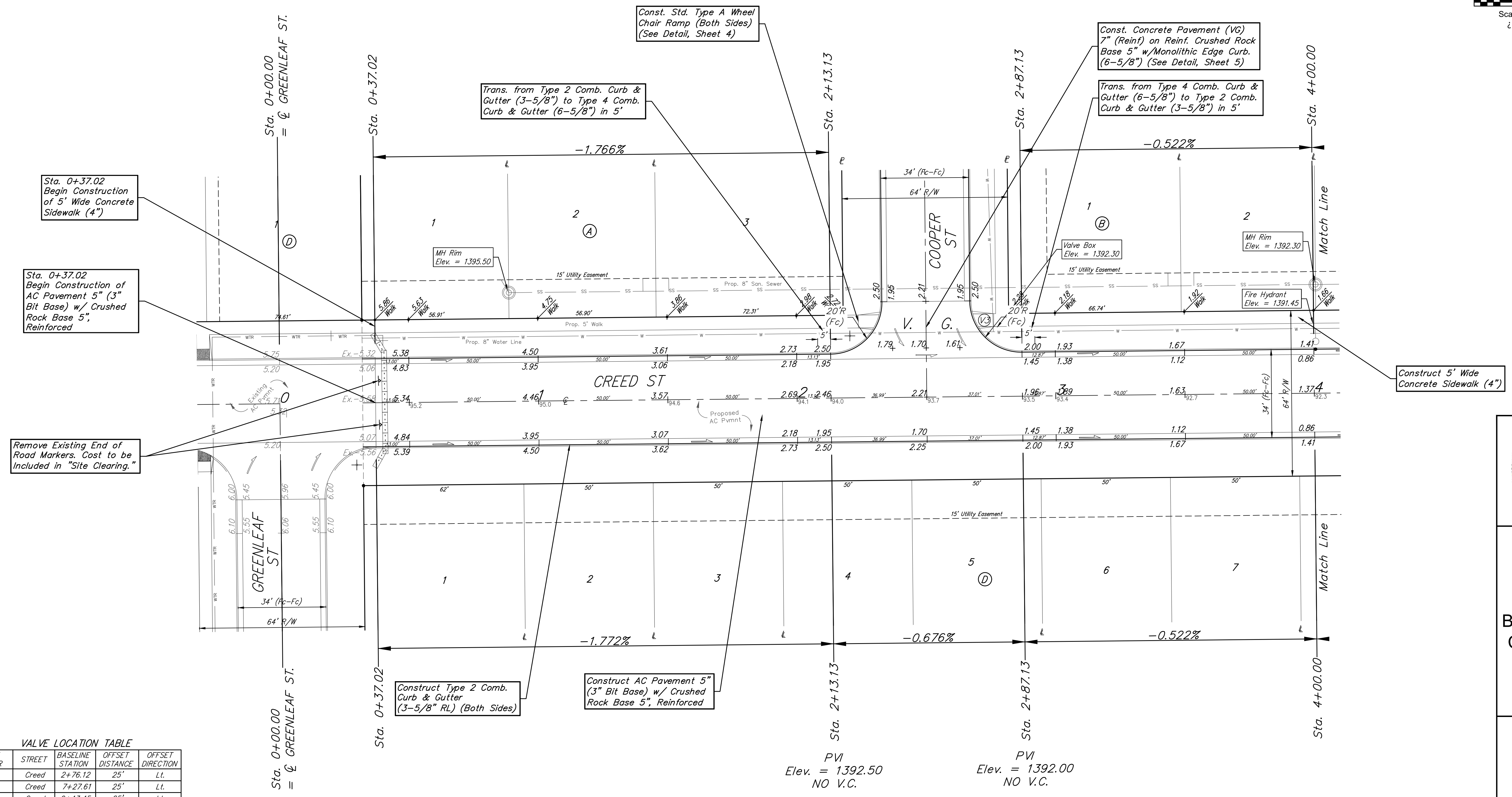
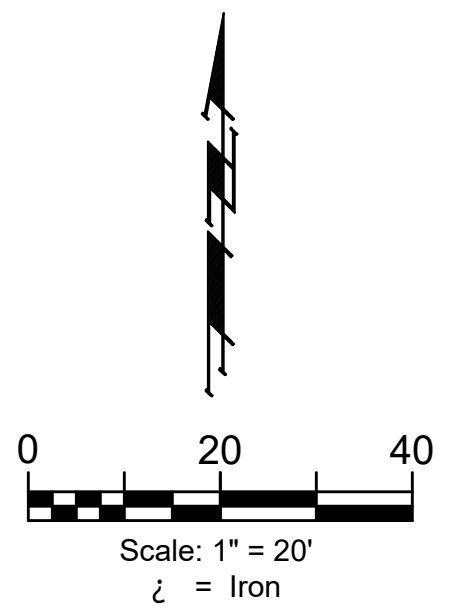

Sta. 0+37.02  
 Begin Construction  
 of 5' Wide Concrete  
 Sidewalk (4")

Sta. 0+37.02  
 Begin Construction  
 of 5" AC Pavement (3"  
 Bit Base) w/ Crushed  
 Rock Base 5",  
 Reinforced

Remove Existing End of  
 Road Markers. Cost to be  
 Included in "Site Clearing."

Construct 5' Wide  
 Concrete Sidewalk (4")

**VALVE LOCATION TABLE**

VALVE NUMBER	STREET	BASELINE STATION	OFFSET DISTANCE	OFFSET DIRECTION
3	Creed	2+76.12	25'	Lt.
4	Creed	7+27.61	25'	Lt.
5	Creed	9+43.45	25'	Lt.

**Subdivision Benchmarks**

Street & Station	Location Description	Elevation
Creed St 4+00.67, 25' Lt.	Adjacent to Fire Hydrant Located at the SE Cor., of Lot 2 and the SW Cor., of Lot 3, Blk B	

PVI  
 Elev. = 1392.50  
 NO V.C.

PVI  
 Elev. = 1392.00  
 NO V.C.

Roll type curb & gutter to  
 be constructed on the pavement  
 on this sheet.  
 Top of curb elevation are given  
 for full height curb.

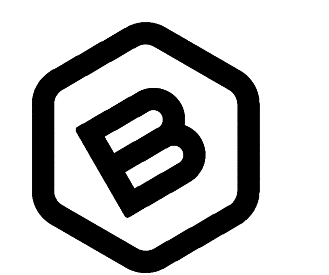

**BAUGHMAN  
 COMPANY**

315 Ellis St.  
 Wichita, KS 67211  
 316-262-7271  
 BaughmanCo.com

TOWNE PARC 10TH  
 ADDITION PHASE 1

**CREED ST**

Sta. 0+00.00 to Sta. 4+00.00  
 Street Paving Improvements

PROJECT NUMBER:

DESIGN: NBW DRAWN: JLD

DATE: 28 September 2023

SHEET OF  
**16 43**

File: E:\Projects\Towne Parc 10th Addition\_22-01-P743\Engineering\PHASE 1\STR\_22-11-E355\STR.dwg