

Benchmarks:

BM #1: Small RR spike in 2nd PP north of K-42 Highway, west side of Maize
Elev. = 143.61 (City Datum)

BM #2: Small RR spike in PP east of East 1/4 Corner (G)
Elev. = 147.00 (City Datum)

BM #3: "□" Top Headwall southeast corner K-42 Highway and Maize (County BM with City Datum)
Elev. = 144.04 (City Datum)



Scale: 1" = 20'
• = Iron

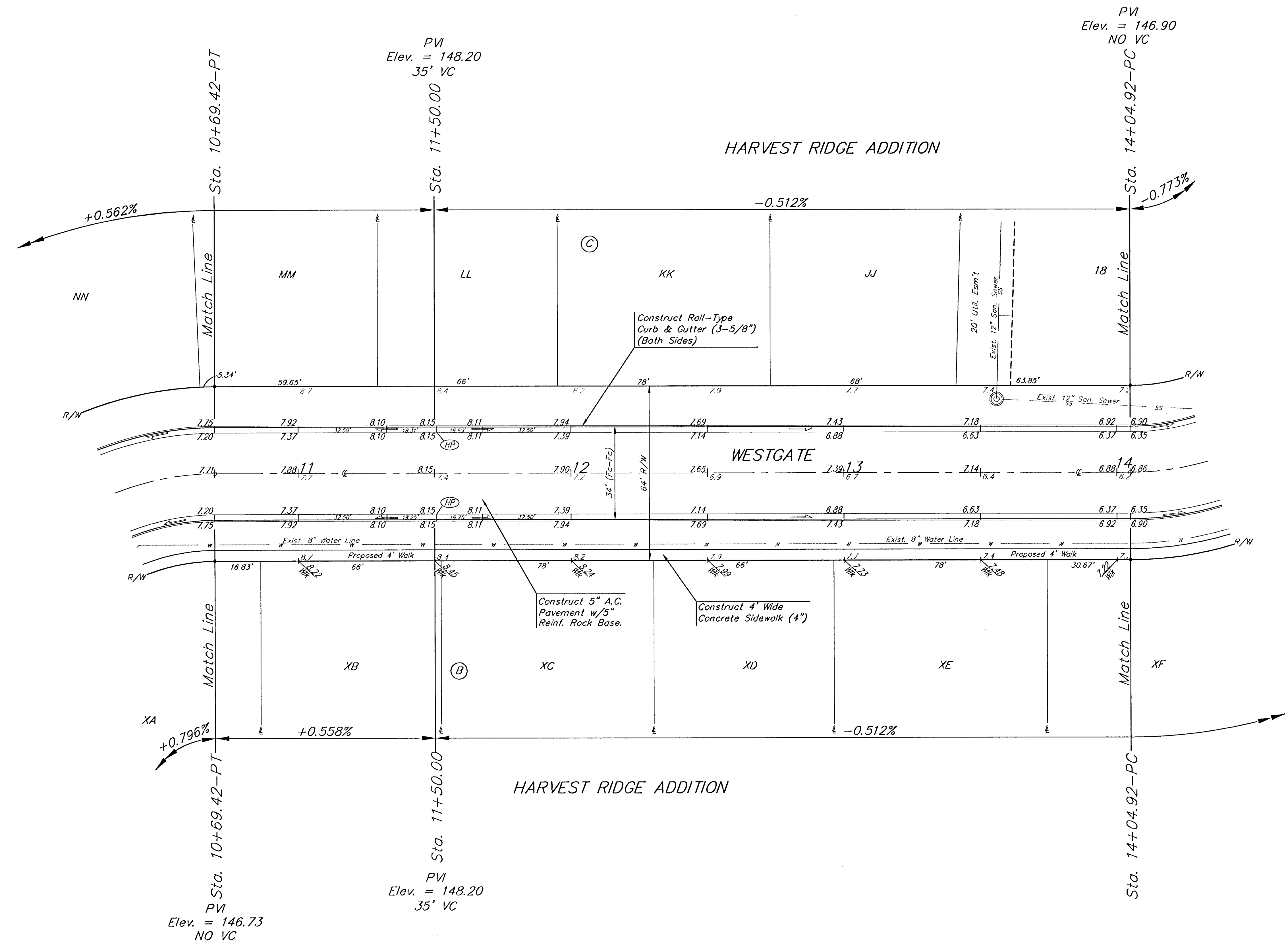

Roll type curb & gutter to be constructed on the pavement on this sheet.
Top of curb elevation are given for full height curb.

		Harvest Ridge Addition - Phase II	
		WESTGATE	
Sta. 10+69.42 STA. 14+04.92		Baughman Company, P.A. 315 Ellis St. White, NJ 07071 P 908-361-1211 F 908-361-1419	
ENGINEERING SURVEYING PLANNING LANDSCAPE ARCHITECTURE		PROJECT NUMBER 472-83805	
DESIGN MWS/JAK	DRAWN JAK	APPROVED MWS	DATE 4/12/06
REVISIONS:		SCALE Noted	
		SHEET 9 OF 24	
E:\Eng\Harvest Ridge\Phase 2\Su5		0601-E485	