

Benchmarks:

BM #1: Small RR spike in 2nd PP north of K-42 Highway, west side of Maize
Elev. = 143.61 (City Datum)

BM #2: Small RR spike in PP east of East 1/4 Corner (G)
Elev. = 147.00 (City Datum)

BM #3: "□" Top Headwall southeast corner K-42 Highway and Maize (County BM with City Datum)
Elev. = 144.04 (City Datum)

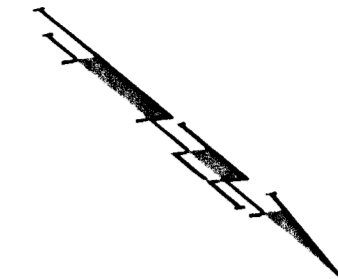

Scale: 1" = 20'
• = Iron

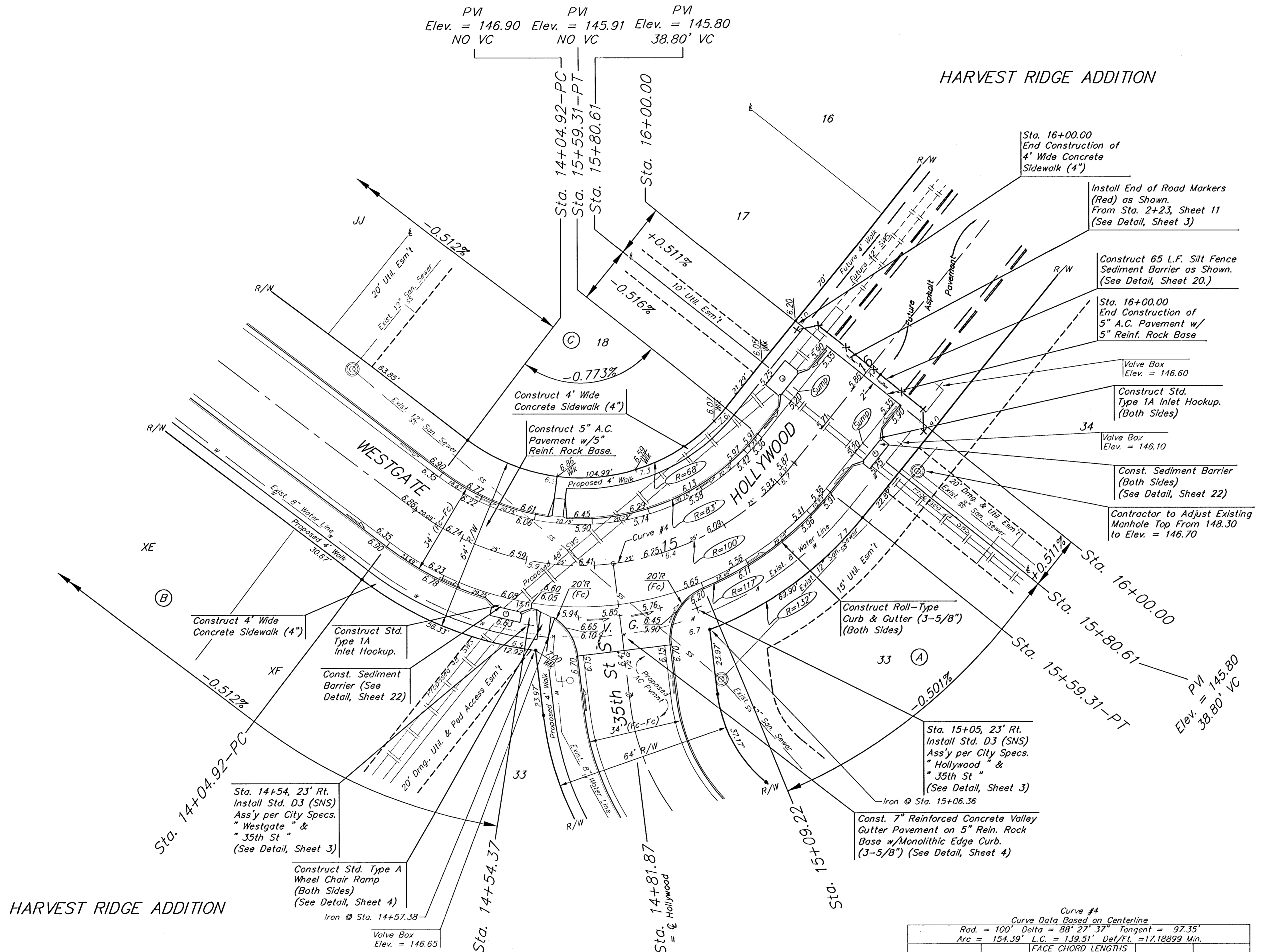

HARVEST RIDGE ADDITION

HARVEST RIDGE ADDITION

Curve #4
Curve Data Based on Centerline
Rad = 100' Delta = 88° 27' 37" Tangent = 97.35'
Arc = 154.39' L.C. = 139.51' Def/Ft. = 17.18899 Min.

Station	Arc	FACE CHORD LENGTHS		Defl.	T. Defl.
		8' Lt.	8' Rt.		
14+04.92	-	-	-	0'00"00"	0'00"00"
14+25.00	20.08'	15.03'	25.06'	5'45"09"	5'45"09"
14+50.00	25.00'	18.70'	31.17'	7'09"44"	12'54"53"
14+54.37	4.37'	3.28'	5.46'	1'15"07"	14'10"00"
14+75.00	20.63'	15.45'	25.74'	5'54"36"	20'04"36"
15+00.00	25.00'	18.70'	31.17'	7'09"44"	27'14"20"
15+09.22	9.22'	6.91'	11.52'	2'38"29"	29'52"49"
15+25.00	15.78'	11.82'	19.70'	4'31"14"	34'24"03"
15+50.00	25.00'	18.70'	31.17'	7'09"44"	41'33"47"
15+59.31	9.31'	6.98'	11.63'	2'40"02"	44'13"49"

Roll type curb & gutter to be constructed on the pavement on this sheet.
Top of curb elevation are given for full height curb.

Harvest Ridge Addition - Phase II
WESTGATE / HOLLYWOOD
STA. 10+69.42 STA. 14+04.92

Baughman
Baughman Company, P.A. 315 Ellis St., Philadelphia, PA 19106-3771 F 215-382-1100
ENGINEERING | SURVEYING | PLANNING | LANDSCAPE ARCHITECTURE

PROJECT NUMBER 472-83805	DESIGN MWS/JAK	DRAWN JAK
REVISIONS:	APPROVED MWS	DATE 4/12/06
SCALE Noted		SHEET 10 OF 34

E:Eng\Harvest Ridge\Phase 2\Su5 C601-E485