

LATERAL 506, SOUTHWEST INTERCEPTOR SEWER

PROJ. NO. 468-83953

OCA NO. 744107

CITY OF WICHITA, KANSAS

JAMES L. ARMOUR, PE - CITY ENGINEER

GENERAL NOTES:

- ALL CONSTRUCTION AND MATERIAL TO COMPLY WITH CITY OF WICHITA SPECIFICATIONS AND STANDARDS.
- THE CONTRACTOR SHALL NOTIFY THE UTILITY SERVICE COMPANIES TO FLAG THEIR UNDERGROUND LINES AND REQUEST ANY OVERHEAD POLE/LINE ADJUSTMENTS 48 HOURS PRIOR TO CONSTRUCTION.
KANSAS ONE-CALL 1-800-344-7233
- THE UNDERGROUND UTILITY SERVICE LINES AND OVERHEAD UTILITY POLE LINES ARE TO BE ADJUSTED AS NECESSARY BY OTHERS PRIOR TO CONSTRUCTION UNLESS THE PLANS SPECIFICALLY CALL FOR THEIR ADJUSTMENT BY THE CONTRACTOR. EXISTING UTILITIES AND THEIR LOCATION, AS SHOWN ON THE PLANS, REPRESENT THE BEST INFORMATION OBTAINABLE FOR DESIGN. LOCATION INFORMATION HAS BEEN OBTAINED FROM THE VARIOUS UTILITY COMPANIES AND IS EITHER FROM COMPANY RECORD DRAWINGS OR COMPANY PROVIDED FIELD LOCATIONS. THE CONTRACTOR WILL BE REQUIRED TO WORK AROUND EXISTING UTILITIES WITHIN THE RIGHT-OF-WAY WHICH DO NOT CONFLICT WITH PROPOSED CONSTRUCTION.
- THE CONTRACTOR SHALL GIVE ALL PROPERTY OWNERS AND/OR TENANTS DIRECTLY AFFECTED BY THE CONSTRUCTION OF THIS PROJECT A MINIMUM OF FIVE (5) DAYS ADVANCE WRITTEN NOTICE PRIOR TO START OF CONSTRUCTION.
- ALL TREES AND SHRUBS IN DIRECT CONFLICT WITH PROPOSED CONSTRUCTION SHALL BE REMOVED AS DIRECTED BY THE FIELD ENGINEER, REGARDLESS OF WHAT IS SHOWN ON THE PLANS.
- THE CONTRACTOR SHOULD EXAMINE THE CONSTRUCTION SITE PRIOR TO BIDDING AND BE SATISFIED AS TO THE WORK SHOWN FOR COMPLETION.
- ANY FENCE REMOVED DURING CONSTRUCTION MUST BE REPLACED AND RESTORED TO ORIGINAL CONDITION.
- UTILITY EASEMENT AND FENCE RESTORATION SHALL BE SUSPENDED FOR THREE WEEKS FROM THE DATE THE SEWER IS TESTED AND ACCEPTED BY THE ENGINEERING DIVISION, DEPARTMENT OF PUBLIC WORKS, TO ALLOW PROPERTY OWNERS TIME TO INSTALL HOOKUPS TO THE SEWER MAIN. CONTRACTORS SHALL NOTIFY PROPERTY OWNERS, IN WRITING, OF THIS AGREEMENT.
- THE CONTRACTOR SHALL EXCAVATE THE END OF THE SEWER LINE TO DETERMINE THE EXISTING ALIGNMENT, ELEVATION AND GRADE. ANY DISCREPANCY BETWEEN THE PROJECT PLANS AND EXISTING CONDITIONS SHALL BE REPORTED TO THE AREA ENGINEER PRIOR TO CONSTRUCTION OF THE NEW SEWER LINE. NO ADJUSTMENT TO ALIGNMENT AND GRADE MAY BE MADE WITHOUT PRIOR APPROVAL OF THE AREA ENGINEER.
- ALL AREAS DISTURBED BY CONSTRUCTION SHALL BE RESTORED WITH SOD TO MATCH EXISTING TURF TYPE.

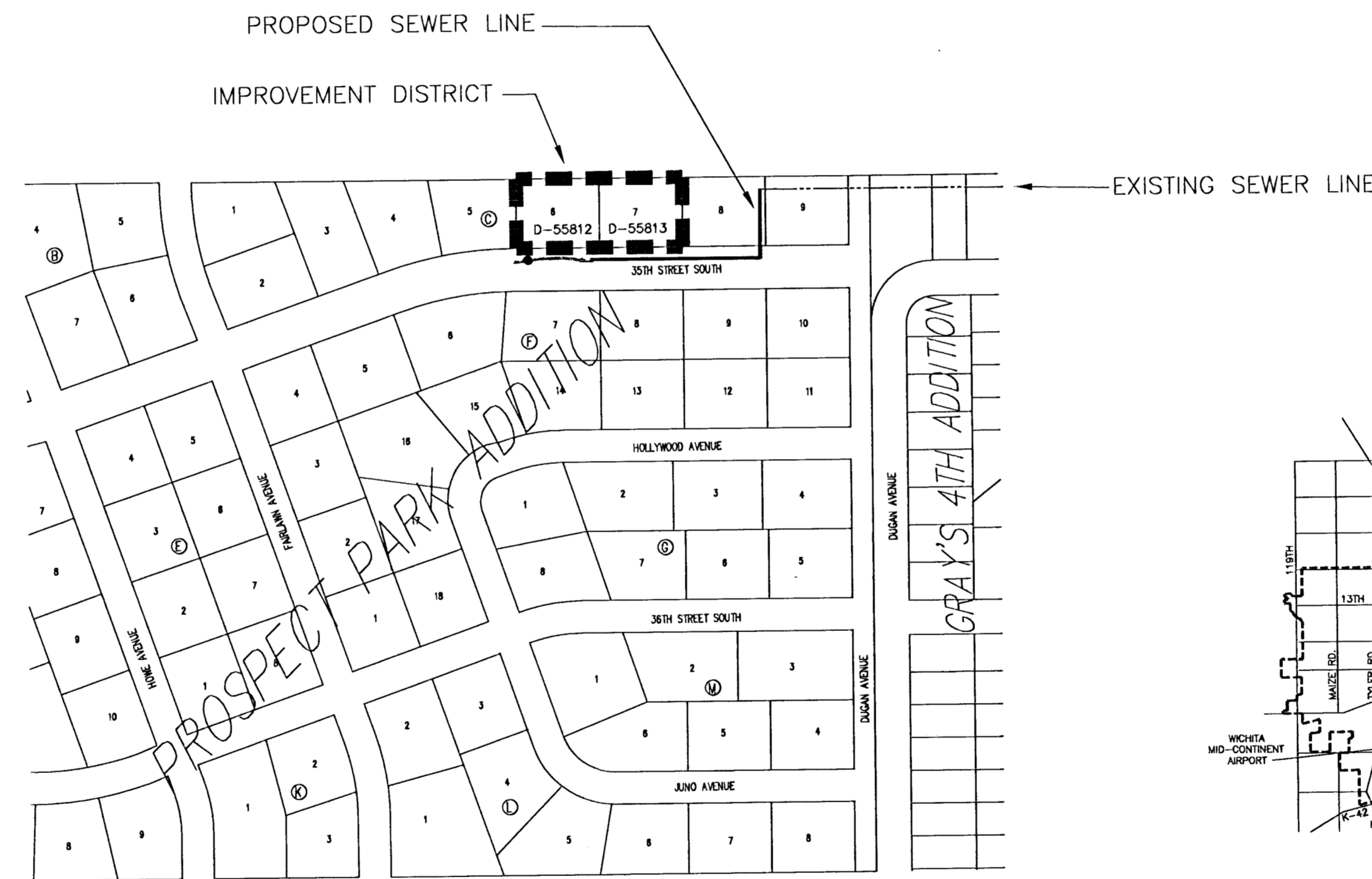

WB Carter Construction Co, Inc. - Contractor
Hartman, City - Inspector
Released 4/09/07
As-Built
Stub
.pdf by JDL 4/23/07

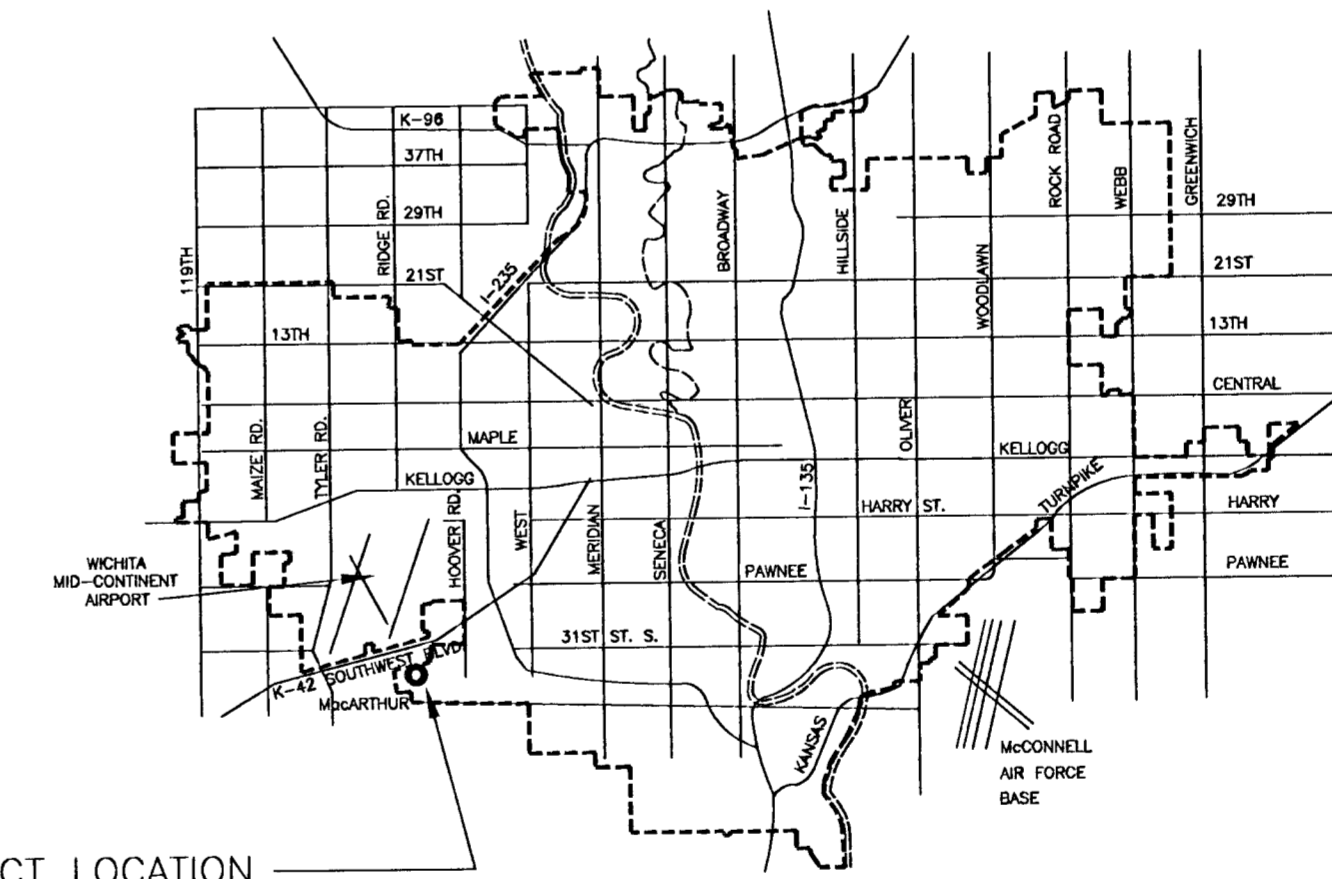

VICINITY MAP

INDEX OF SHEETS

SHEET 1 - TITLE SHEET
SHEET 2 - PLAN/PROFILE
SHEETS 3-5 - MANHOLE DETAIL
BMPs AVAILABLE UPON REQUEST

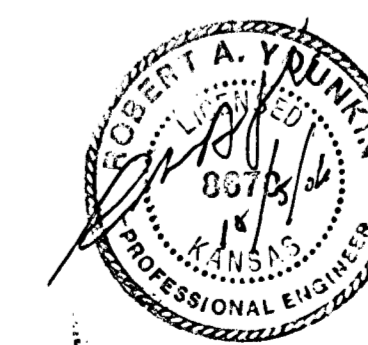

Prospect Park Sewer - L506 SWI