

ADD 6" ADJUSTMENT RING TO EXISTING MANHOLE AND INSTALL CONCRETE FIELD CAP.
NEW TOP ELEV = 1272.54

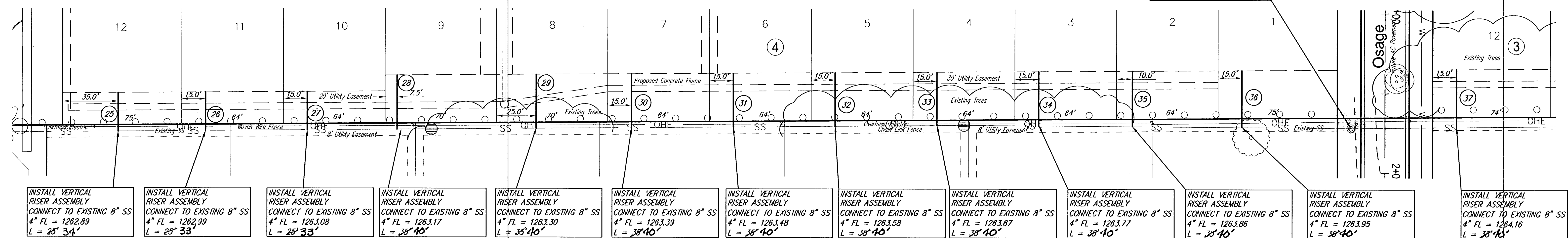

- INSTALL VERTICAL RISER ASSEMBLY CONNECT TO EXISTING 8" SS
4" FL = 1262.89
L = 25' 34"
- INSTALL VERTICAL RISER ASSEMBLY CONNECT TO EXISTING 8" SS
4" FL = 1262.99
L = 25' 33"
- INSTALL VERTICAL RISER ASSEMBLY CONNECT TO EXISTING 8" SS
4" FL = 1263.08
L = 25' 33"
- INSTALL VERTICAL RISER ASSEMBLY CONNECT TO EXISTING 8" SS
4" FL = 1263.17
L = 35' 40"
- INSTALL VERTICAL RISER ASSEMBLY CONNECT TO EXISTING 8" SS
4" FL = 1263.30
L = 35' 40"
- INSTALL VERTICAL RISER ASSEMBLY CONNECT TO EXISTING 8" SS
4" FL = 1263.39
L = 35' 40"
- INSTALL VERTICAL RISER ASSEMBLY CONNECT TO EXISTING 8" SS
4" FL = 1263.48
L = 35' 40"
- INSTALL VERTICAL RISER ASSEMBLY CONNECT TO EXISTING 8" SS
4" FL = 1263.58
L = 35' 40"
- INSTALL VERTICAL RISER ASSEMBLY CONNECT TO EXISTING 8" SS
4" FL = 1263.67
L = 35' 40"
- INSTALL VERTICAL RISER ASSEMBLY CONNECT TO EXISTING 8" SS
4" FL = 1263.77
L = 35' 40"
- INSTALL VERTICAL RISER ASSEMBLY CONNECT TO EXISTING 8" SS
4" FL = 1263.86
L = 35' 40"
- INSTALL VERTICAL RISER ASSEMBLY CONNECT TO EXISTING 8" SS
4" FL = 1263.95
L = 35' 40"
- INSTALL VERTICAL RISER ASSEMBLY CONNECT TO EXISTING 8" SS
4" FL = 1264.16
L = 35' 40"

Note: Risers installed on existing 33 line (Lat. 21, Main 3, SWI 468-76-216-80328 Book D-287)

SEWER SERVICE TABLE

NUMBER	TYPE	LOCATION			FOR INFORMATION ONLY	
		LOT NO.	BLOCK NO.	LINE NO.	APPROXIMATE LENGTH 4" PIPE	
					VERTICAL	HORIZONTAL
25	8" X 4" Tee Saddle	12	4	1	5'	25' 34'
26	8" X 4" Tee Saddle	11	4	1	5'	25' 33'
27	8" X 4" Tee Saddle	10	4	1	5'	25' 33'
28	8" X 4" Tee Saddle	9	4	1	5'	35' 40'
29	8" X 4" Tee Saddle	8	4	1	5'	35' 40'
30	8" X 4" Tee Saddle	7	4	1	5'	35' 40'
31	8" X 4" Tee Saddle	6	4	1	5'	35' 40'
32	8" X 4" Tee Saddle	5	4	1	5'	35' 40'
33	8" X 4" Tee Saddle	4	4	1	5'	35' 40'
34	8" X 4" Tee Saddle	3	4	1	5'	35' 40'
35	8" X 4" Tee Saddle	2	4	1	5'	35' 40'
36	8" X 4" Tee Saddle	1	4	1	5'	35' 40'
37	8" X 4" Tee Saddle	12	3	1	5'	35' 40'

NOTE: Vertical Riser Pipe shall be extended to 2' minimum above ground water elevation and 4' maximum below proposed ground elevation.



Sycamore Pond Addition
SS Line 3
WICHITA, KANSAS

Ruggles & Bohm, P.A.
Engineering, Surveying, Land Planning

924 North Main
Wichita, Kansas 67203
www.rbkansas.com

(316) 264-8008
(316) 264-4621 fax
E-mail: info@rbkansas.com

DESIGN E.JG
DRAWN E.JG
REVIEW
UTILITY

PROJECT NUMBER
SS {SS Line 1 (3)}

DATE
May 25, 2008

SHEET
4
OF
13