

BENCHMARKS:
 BM #1 - "+" on north side of manhole rim ~42' east and 28' south of the intersection of MacArthur & Bluelake St.
 Elev. = 99.97 City Datum

BM #2 - "□" with + cut on northwest face of drop inlet on north side of MacArthur Road, 79.4' North of centerline of MacArthur Road and 152.3' E/SE of southwest corner of Reserve "C", Blue Lake 3rd Addition.
 Elev. = 95.55 City Datum

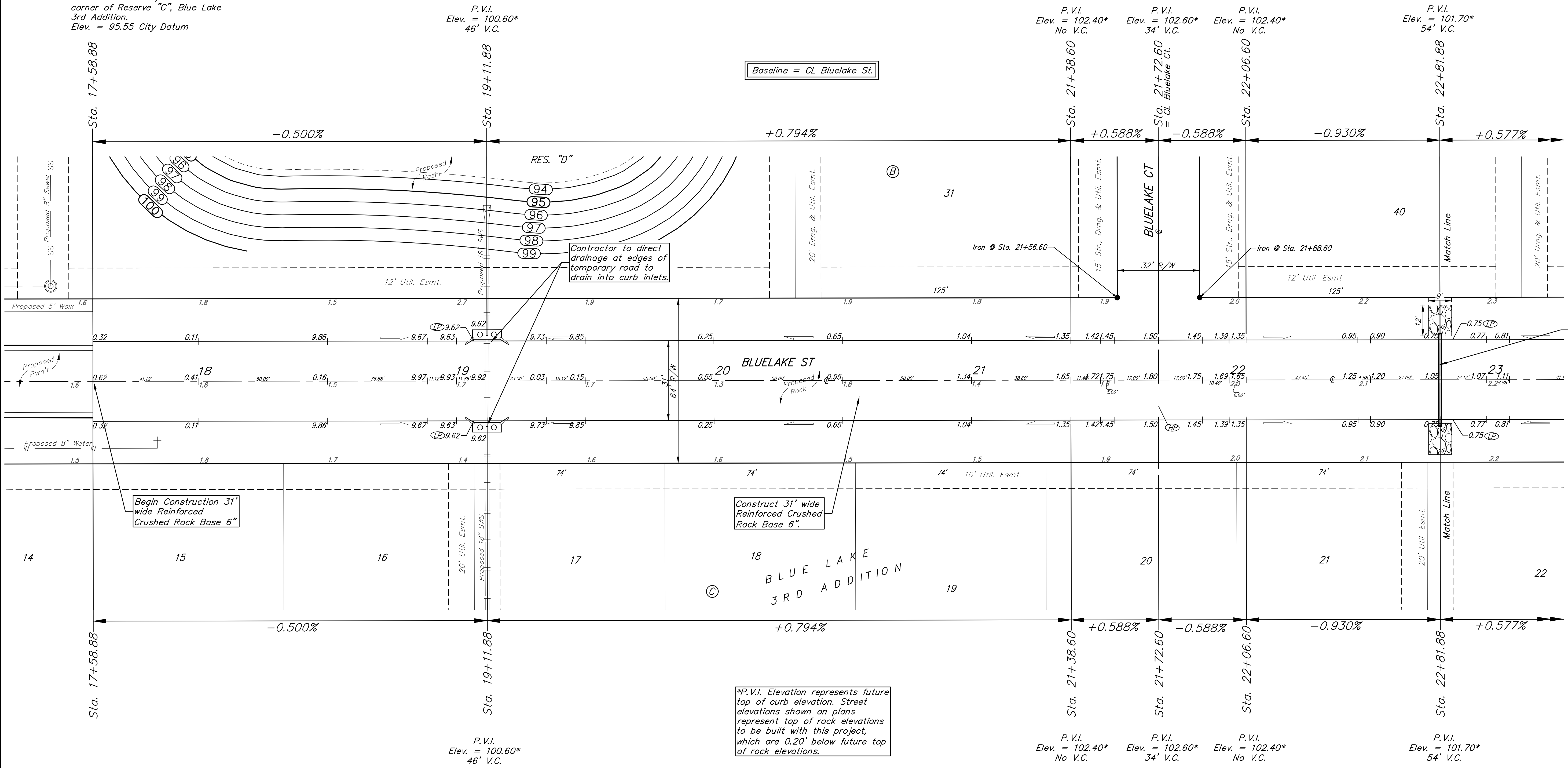
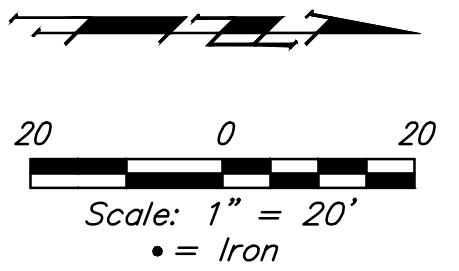

Baseline = CL. Bluelake St.

Contractor to direct drainage at edges of temporary road to drain into curb inlets.

Install 36.0 L.F. 12" PVC
 Install 12.0 S.Y. Rip-rap, Light Stone (both sides).
 Flow W = 99.00
 Flow E = 99.20

Begin Construction 31" wide Reinforced Crushed Rock Base 6"

Construct 31" wide Reinforced Crushed Rock Base 6"

*P.V.I. Elevation represents future top of curb elevation. Street elevations shown on plans represent top of rock elevations to be built with this project, which are 0.20' below future top of rock elevations.

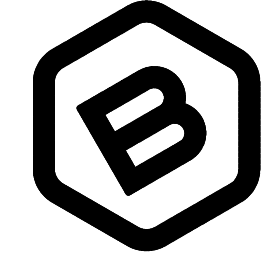
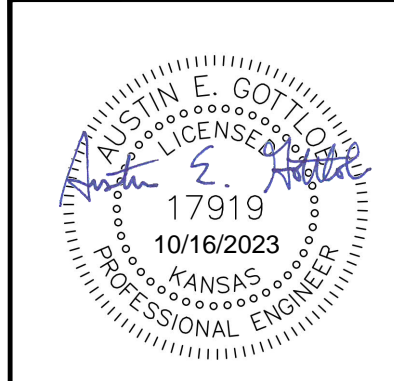

BAUGHMAN COMPANY
 315 Ellis St.
 Wichita, KS 67211
 316-262-7271
 BaughmanCo.com

BLUE LAKE 3RD ADD.
 Phase I

BLUELAKE ST.

STORM WATER DRAIN IMPROVEMENTS

PROJECT NUMBER:
 23-01-E418

DESIGN: AEG DRAWN: TMS

DATE: October 9, 2023

SHEET 4 OF 26

File: E:\Projects\Blue Lake 3rd Addition_22-02-P755\Engineering\Phase 1\SWD 23-01-E418\SWD.dwg