

EROSION CONTROL MEASURE	INSTALL	MAINTAIN	REMOVE
BACK OF CURB PROTECTION (LF)	0	0	0
CONSTRUCTION ENTRANCE (EA)	1	0	0
CURB INLET BARRIER (EA)	0	0	0
DITCH CHECK (EA)	17	0	0
DROP INLET PROTECTION (EA)	3	0	0
EROSION CONTROL (LS)	0	0	0
EROSION CONTROL BERM (LF)	950	0	0
SILT FENCE (LF)	280	0	0
EROSION CONTROL MAT (SY)	6,272	0	0

QUANTITIES ARE FOR INFORMATION ONLY! CONTRACTOR SHALL VERIFY QUANTITIES PER FINAL BID QUANTITY SHEET.

\* ALL EXISTING BMPs INCLUDING CONSTRUCTION ENTRANCE, SEDIMENT BARRIERS, SILT FENCE, EROSION CONTROL BERM, AND EROSION CONTROL MAT SHALL BE MAINTAINED AND REPAIRED IF NECESSARY. REPLACEMENT OR REMOVAL OF EROSION CONTROL MEASURES TO BE PAID FOR BY L.S. BID ITEM "MAINTAIN EXISTING BMPs"

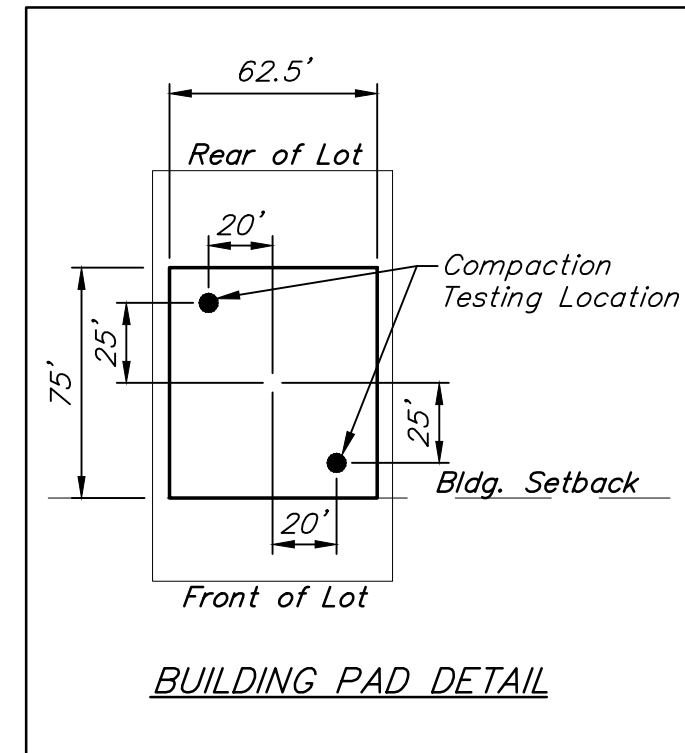

Construct 75' Deep Building Pad on each lot as shown at pad elevations indicated on this plan. Top of best on-site LVC elevations are 8" below slab elevations. (See detail, sheet 14).

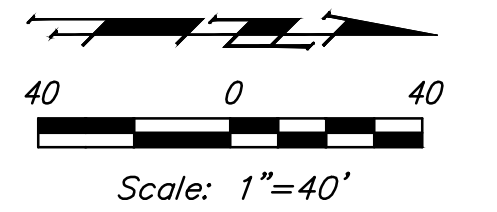
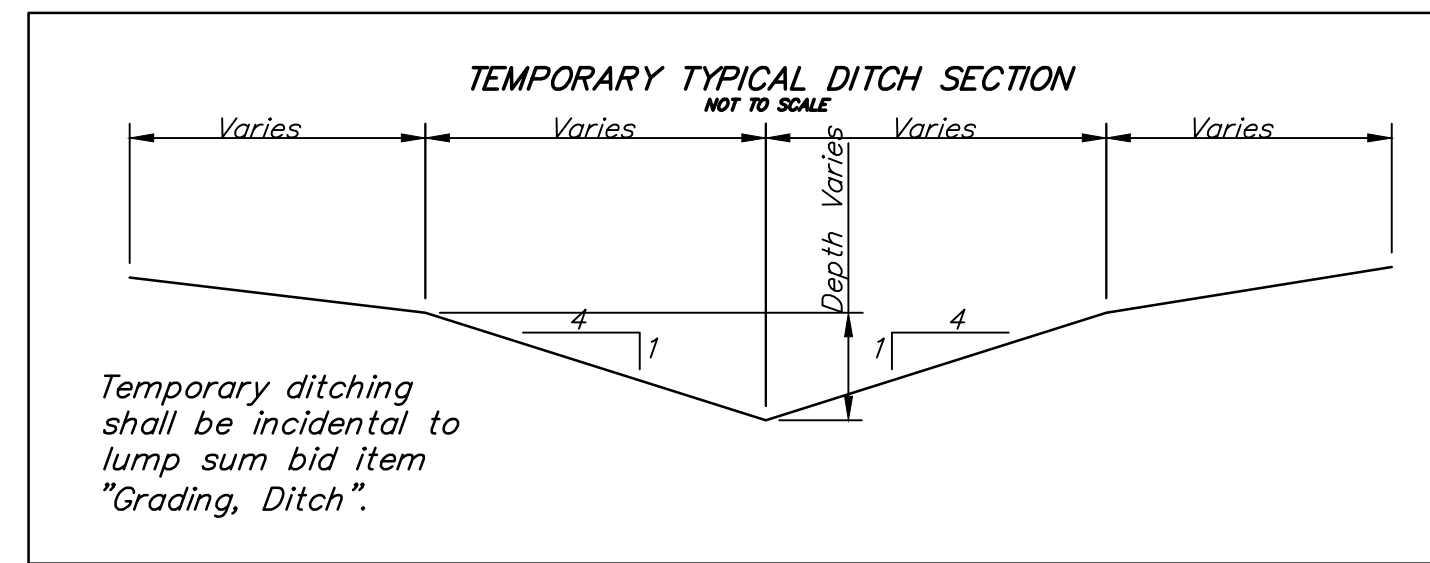

- 100 --- Existing Grade
- 100 --- Proposed Grade
- Area to be graded
- ⊗ - Compaction Testing Location

EARTH WORK TOTALS		
	C.Y. Excavation	C.Y. Compacted Fill
Mass Grading	10,939	35,095
Basin "B" Construction	8,346	0
Basin "D" Construction	22,528	0
<b>Total</b>	<b>41,813</b>	<b>35,095</b>

1. Dirt excavated for temporary ditching is to be stockpiled adjacent to the ditch, to be used for filling in ditch with future phase. All other excess excavation shall remain on-site and shall be stockpiled at a location on-site determined by the developer outside of easements and street R/W. Earthwork fill quantities are unadjusted and are for reference only. Excavation for mass grading and basin construction work to be paid for as C.Y. Excavation. All cost associated with fill & compaction shall be incidental to lump sum bid item "Grading, Mass". It is the goal to achieve earthwork balance on this site. Contact Engineer prior to topsoiling Res. "B" & Res. "D".

2. Contractor to strip top 4-6" of soil within street right-of-way, Res. "B" & "D" & building pad areas before mass grading and stockpile. Topsoil & dirt piles may be spread outside of building pads and proposed pavement prior to seeding.

3. Compaction of 95% Standard Proctor Density shall be obtained in all areas. Fill from on-site excavation shall be placed in 8" maximum thickness lifts within 0% to +2% of optimum moisture content of the soil at the time of placement. All testing shall be incidental to Lump Sum bid item "Testing".

4. It shall be the Contractor's responsibility to protect existing utilities during mass grading. Any damage done to these systems by Contractor or subcontractor shall be repaired at no additional cost to the project.

5. All areas disturbed during construction (except building pads) shall be seeded as per Cover Sheet General Notes. The approximate seeding area is 30.0 acres.

6. Building pads will be filled up to 8" below slab elevation per detail, sheet 14. The pads shall be made with best on-site LVC material. The pads shall be compacted and moisture tested in fill areas every 12" in fill height. See table on sheet 9 for locations and elevations for testing.

7. Street elevations shown on mass grading plan are top of rock (bottom of asphalt) at centerline. The exception to this is Bluelake St. from Sta. 17+58 to the north property line, which shall be graded to 0.2' below bottom of rock.

8. Only trees within the street R/W or Res. "B" & "D" may be removed if necessary for grading. All other trees shall be trimmed/removed ONLY with approval of the Developer. Trimming will be permitted only with chainsaws. Trees not in direct conflict with proposed new construction shall remain and be protected from damage. All trimming or removal shall be included in bid item "Site Clearing". Prior to construction, an on-site meeting with the developer will be held to discuss grading limits and tree trimming/clearing.

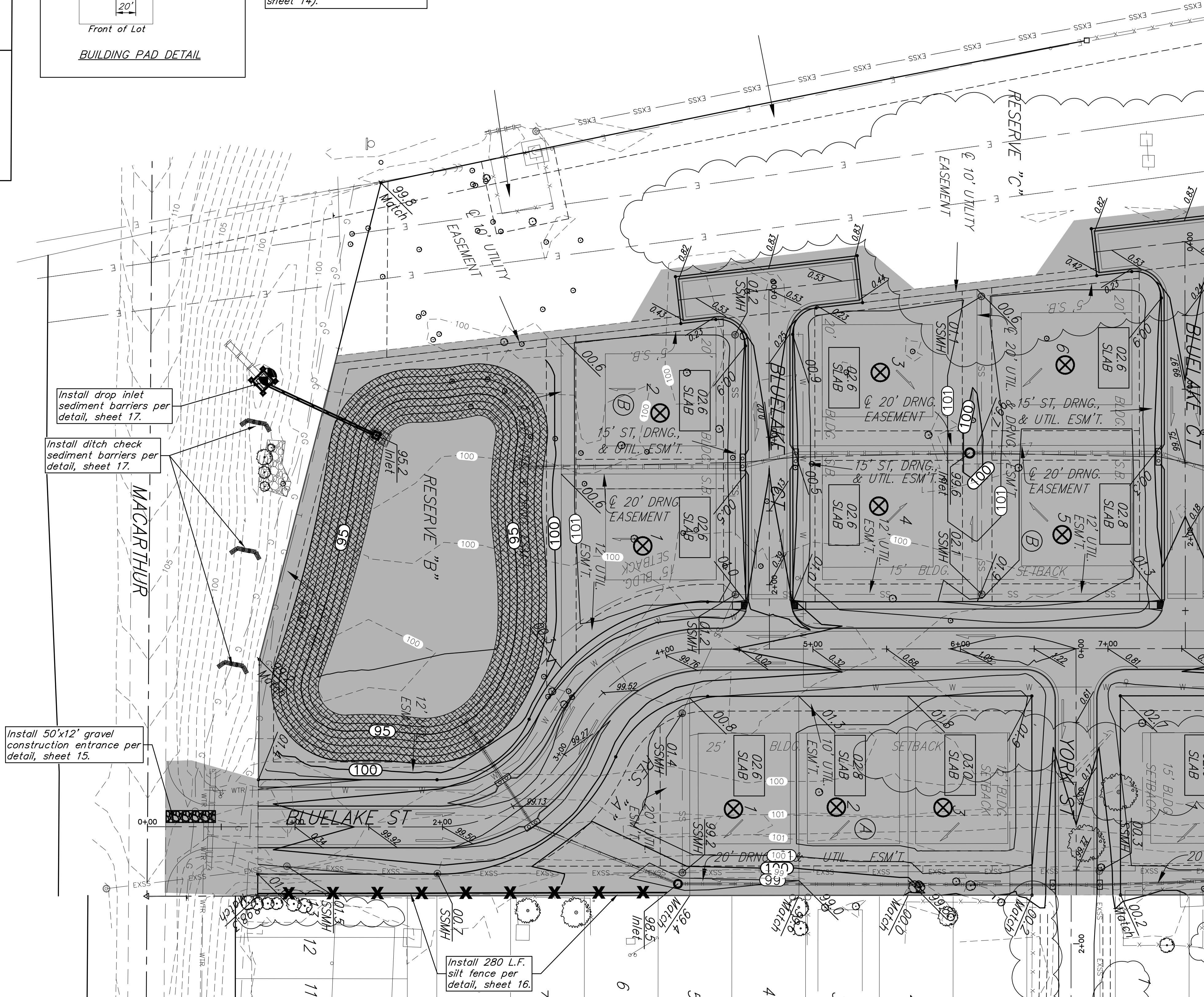

- EROSION CONTROL PLAN LEGEND**
- - DROP INLET PROTECTION
  - - CURB INLET PROTECTION
  - ┌┐ - DITCH CHECKS
  - ✕ - SILT FENCING
  - ~ - STRAW WATTLE DITCH CHECKS
  - ~ - EROSION CONTROL BERM
  - ▨ - BACK OF CURB PROTECTION
  - ▩ - EROSION CONTROL MAT
  - - TEMPORARY DITCH

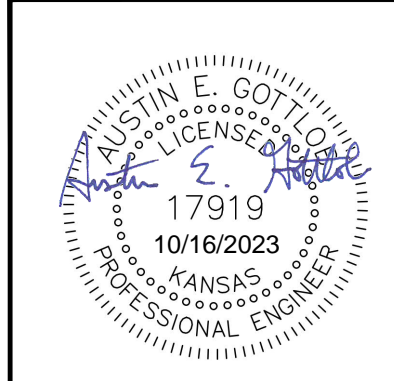

**BAUGHMAN COMPANY**  
 315 Ellis St.  
 Wichita, KS 67211  
 316-262-7271  
 BaughmanCo.com

BLUE LAKE 3RD ADD.  
 Phase I

**MASS GRADING PLAN**

STORM WATER DRAIN IMPROVEMENTS

PROJECT NUMBER:  
 23-01-E418

DESIGN: DRAWN:  
 DATE: October 13, 2023

SHEET **6** OF **26**

File: E:\Projects\Blue Lake 3rd Add\Engineering\Phase 1\SWD 23-01-E418\SWD.dwg