

STATE	PROJECT NO.	YEAR	SHEET NO.	TOTAL SHEETS
KANSAS	87 N-0720-01	2023	1	517

F.A. NO. STP-N072(001)
 KDOT PROJ. NO. 87 N-0720-01

STATE OF KANSAS
 DEPARTMENT OF TRANSPORTATION
 PLAN AND PROFILE OF PROPOSED
**WEST STREET IMPROVEMENTS
 FROM PAWNEE TO HARRY**

FEDERAL AID PROJECT
 SEDGWICK COUNTY
 CITY OF WICHITA
 C.O.W. PROJ. NO. 472-85433
 MUNIS NO. E8049 ORG CODE 40103918
 WATERLINE PROJ. NO. 448-90907
 MUNIS NO. W8018 ORG CODE 54250321

- GRADING
- CONCRETE PAVEMENT
- ASPHALT PAVEMENT
- STORM SEWER
- PAVEMENT MARKING
- SIGNING
- TRAFFIC SIGNALIZATION
- SEEDING/SODDING

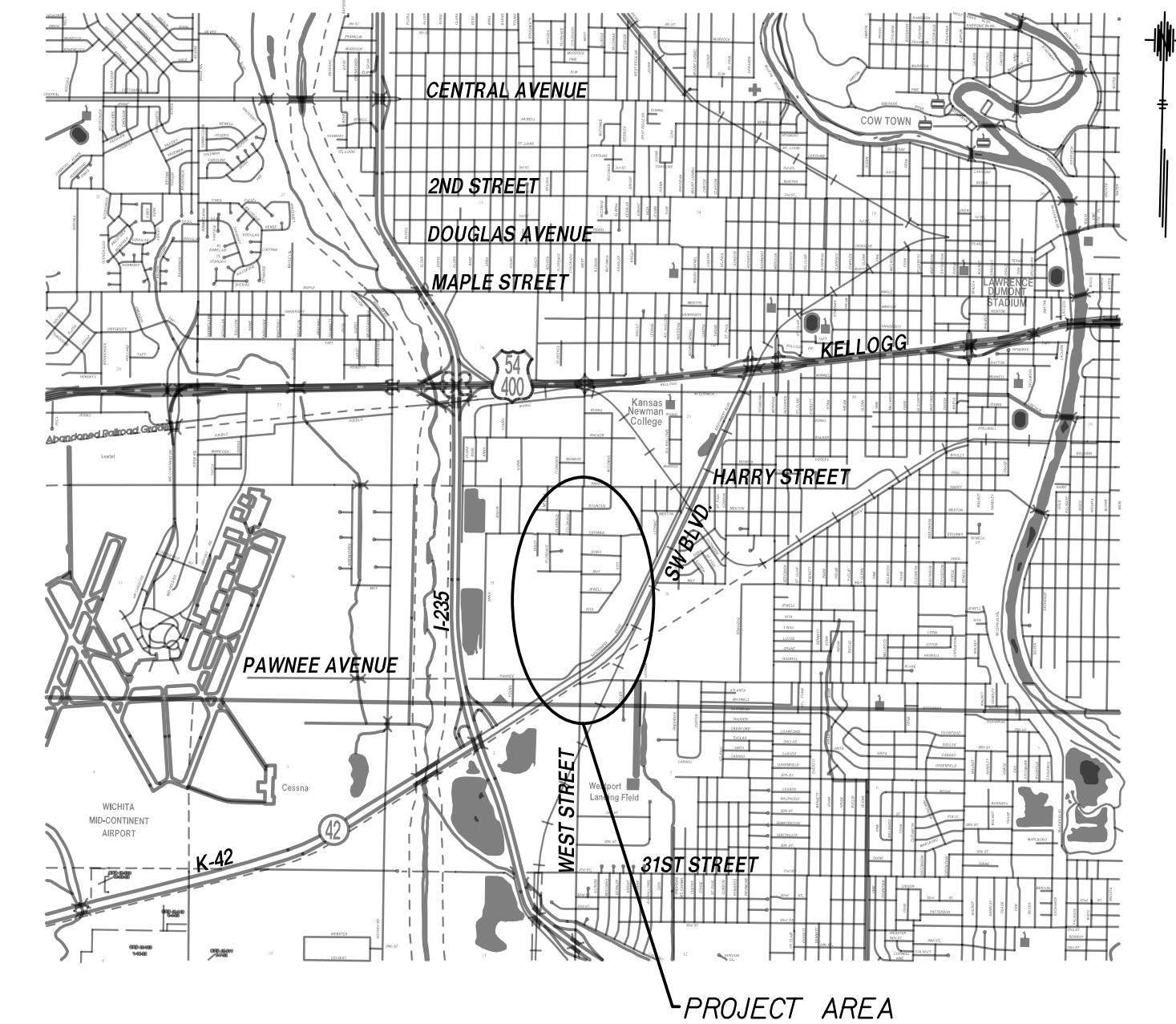

LOCATION MAP

TRAFFIC SHALL BE CARRIED THROUGH CONSTRUCTION ON EXISTING ALIGNMENTS.
 EXISTING ALIGNMENTS ARE TO BE SIGNED AND MAINTAINED BY THE CONTRACTOR.



RECOM. FOR APPROVAL-DATE

Paul Gunzelman
 PAUL GUNZELMAN, P.E.
 INTERIM CITY ENGINEER
 CITY OF WICHITA

PREPARED BY:
TRANSYSTEMS
 245 N. WACO, SUITE 222
 WICHITA, KANSAS 67202
 MAIN: 316-303-3000
 FAX: 316-462-5629

INDEX OF SHEETS

1	Title Sheet
2	General Notes
3 - 7	Coordinate & Geometric Data
8 - 12	Typical Sections
13 - 23	Plan Sheets - West Street
24 - 29	Plan Sheets - Pawnee Avenue
30 - 31	Plan Sheets - SW Blvd.
32 - 36	Art Detail Sheets
37 - 40	Intersection Curb Return Details
41 - 51	Storm Sewer Plan West Street
52 - 57	Storm Sewer Plan Pawnee Avenue
58	Storm Sewer Plan Southwest Blvd.
59 - 70	Storm Sewer Profile West Street
71 - 76	Storm Sewer Profile Pawnee Avenue
77 - 78	Schedule of Storm Sewer
79 - 87	Inlet Standards
88 - 90	Manhole Details
91 - 93	Drainage Details
94 - 119	Joining Plan Sheets
120 - 121	Driveway Details
122	Wheelchair Ramp Details
123	Curb & Gutter Details
124	Median Nose Details
125 - 128	Concrete Pavement Details
129 - 130	Retaining Wall Details
131	Seeding/Sod Details
132 - 135	Erosion Control Details
136 - 137	Summary of Quantities
138	Dirt Stockpile Site
139	Tree Removal (Stockpile Area)
140 - 266	Construction Phasing Plans
267	Traffic Control Standards
274 - 284	Pavement Marking & Signing Plans - West Street
285 - 290	Pavement Marking & Signing Plans - Pawnee Street
291 - 292	Pavement Marking & Signing Plans - SW Blvd.
293 - 301	Pavement Marking & Signing Details
302	Traffic Signal General Notes
303 - 305	Traffic Signal Plans West St. & Pawnee Ave.
306 - 308	Traffic Signal Plans Southwest Blvd. & Pawnee Ave.
309 - 319	Traffic Signal Details
320 - 334	Communication Duct Bank Plan
335 - 354	ITS Standards & Specifications
355 - 356	Sanitary Sewer Standard Details
357	Waterline Cover Sheet
358 - 361	Waterline Coordinate Control Data
362 - 373	Waterline Plan Sheets West Street
374 - 384	Waterline Profile Sheets West Street
385 - 389	Waterline Plan Sheets Pawnee Avenue
390 - 392	Waterline Profile Sheets Pawnee Avenue
393 - 396	Waterline Standards
397 - 470	Cross Sections: West Street
471 - 505	Cross Sections: Pawnee Avenue
506 - 517	Cross Sections: SW Blvd.

DATE	BY	SURVEY	CADD TECHNICIAN	DESIGNERS	SQUAD

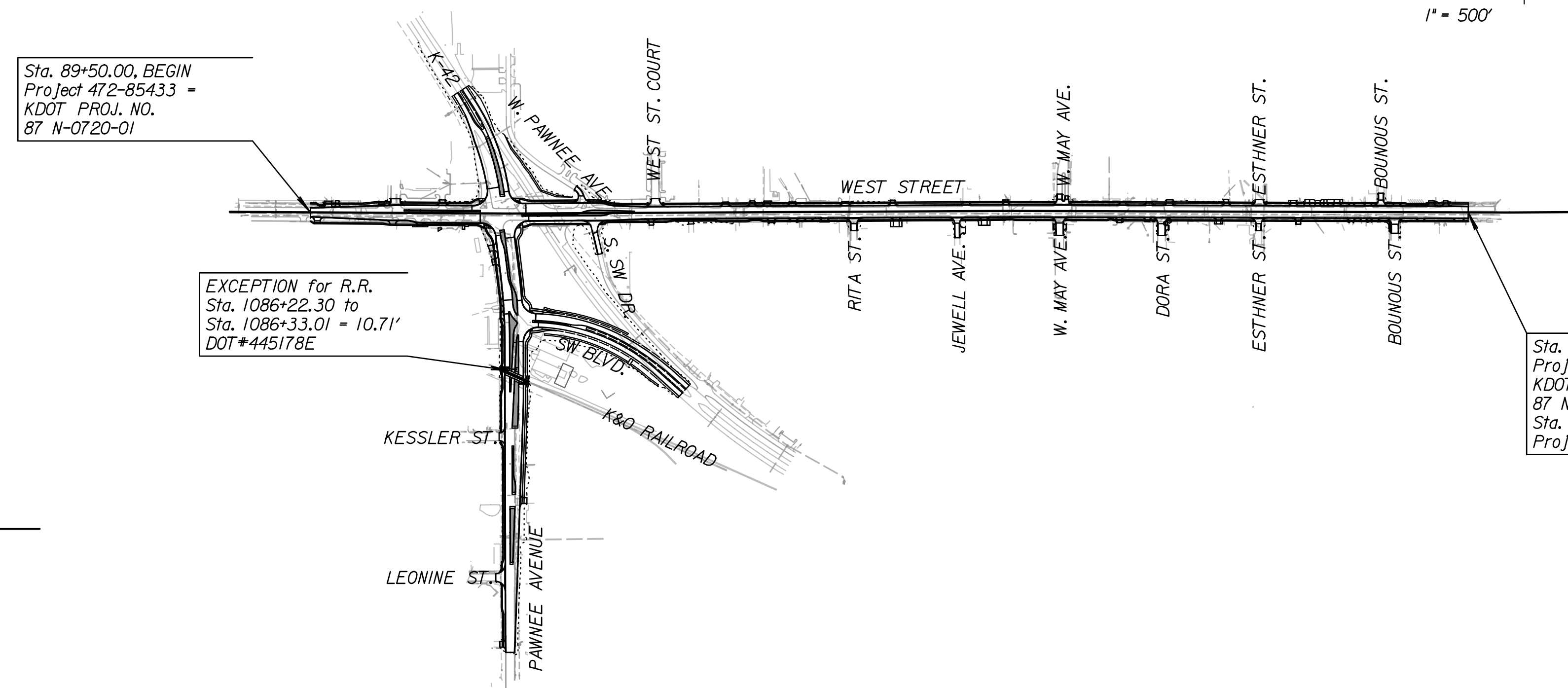

Sta. 89+50.00, BEGIN
 Project 472-85433 -
 KDOT PROJ. NO.
 87 N-0720-01

EXCEPTION for R.R.
 Sta. 1086+22.30 to
 Sta. 1086+33.01 = 10.71'
 DOT#445178E

Sta. 150+63.39, END
 Project 472-85433 -
 KDOT PROJ. NO.
 87 N-0720-01 =
 Sta. 19+38.28
 Project 472-85296

DESIGN DESIGNATION

AADT (2018) WEST ST.	=	10,435
AADT (2018) PAWNEE ST.	=	8,637
AADT (2018) SW BLVD.	=	5,511
AADT (2040) WEST ST.	=	20,090
AADT (2040) PAWNEE ST.	=	30,150
AADT (2040) SW BLVD.	=	14,070
V	=	40 MPH
C of A	=	NONE
LATERAL OFFSET	=	6.0 FT
SW BLVD. CLEARZONE	=	14.0 FT - 16.0 FT

CONVENTIONAL SIGNS

COUNTY LINE	=====	CENTER LINE OF PROJECT	----- 50 -----
CITY LIMITS	//////	TERRACE	-----
STATE OR NATIONAL LINE	=====	CULVERTS	-----
TOWNSHIP, SECTION or GRANT LINE	-----	DROP INLET & STORM SEWER	-----
PROPERTY LINE	-----	ACCESS CONTROL	-----
HIGHWAY FENCE	-----	POWER POLE	-----
EXISTING FENCE	-----	TELEPHONE POLE	-----
GUARDRAIL	-----	MARSH	-----
CONSTRUCTION LIMITS	-----	HEDGE	-----
RIGHT OF WAY LINE	-----	TREES	-----
TRAVELED WAY	-----	PROFILE ELEVATION	-----
RAILROADS	-----	STREAM or CREEK	-----

GROSS LENGTH OF PROJECT	6,113.39 FT.
EXCEPTIONS	0.0 FT.

NET LENGTH OF PROJECT	6,113.39 FT.	1.16 MILES
NET LENGTH OF BRIDGES	0.00 FT.	0.00 MILES
NET LENGTH OF ROAD	6,113.39 FT.	1.16 MILES