

CONSULTANTS:

WEST STREET IMPROVEMENTS FROM PAWNEE TO HARRY

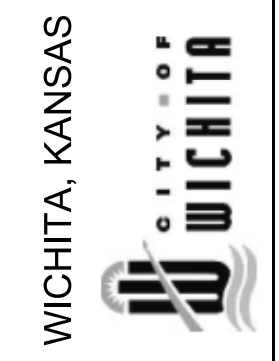

| REVISIONS: | DESCRIPTION | MARK | DATE |
|------------|-------------|------|------|
| | | | |
| | | | |
| | | | |
| | | | |

| | |
|--|----|
| PROJ NO: 87 N-0720-01 | |
| SCALE: 1"=20' | |
| DATE: 9/25/2023 | |
| DESIGNED BY: CKC | |
| DRAWN BY: CKC | |
| CHECKED BY: MDB | |
| SHEET TITLE: | |
| WEST STREET PLAN & PROFILE STA. 97+25.00 TO STA. 103+25.00 | |
| SHEET NO. | 15 |
| SHEET 15 OF 517 | |

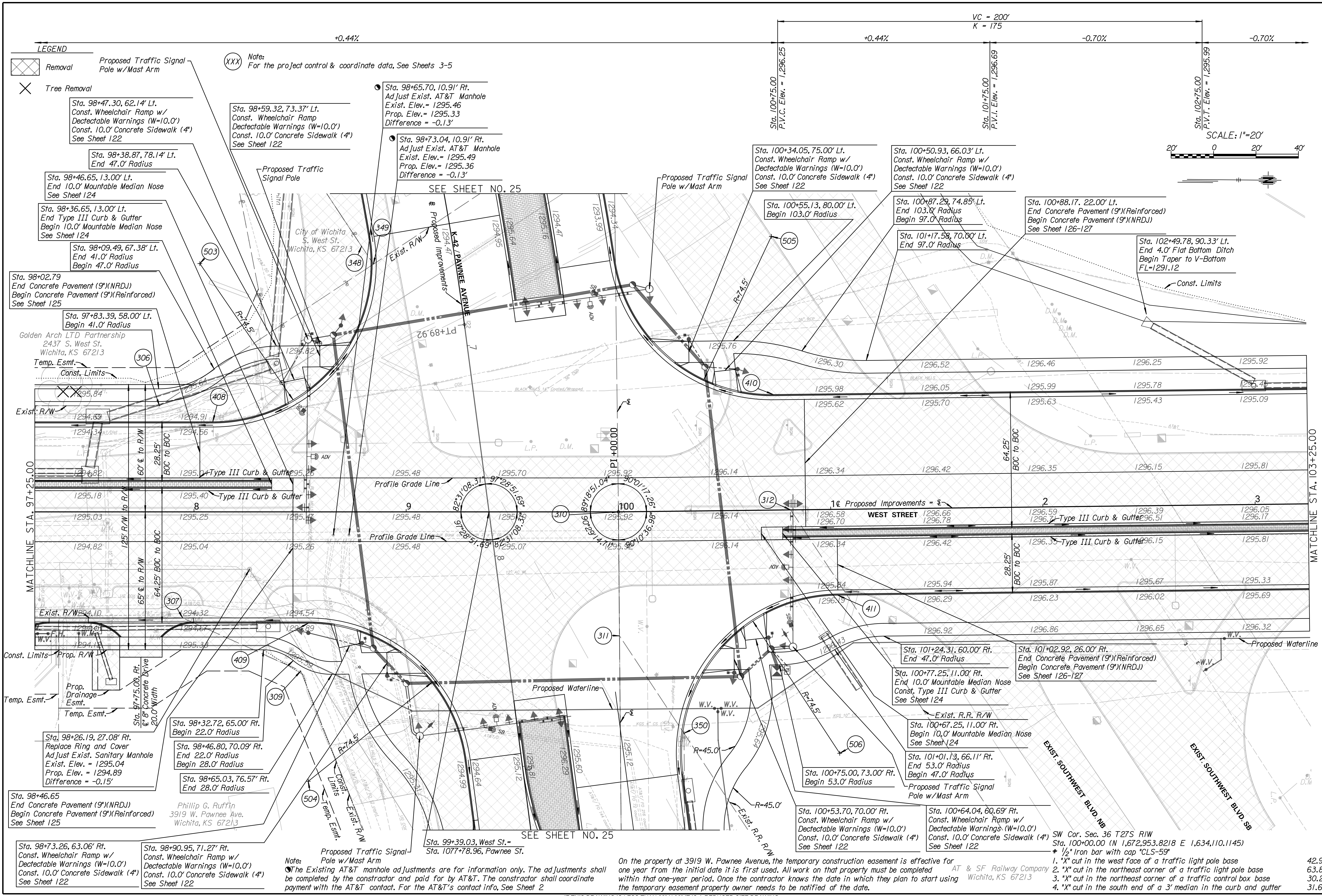

9/25/2023 3:18:01 PM - c:\transystems\work_local\transystems\proj\1a-w_1\kansas\0884549\C-RD-W-101-103.DGN
 I:\work\9/25/2023

Note:
 The Existing AT&T manhole adjustments are for information only. The adjustments shall be completed by the contractor and paid for by AT&T. The contractor shall coordinate payment with the AT&T contact. For the AT&T's contact info, See Sheet 2

On the property at 3919 W. Pawnee Avenue, the temporary construction easement is effective for one year from the initial date it is first used. All work on that property must be completed within that one-year period. Once the contractor knows the date in which they plan to start using the temporary easement property owner needs to be notified of the date.

- AT & SF Railway Company
 Wichita, KS 67213
- *X cut in the west face of a traffic light pole base
 - *X cut in the northeast corner of a traffic light pole base
 - *X cut in the northeast corner of a traffic control box base
 - *X cut in the south end of a 3' median in the curb and gutter