

LEGEND

Removal

Tree Removal

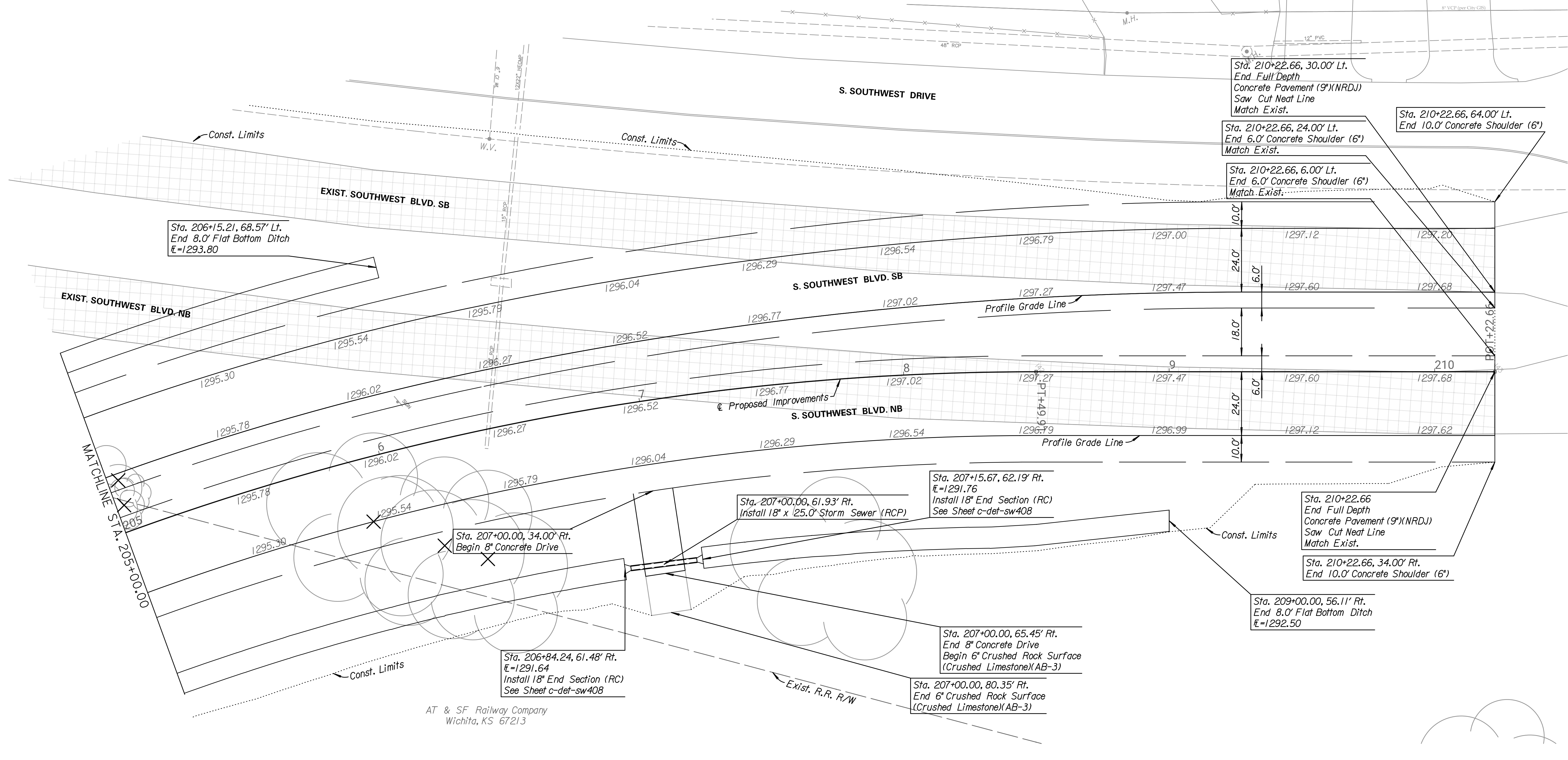
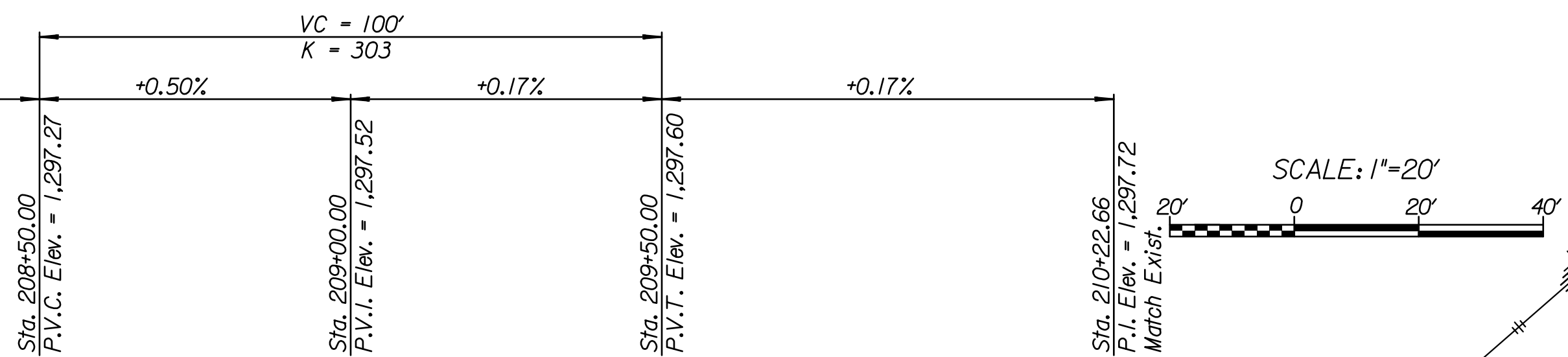

Sta. 206+15.21, 68.57' Lt.
End 8.0' Flat Bottom Ditch
Elev. = 1293.80

Sta. 207+00.00, 34.00' Rt.
Begin 8' Concrete Drive

Sta. 207+00.00, 61.93' Rt.
Install 18" x 25.0' Storm Sewer (RCP)

Sta. 206+84.24, 61.48' Rt.
Elev. = 1291.64
Install 18" End Section (RC)
See Sheet c-det-sw408

Sta. 207+00.00, 65.45' Rt.
End 8' Concrete Drive
Begin 6' Crushed Rock Surface
(Crushed Limestone)(AB-3)

Sta. 207+00.00, 80.35' Rt.
End 6' Crushed Rock Surface
(Crushed Limestone)(AB-3)

Sta. 210+22.66, 30.00' Lt.
End Full Depth
Concrete Pavement (9')(NRDJ)
Saw Cut Neat Line
Match Exist.

Sta. 210+22.66, 24.00' Lt.
End 6.0' Concrete Shoulder (6')
Match Exist.

Sta. 210+22.66, 6.00' Lt.
End 6.0' Concrete Shoulder (6')
Match Exist.

Sta. 210+22.66, 64.00' Lt.
End 10.0' Concrete Shoulder (6')

Sta. 210+22.66
End Full Depth
Concrete Pavement (9')(NRDJ)
Saw Cut Neat Line
Match Exist.

Sta. 210+22.66, 34.00' Rt.
End 10.0' Concrete Shoulder (6')

Sta. 209+00.00, 56.11' Rt.
End 8.0' Flat Bottom Ditch
Elev. = 1292.50

BM #205
"X" cut in the north corner of a storm water area inlet on NW side of southwest drive located in front of 2225 S. Southwest Blvd.
N 1,674,151.8303
E 1,635,098.8728
Sta. 210+22.66, 135.25' Lt. Elev. = 1295.10

TRANSYSTEMS

245 N. WACO
SUITE 222
WICHITA, KANSAS 67202
MAIN: 316-303-3000
FAX: 316-462-5629

CONSULTANTS:

WEST STREET IMPROVEMENTS
FROM PAWNEE TO HARRY

WICHITA, KANSAS

REVISIONS:	MARK	DATE	DESCRIPTION

PROJ NO: 87 N-0720-01
SCALE: 1"=20'
DATE: 9/25/2023
DESIGNED BY: CKC
DRAWN BY: CKC
CHECKED BY: MDB

SHEET TITLE:
**SOUTHWEST BLVD.
PLAN & PROFILE
STA. 205+00.00 TO
STA. 210+22.66**

SHEET NO.
31

SHEET 31 OF 517

9/25/2023 8:21:11 PM - c:\transystems\proj\local\transystems\proj\la_w\proj\87n0720\87n0720-01.dgn