

CONSULTANTS:

WEST STREET IMPROVEMENTS
 FROM PAWNEE TO HARRY



REVISIONS:	MARK	DATE	DESCRIPTION

PROJ NO: 87 N-0720-01
 SCALE: 1"=20'
 DATE: 9/25/2023
 DESIGNED BY: SSP
 DRAWN BY: LCV
 CHECKED BY: MDB

SHEET TITLE:
**PAWNEE AVE.
 COMM. SUCT BANK
 PLAN LAYOUT
 STA. 1075+40.00 TO
 STA. 1081+40.00**

SHEET NO.
333
 SHEET 333 OF 517

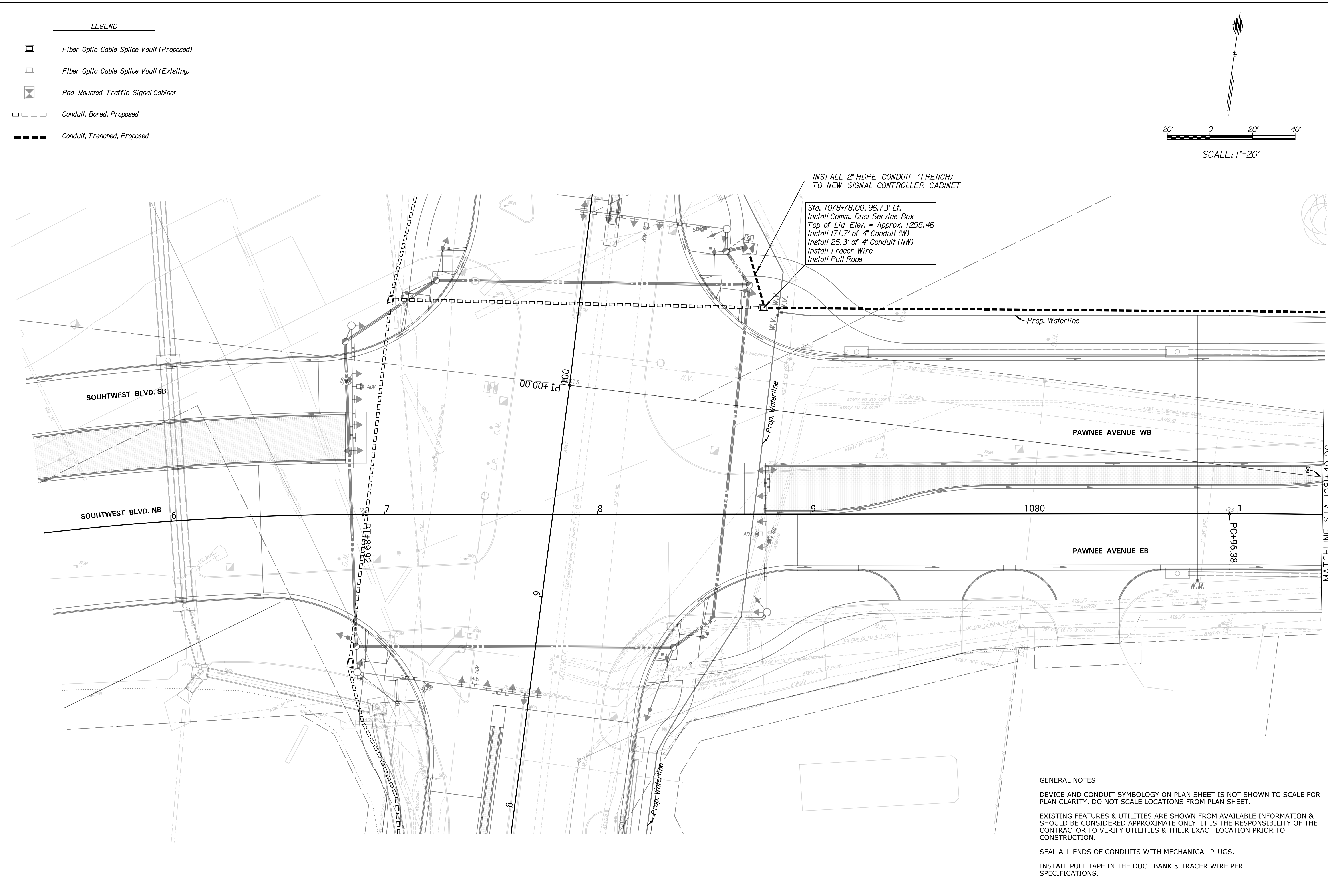
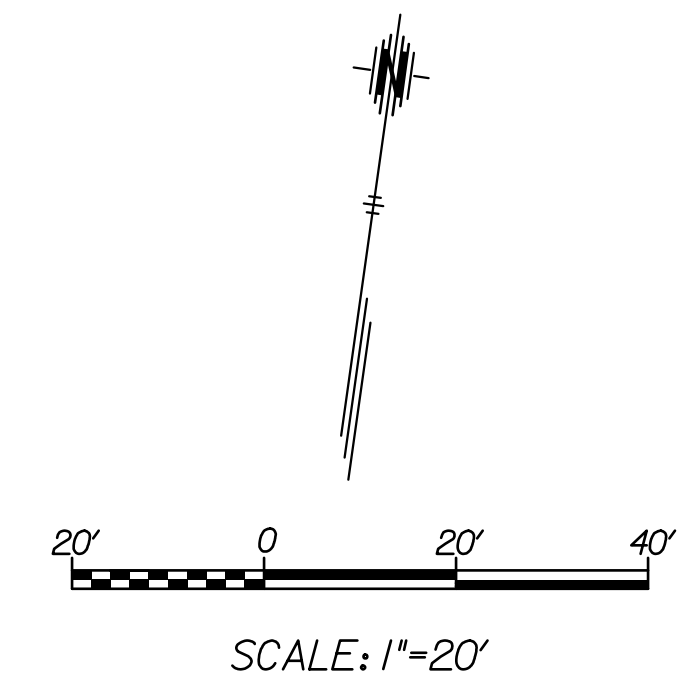

GENERAL NOTES:
 DEVICE AND CONDUIT SYMBOLY ON PLAN SHEET IS NOT SHOWN TO SCALE FOR PLAN CLARITY. DO NOT SCALE LOCATIONS FROM PLAN SHEET.
 EXISTING FEATURES & UTILITIES ARE SHOWN FROM AVAILABLE INFORMATION & SHOULD BE CONSIDERED APPROXIMATE ONLY. IT IS THE RESPONSIBILITY OF THE CONTRACTOR TO VERIFY UTILITIES & THEIR EXACT LOCATION PRIOR TO CONSTRUCTION.
 SEAL ALL ENDS OF CONDUITS WITH MECHANICAL PLUGS.
 INSTALL PULL TAPE IN THE DUCT BANK & TRACER WIRE PER SPECIFICATIONS.