

CONSULTANTS:

WEST STREET IMPROVEMENTS
 FROM PAWNEE TO HARRY



REVISIONS:	DESCRIPTION	DATE	MARK

PROJ NO: 87 N-0720-01
 SCALE: 1"=20'
 DATE: 9/25/2023
 DESIGNED BY: MLC
 DRAWN BY: LCV
 CHECKED BY: MDB

SHEET TITLE:
WEST STREET STORM SEWER IMPROVEMENTS

SHEET NO.
42
 SHEET 42 OF 517

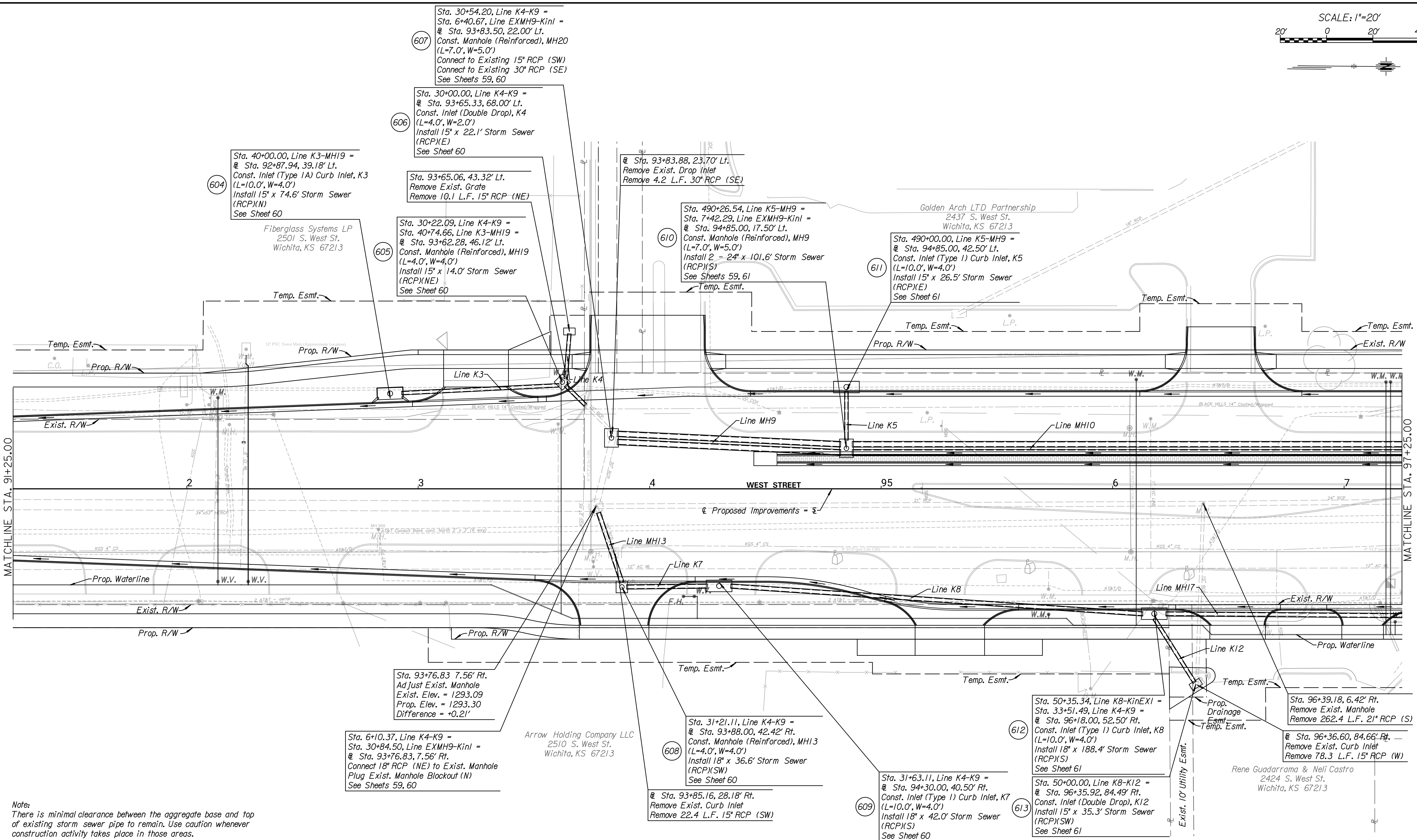

Note:
 There is minimal clearance between the aggregate base and top of existing storm sewer pipe to remain. Use caution whenever construction activity takes place in those areas.

The Contractor shall coordinate with the utility companies to locate any existing utilities that have not been previously located.

Any storm sewer adjacent to the curb & gutter or under any proposed pavement on mainline, side roads or entrances shall be backfilled in accordance with the City of Wichita Specifications unless otherwise noted on the plans or by the Engineer.

The space between the Type 2 Special inlets shall be filled with Flowable Fill. The Flowable Fill shall be considered SUBSIDIARY to the inlets.

Arrow Holding Company LLC
 2510 S. West St.
 Wichita, KS 67213

Rene Guadarrama & Neli Castro
 2424 S. West St.
 Wichita, KS 67213

9/25/2023 8:21:39 PM - c:\transystems\proj\local\transystems\proj\1a-w_1\kwh\10084549\C-SPR-W01-102.DGN