

9/25/2023 8:21:43 PM - c:\transystems\proj\local\transystems\proj\1a-w\_knoh\0984549-C-SPR-W01-103.DGN

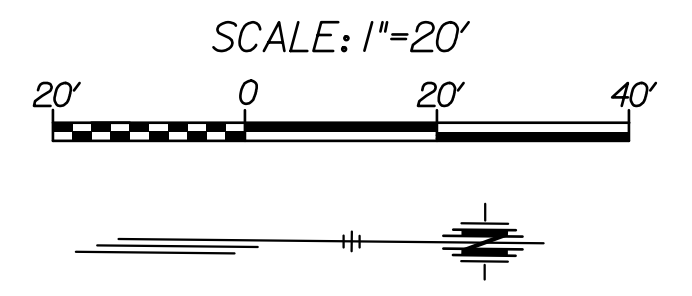
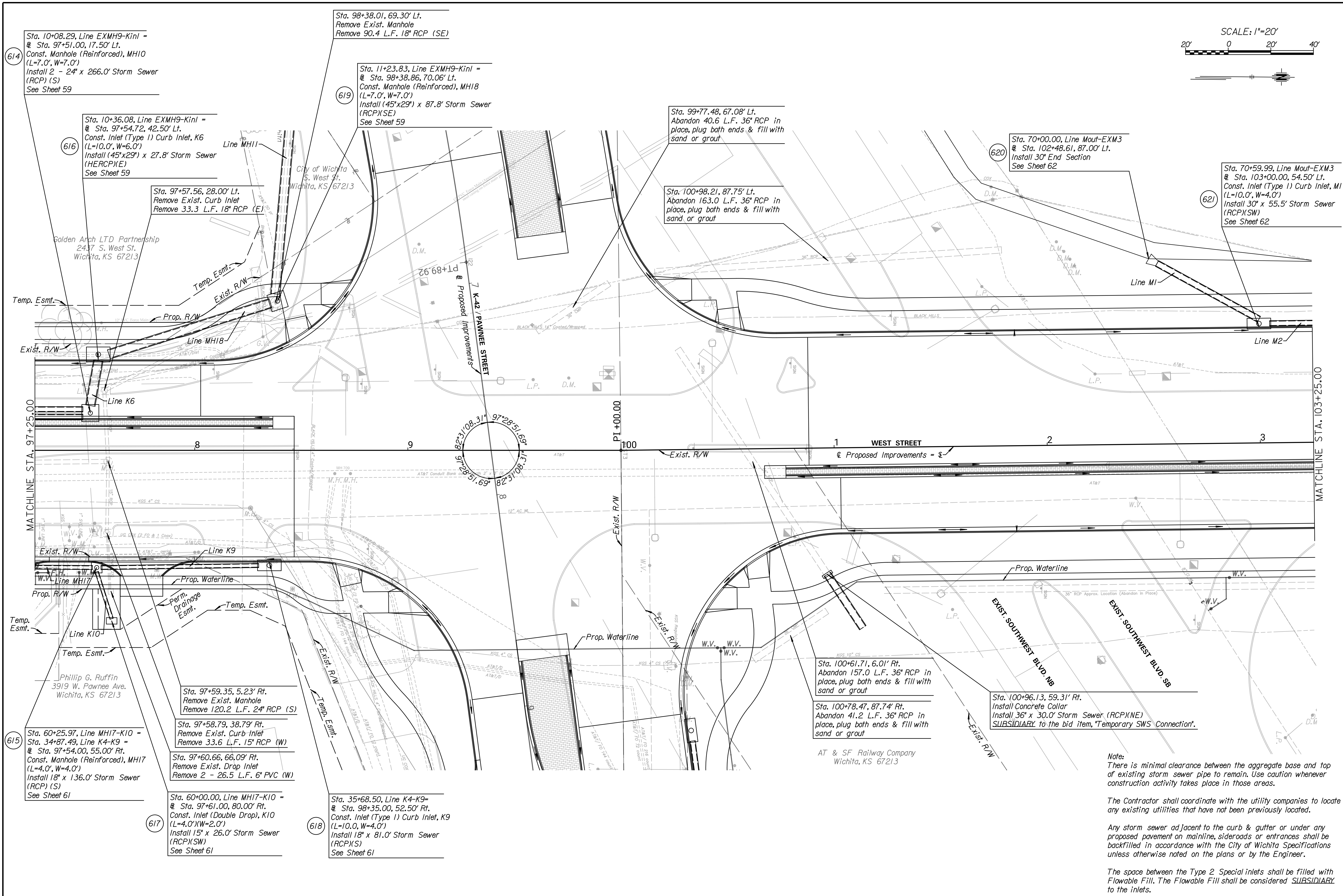

**TRANSYSTEMS**  
245 N. WACO  
SUITE 222  
WICHITA, KANSAS 67202  
MAIN: 316-303-3000  
FAX: 316-462-5629

CONSULTANTS:

WEST STREET IMPROVEMENTS  
FROM PAWNEE TO HARRY



REVISIONS:	MARK	DATE	DESCRIPTION

PROJ NO: 87 N-0720-01  
SCALE: 1"=20'  
DATE: 9/25/2023  
DESIGNED BY: MLC  
DRAWN BY: LCV  
CHECKED BY: MDB

SHEET TITLE:  
**WEST STREET  
STORM SEWER  
IMPROVEMENTS**

SHEET NO.  
**43**  
SHEET 43 OF 517

Note:  
There is minimal clearance between the aggregate base and top of existing storm sewer pipe to remain. Use caution whenever construction activity takes place in those areas.

The Contractor shall coordinate with the utility companies to locate any existing utilities that have not been previously located.

Any storm sewer adjacent to the curb & gutter or under any proposed pavement on mainline, sideroads or entrances shall be backfilled in accordance with the City of Wichita Specifications unless otherwise noted on the plans or by the Engineer.

The space between the Type 2 Special inlets shall be filled with Flowable Fill. The Flowable Fill shall be considered SUBSIDIARY to the inlets.

Sta. 100+61.71, 6.01' Rt.  
Abandon 157.0 L.F. 36" RCP in place, plug both ends & fill with sand or grout

Sta. 100+78.47, 87.74' Rt.  
Abandon 41.2 L.F. 36" RCP in place, plug both ends & fill with sand or grout

AT & SF Railway Company  
Wichita, KS 67213

Sta. 100+96.13, 59.31' Rt.  
Install Concrete Collar  
Install 36" x 30.0' Storm Sewer (RCP)(NE)  
SUBSIDIARY to the bid item, "Temporary SWS Connection".

Sta. 97+59.35, 5.23' Rt.  
Remove Exist. Manhole  
Remove 120.2 L.F. 24" RCP (S)

Sta. 97+58.79, 38.79' Rt.  
Remove Exist. Curb Inlet  
Remove 33.6 L.F. 15" RCP (W)

Sta. 97+60.66, 66.09' Rt.  
Remove Exist. Drop Inlet  
Remove 2 - 26.5 L.F. 6" PVC (W)

Sta. 60+00.00, Line M17-K10 =  
Sta. 97+61.00, 80.00' Rt.  
Const. Inlet (Double Drop), K10  
(L=4.0', W=2.0')  
Install 15" x 26.0' Storm Sewer (RCP)(SW)  
See Sheet 61

Sta. 35+68.50, Line K4-K9 =  
Sta. 98+35.00, 52.50' Rt.  
Const. Inlet (Type I) Curb Inlet, K9  
(L=10.0', W=4.0')  
Install 18" x 81.0' Storm Sewer (RCP)(S)  
See Sheet 61

Sta. 10+08.29, Line EXMH9-Kin1 =  
Sta. 97+51.00, 17.50' Lt.  
Const. Manhole (Reinforced), MH10  
(L=7.0', W=7.0')  
Install 2 - 24" x 266.0' Storm Sewer (RCP) (S)  
See Sheet 59

Sta. 98+38.01, 69.30' Lt.  
Remove Exist. Manhole  
Remove 90.4 L.F. 18" RCP (SE)

Sta. 11+23.83, Line EXMH9-Kin1 =  
Sta. 98+38.86, 70.06' Lt.  
Const. Manhole (Reinforced), MH18  
(L=7.0', W=7.0')  
Install (45"x29") x 87.8' Storm Sewer (RCP)(SE)  
See Sheet 59

Sta. 99+77.48, 67.08' Lt.  
Abandon 40.6 L.F. 36" RCP in place, plug both ends & fill with sand or grout

Sta. 100+98.21, 87.75' Lt.  
Abandon 163.0 L.F. 36" RCP in place, plug both ends & fill with sand or grout

Sta. 70+00.00, Line Mout-EXM3  
Sta. 102+48.61, 87.00' Lt.  
Install 30" End Section  
See Sheet 62

Sta. 70+59.99, Line Mout-EXM3  
Sta. 103+00.00, 54.50' Lt.  
Const. Inlet (Type I) Curb Inlet, M1  
(L=10.0', W=4.0')  
Install 30" x 55.5' Storm Sewer (RCP)(SW)  
See Sheet 62