

CONSULTANTS:

WEST STREET IMPROVEMENTS
 FROM PAWNEE TO HARRY

REVISIONS:	DESCRIPTION	DATE	MARK

PROJ NO: 87 N-0720-01
 SCALE: 1"=20'
 DATE: 9/25/2023
 DESIGNED BY: MLC
 DRAWN BY: LCV
 CHECKED BY: MDB

SHEET TITLE:
WEST STREET STORM SEWER IMPROVEMENTS

SHEET NO.
47

SHEET 47 OF 517

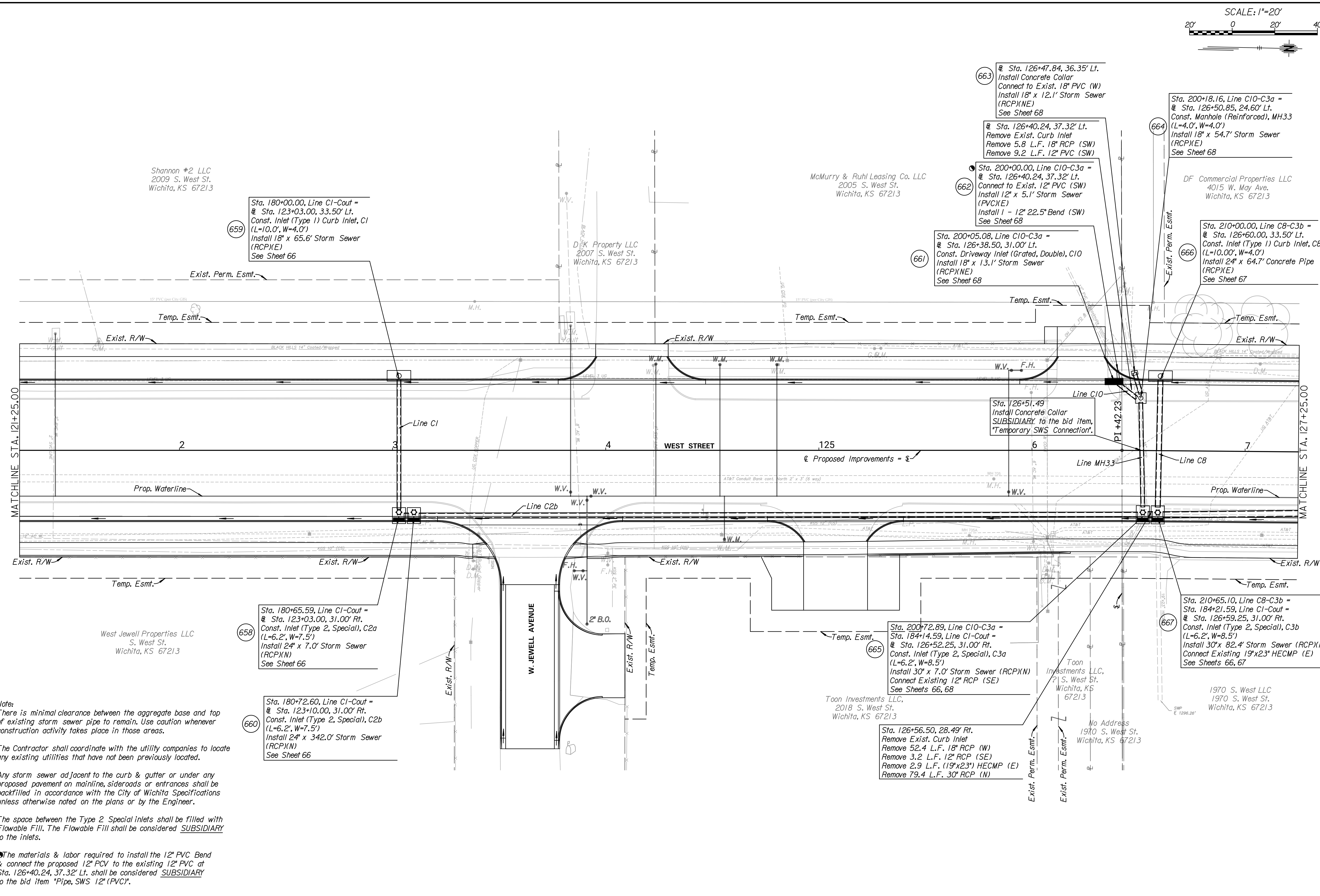

Shannon #2 LLC
 2009 S. West St.
 Wichita, KS 67213

659 Sta. 180+00.00, Line C1-Cout =
 Sta. 123+03.00, 33.50' Lt.
 Const. Inlet (Type 1) Curb Inlet, C1
 (L=10.0', W=4.0')
 Install 18" x 65.6' Storm Sewer
 (RCP)(E)
 See Sheet 66

DPK Property LLC
 2007 S. West St.
 Wichita, KS 67213

McMurry & Ruhl Leasing Co. LLC
 2005 S. West St.
 Wichita, KS 67213

663 Sta. 126+47.84, 36.35' Lt.
 Install Concrete Collar
 Connect to Exist. 18" PVC (W)
 Install 18" x 12.1' Storm Sewer
 (RCP)(NE)
 See Sheet 68

662 Sta. 126+40.24, 37.32' Lt.
 Remove Exist. Curb Inlet
 Remove 5.8 L.F. 18" RCP (SW)
 Remove 9.2 L.F. 12" PVC (SW)

662 Sta. 200+00.00, Line C10-C3a =
 Sta. 126+40.24, 37.32' Lt.
 Connect to Exist. 12" PVC (SW)
 Install 12" x 5.1' Storm Sewer
 (PVC)(E)
 Install 1 - 12" 22.5° Bend (SW)
 See Sheet 68

661 Sta. 200+05.08, Line C10-C3a =
 Sta. 126+38.50, 31.00' Lt.
 Const. Driveway Inlet (Grated, Double), C10
 Install 18" x 13.1' Storm Sewer
 (RCP)(NE)
 See Sheet 68

664 Sta. 200+18.16, Line C10-C3a =
 Sta. 126+50.85, 24.60' Lt.
 Const. Manhole (Reinforced), MH33
 (L=4.0', W=4.0')
 Install 18" x 54.7' Storm Sewer
 (RCP)(E)
 See Sheet 68

DF Commercial Properties LLC
 4015 W. May Ave.
 Wichita, KS 67213

666 Sta. 210+00.00, Line C8-C3b =
 Sta. 126+60.00, 33.50' Lt.
 Const. Inlet (Type 1) Curb Inlet, C8
 (L=10.00', W=4.0')
 Install 24" x 64.7' Concrete Pipe
 (RCP)(E)
 See Sheet 67

665 Sta. 126+51.49
 Install Concrete Collar
 SUBSIDIARY to the bid item,
 "Temporary SWS Connection".

West Jewell Properties LLC
 S. West St.
 Wichita, KS 67213

658 Sta. 180+65.59, Line C1-Cout =
 Sta. 123+03.00, 31.00' Rt.
 Const. Inlet (Type 2, Special), C2a
 (L=6.2', W=7.5')
 Install 24" x 7.0' Storm Sewer
 (RCP)(N)
 See Sheet 66

660 Sta. 180+72.60, Line C1-Cout =
 Sta. 123+10.00, 31.00' Rt.
 Const. Inlet (Type 2, Special), C2b
 (L=6.2', W=7.5')
 Install 24" x 342.0' Storm Sewer
 (RCP)(N)
 See Sheet 66

Toon Investments LLC,
 2018 S. West St.
 Wichita, KS 67213

665 Sta. 200+72.89, Line C10-C3a =
 Sta. 184+14.59, Line C1-Cout =
 Sta. 126+52.25, 31.00' Rt.
 Const. Inlet (Type 2, Special), C3a
 (L=6.2', W=8.5')
 Install 30" x 7.0' Storm Sewer (RCP)(N)
 Connect Existing 12" RCP (SE)
 See Sheets 66, 68

667 Sta. 210+65.10, Line C8-C3b =
 Sta. 184+21.59, Line C1-Cout =
 Sta. 126+59.25, 31.00' Rt.
 Const. Inlet (Type 2, Special), C3b
 (L=6.2', W=8.5')
 Install 30" x 82.4' Storm Sewer (RCP)(N)
 Connect Existing 19"x23" HECMP (E)
 See Sheets 66, 67

1970 S. West LLC
 1970 S. West St.
 Wichita, KS 67213

Toon Investments LLC,
 21 S. West St.
 Wichita, KS 67213

No Address
 1970 S. West St.
 Wichita, KS 67213

Note:
 There is minimal clearance between the aggregate base and top of existing storm sewer pipe to remain. Use caution whenever construction activity takes place in those areas.

The Contractor shall coordinate with the utility companies to locate any existing utilities that have not been previously located.

Any storm sewer adjacent to the curb & gutter or under any proposed pavement on mainline, side roads or entrances shall be backfilled in accordance with the City of Wichita Specifications unless otherwise noted on the plans or by the Engineer.

The space between the Type 2 Special inlets shall be filled with Flowable Fill. The Flowable Fill shall be considered SUBSIDIARY to the inlets.

The materials & labor required to install the 12" PVC Bend & connect the proposed 12" PVC to the existing 12" PVC at Sta. 126+40.24, 37.32' Lt. shall be considered SUBSIDIARY to the bid item "Pipe, SWS 12" (PVC)".