

CONSULTANTS:

WEST STREET IMPROVEMENTS  
 FROM PAWNEE TO HARRY



REVISIONS:	MARK	DATE	DESCRIPTION

PROJ NO: 87 N-0720-01  
 SCALE: 1"=20'  
 DATE: 9/25/2023  
 DESIGNED BY: MLC  
 DRAWN BY: LCV  
 CHECKED BY: MDB

SHEET TITLE:  
**PAWNEE AVE.  
 STORM SEWER  
 IMPROVEMENTS**

SHEET NO.  
**55**  
 SHEET 55 OF 517

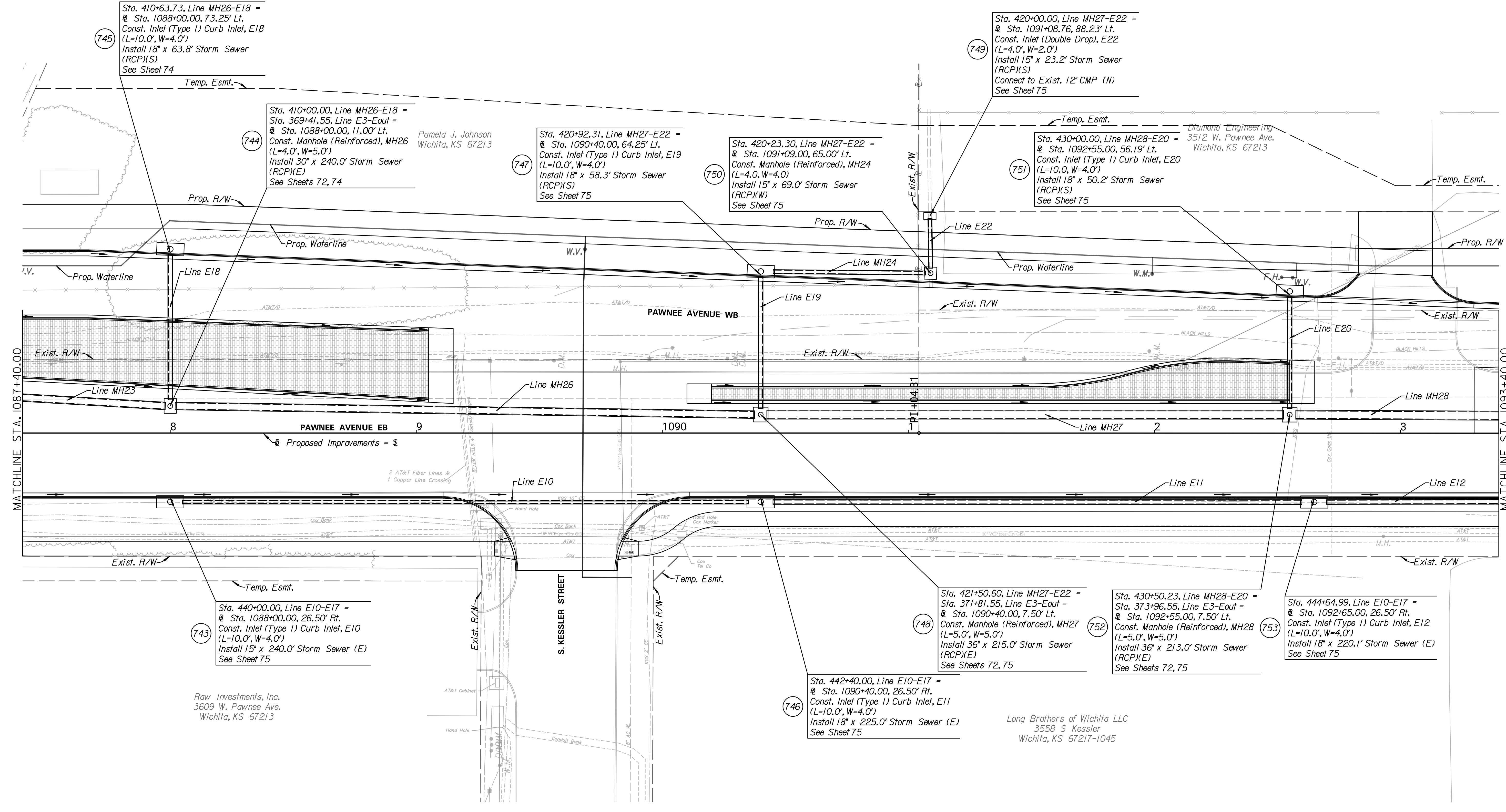

745  
 Sta. 410+63.73, Line MH26-E18 =  
 @ Sta. 1088+00.00, 73.25' Lt.  
 Const. Inlet (Type 1) Curb Inlet, E18  
 (L=10.0', W=4.0')  
 Install 18" x 63.8' Storm Sewer  
 (RCP)(S)  
 See Sheet 74

744  
 Sta. 410+00.00, Line MH26-E18 =  
 Sta. 369+41.55, Line E3-Eout =  
 @ Sta. 1088+00.00, 11.00' Lt.  
 Const. Manhole (Reinforced), MH26  
 (L=4.0', W=5.0')  
 Install 30" x 240.0' Storm Sewer  
 (RCP)(E)  
 See Sheets 72, 74  
 Pamela J. Johnson  
 Wichita, KS 67213

747  
 Sta. 420+92.31, Line MH27-E22 =  
 @ Sta. 1090+40.00, 64.25' Lt.  
 Const. Inlet (Type 1) Curb Inlet, E19  
 (L=10.0', W=4.0')  
 Install 18" x 58.3' Storm Sewer  
 (RCP)(S)  
 See Sheet 75

750  
 Sta. 420+23.30, Line MH27-E22 =  
 @ Sta. 1091+09.00, 65.00' Lt.  
 Const. Manhole (Reinforced), MH24  
 (L=4.0, W=4.0)  
 Install 15" x 69.0' Storm Sewer  
 (RCP)(W)  
 See Sheet 75

749  
 Sta. 420+00.00, Line MH27-E22 =  
 @ Sta. 1091+08.76, 88.23' Lt.  
 Const. Inlet (Double Drop), E22  
 (L=4.0', W=2.0')  
 Install 15" x 23.2' Storm Sewer  
 (RCP)(S)  
 Connect to Exist. 12" CMP (N)  
 See Sheet 75

751  
 Sta. 430+00.00, Line MH28-E20 =  
 @ Sta. 1092+55.00, 56.19' Lt.  
 Const. Inlet (Type 1) Curb Inlet, E20  
 (L=10.0, W=4.0')  
 Install 18" x 50.2' Storm Sewer  
 (RCP)(S)  
 See Sheet 75  
 Diamond Engineering  
 3512 W. Pawnee Ave.  
 Wichita, KS 67213

743  
 Sta. 440+00.00, Line E10-E17 =  
 @ Sta. 1088+00.00, 26.50' Rt.  
 Const. Inlet (Type 1) Curb Inlet, E10  
 (L=10.0', W=4.0')  
 Install 15" x 240.0' Storm Sewer (E)  
 See Sheet 75

Raw Investments, Inc.  
 3609 W. Pawnee Ave.  
 Wichita, KS 67213

746  
 Sta. 442+40.00, Line E10-E17 =  
 @ Sta. 1090+40.00, 26.50' Rt.  
 Const. Inlet (Type 1) Curb Inlet, E11  
 (L=10.0', W=4.0')  
 Install 18" x 225.0' Storm Sewer (E)  
 See Sheet 75

Long Brothers of Wichita LLC  
 3558 S Kessler  
 Wichita, KS 67217-1045

748  
 Sta. 421+50.60, Line MH27-E22 =  
 Sta. 371+81.55, Line E3-Eout =  
 @ Sta. 1090+40.00, 7.50' Lt.  
 Const. Manhole (Reinforced), MH27  
 (L=5.0', W=5.0')  
 Install 36" x 215.0' Storm Sewer  
 (RCP)(E)  
 See Sheets 72, 75

752  
 Sta. 430+50.23, Line MH28-E20 =  
 Sta. 373+96.55, Line E3-Eout =  
 @ Sta. 1092+55.00, 7.50' Lt.  
 Const. Manhole (Reinforced), MH28  
 (L=5.0', W=5.0')  
 Install 36" x 213.0' Storm Sewer  
 (RCP)(E)  
 See Sheets 72, 75

753  
 Sta. 444+64.99, Line E10-E17 =  
 @ Sta. 1092+65.00, 26.50' Rt.  
 Const. Inlet (Type 1) Curb Inlet, E12  
 (L=10.0', W=4.0')  
 Install 18" x 220.1' Storm Sewer (E)  
 See Sheet 75