

- LEGEND**
- Contraction Joint
 - Longitudinal Joint
 - ===== Expansion Joint
 - 3/4" Core Hole

Notes:
 All concrete pavement on valley gutters shall be "Concrete Pavement (VG) 8" (Reinf.)* See Sheet

Pavement joints shall be continued through curb & gutter and match joint patterns where possible

All joints within the reinforced concrete pavement shall be tied with #4 bars 2' long spaced on 30" centers in all directions with 6" x 12" - W4 x W4 welded wire mesh.

For jointing at drives, entrances and valley gutters, See Sheets 120,121,&128

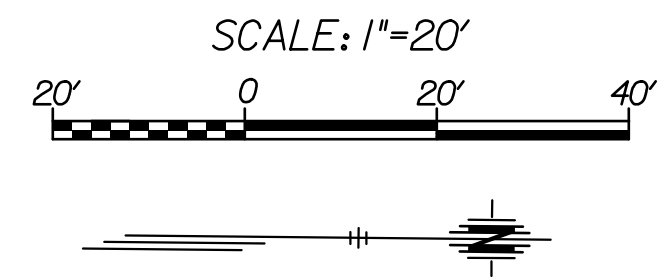

TRANSYSTEMS

245 N. WACO
 SUITE 222
 WICHITA, KANSAS 67202
 MAIN: 316-303-3000
 FAX: 316-462-5629

CONSULTANTS:

WEST STREET IMPROVEMENTS FROM PAWNEE TO HARRY

WICHITA, KANSAS

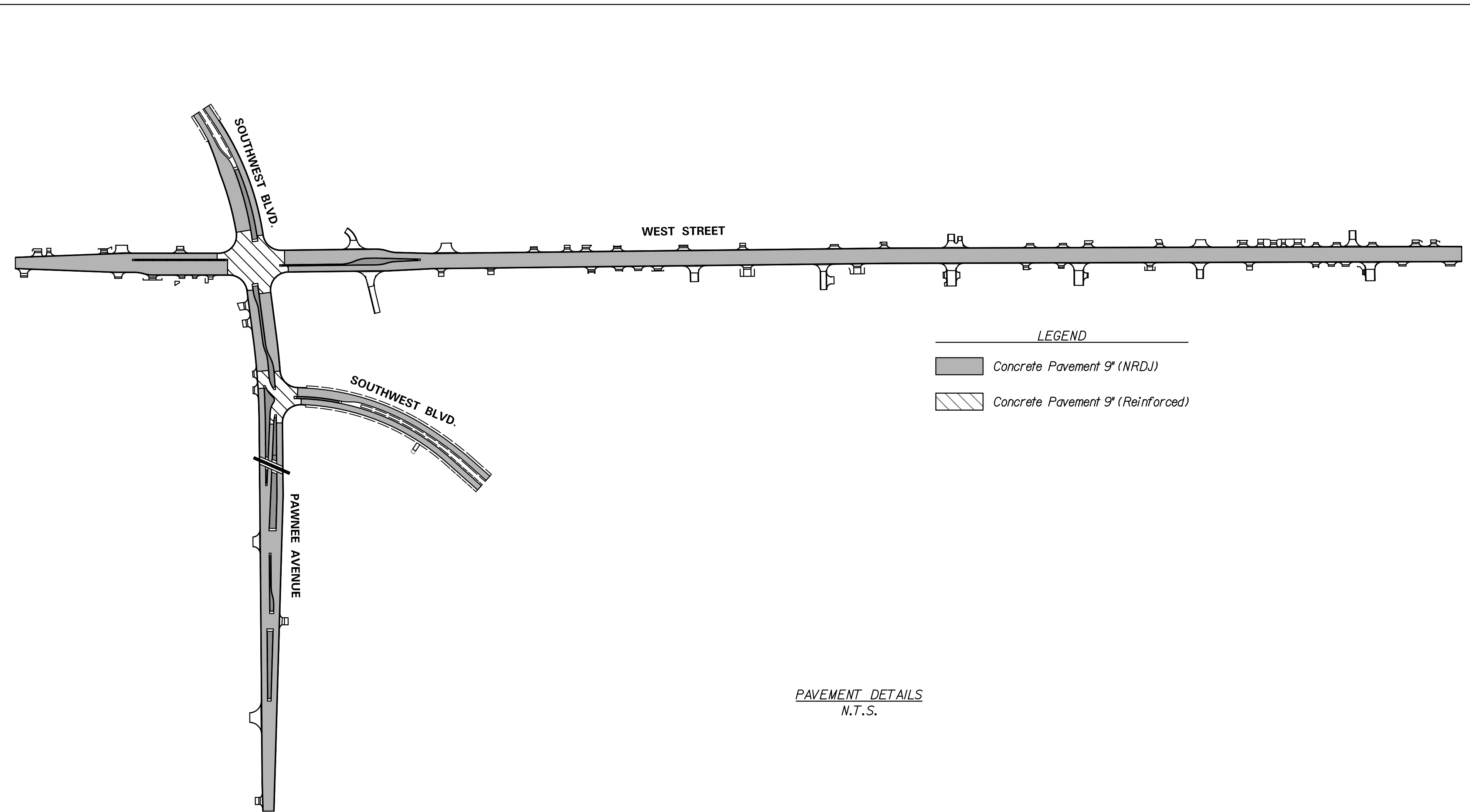

- LEGEND**
- Concrete Pavement 9" (NRDJ)
 - Concrete Pavement 9" (Reinforced)

PAVEMENT DETAILS
 N.T.S.

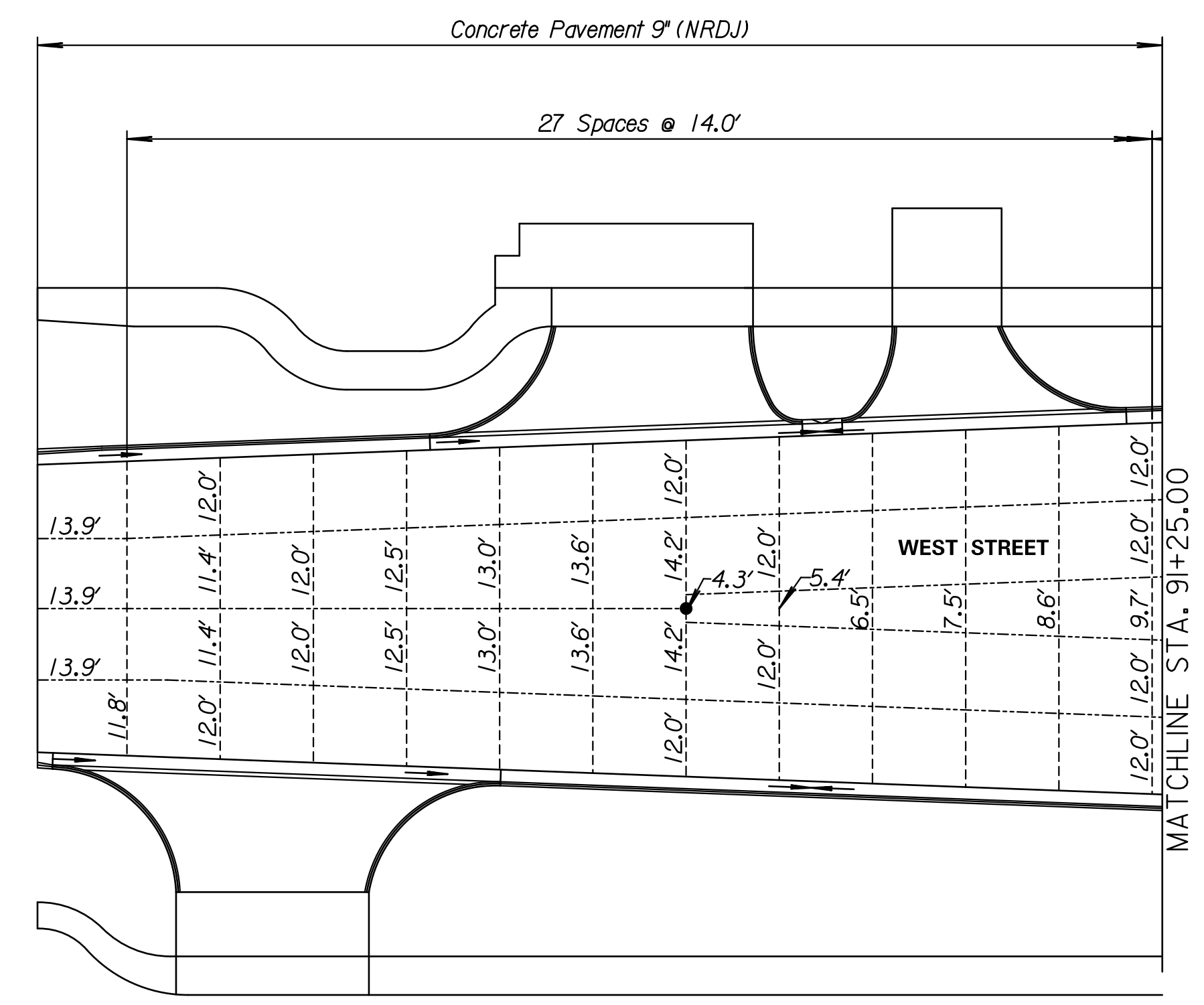

REVISIONS:	MARK	DATE	DESCRIPTION

PROJ NO: 87 N-0720-01
 SCALE: 1"=20'
 DATE: 9/25/2023
 DESIGNED BY: DJK
 DRAWN BY: DJK
 CHECKED BY: MDB

SHEET TITLE:
 WEST STREET JOINTING PLAN
 STA. 89+50.00 TO
 STA. 91+25.00

SHEET NO.
 94

9/25/2023 8:24:20 PM - c:\transystems\paw_bowl\transystems\paw\1a-e_krohs\d0984549\C-INT-M01-101.DGN