

10/25/2023 4:16:27 PM  
Autodesk Docs://220008-003 - South Lakes Pickleball - South Lakes Pickleball - South/220008-003\_ELEC\_R22.rvt

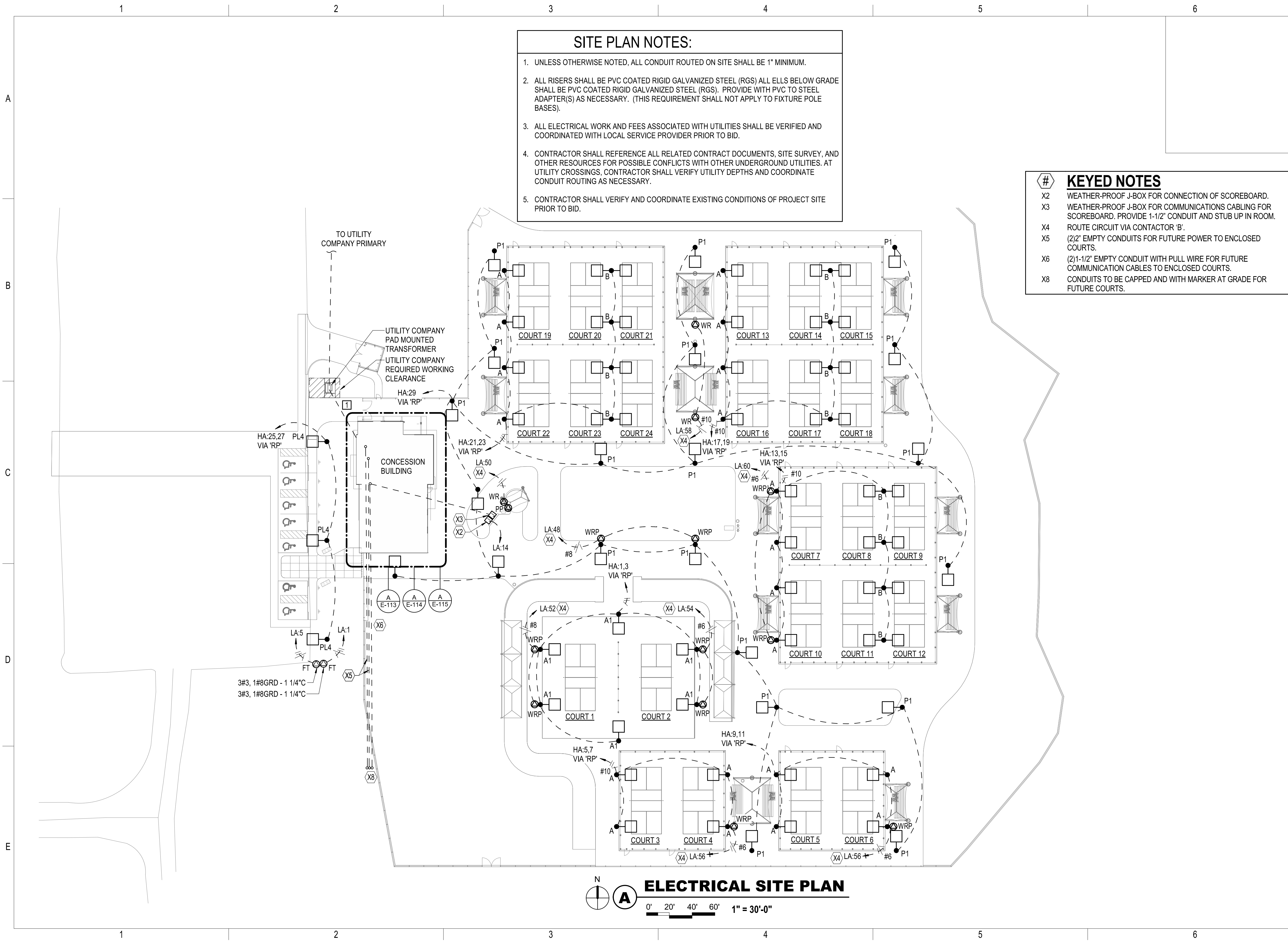

**SITE PLAN NOTES:**

- UNLESS OTHERWISE NOTED, ALL CONDUIT ROUTED ON SITE SHALL BE 1" MINIMUM.
- ALL RISERS SHALL BE PVC COATED RIGID GALVANIZED STEEL (RGS) ALL ELLS BELOW GRADE SHALL BE PVC COATED RIGID GALVANIZED STEEL (RGS). PROVIDE WITH PVC TO STEEL ADAPTER(S) AS NECESSARY. (THIS REQUIREMENT SHALL NOT APPLY TO FIXTURE POLE BASES).
- ALL ELECTRICAL WORK AND FEES ASSOCIATED WITH UTILITIES SHALL BE VERIFIED AND COORDINATED WITH LOCAL SERVICE PROVIDER PRIOR TO BID.
- CONTRACTOR SHALL REFERENCE ALL RELATED CONTRACT DOCUMENTS, SITE SURVEY, AND OTHER RESOURCES FOR POSSIBLE CONFLICTS WITH OTHER UNDERGROUND UTILITIES. AT UTILITY CROSSINGS, CONTRACTOR SHALL VERIFY UTILITY DEPTHS AND COORDINATE CONDUIT ROUTING AS NECESSARY.
- CONTRACTOR SHALL VERIFY AND COORDINATE EXISTING CONDITIONS OF PROJECT SITE PRIOR TO BID.

**# KEYED NOTES**

- X2 WEATHER-PROOF J-BOX FOR CONNECTION OF SCOREBOARD.
- X3 WEATHER-PROOF J-BOX FOR COMMUNICATIONS CABLING FOR SCOREBOARD. PROVIDE 1-1/2" CONDUIT AND STUB UP IN ROOM.
- X4 ROUTE CIRCUIT VIA CONTACTOR 'B'.
- X5 (2)2" EMPTY CONDUITS FOR FUTURE POWER TO ENCLOSED COURTS.
- X6 (2)1-1/2" EMPTY CONDUIT WITH PULL WIRE FOR FUTURE COMMUNICATION CABLES TO ENCLOSED COURTS.
- X8 CONDUITS TO BE CAPPED AND WITH MARKER AT GRADE FOR FUTURE COURTS.

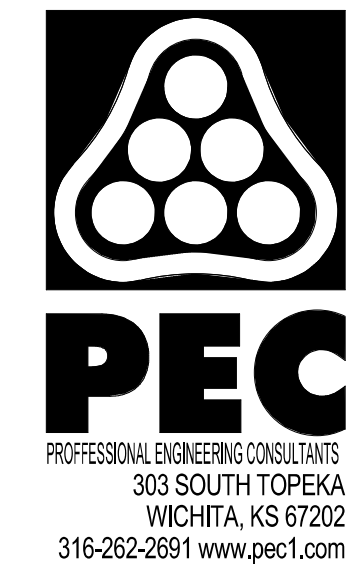

**SOUTH LAKES  
SPORTS PARK  
WICHITA, KS**

Issue:		
100% PLANS		10/18/23
BID SETS		10/25/23
JOB NO.	220008-003	
DATE	18 OCTOBER 2023	
PM	NLS	
DESIGNED BY	DCG	
DRAWN BY	SRM	
CHECKED BY	SMS	

ELECTRICAL SITE PLAN

E-111