



**SOUTH LAKES PARK - PICKLEBALL COMPLEX**  
 WICHITA, KS

Issue:		
BID SET		5/25/23
JOB NO.	220008-001	
DATE	25 MAY 2023	
PM	NLS	
DESIGNED BY	NLS	
DRAWN BY	JSG	
CHECKED BY	MEB	

SITE ARCHITECTURAL DETAILS

SA501

**CONCRETE WALK NOTES**

- THICKENED EDGE ONLY REQUIRED AT ABUTMENT TO BUILDING, WALL, AND EXISTING PAVEMENT.
- 4" SLAB THICKNESS UNLESS SPECIFIED OTHERWISE ON THE PLAN SHEET. 4000 PSI 28 DAY COMPRESSIVE STRENGTH (CLASS 1).
- NO SAWN CONTRACTION JOINTS WILL BE ALLOWED.

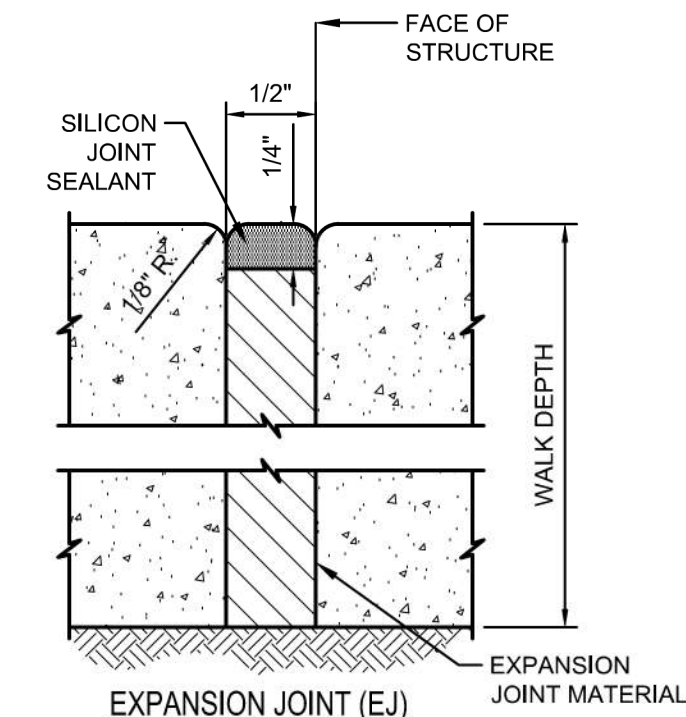
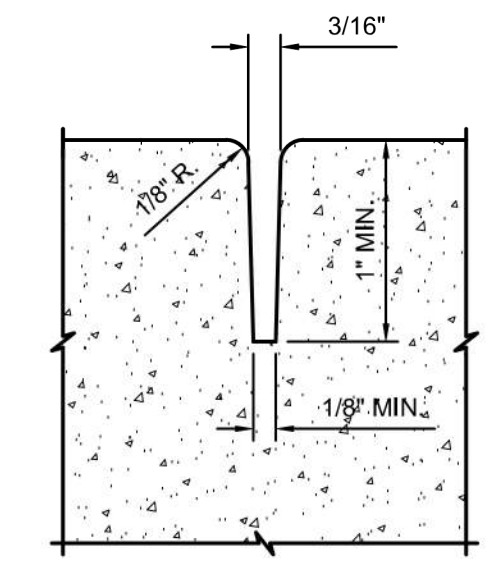
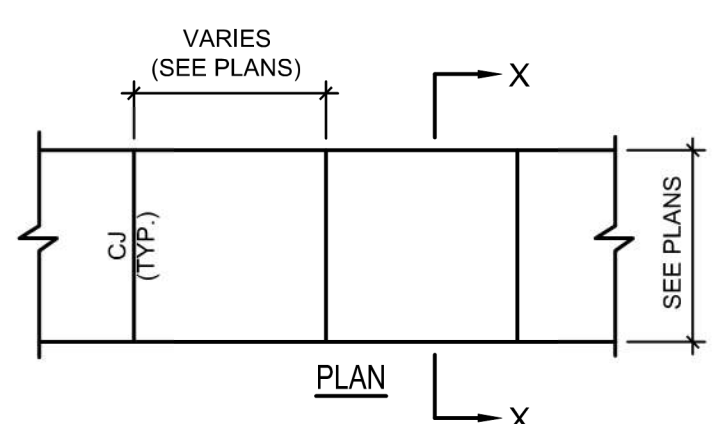

**CONTRACTION JOINT (CJ)**      **EXPANSION JOINT (EJ)**

- SIDEWALK CONSTRUCTION JOINT NOTES**
- PROVIDE 1/2" EXPANSION JOINT MATERIAL AT ALL LOCATIONS WHERE NEW CONCRETE ABUTS EXISTING OR NEW STRUCTURES AND AT BACK OF CURB.

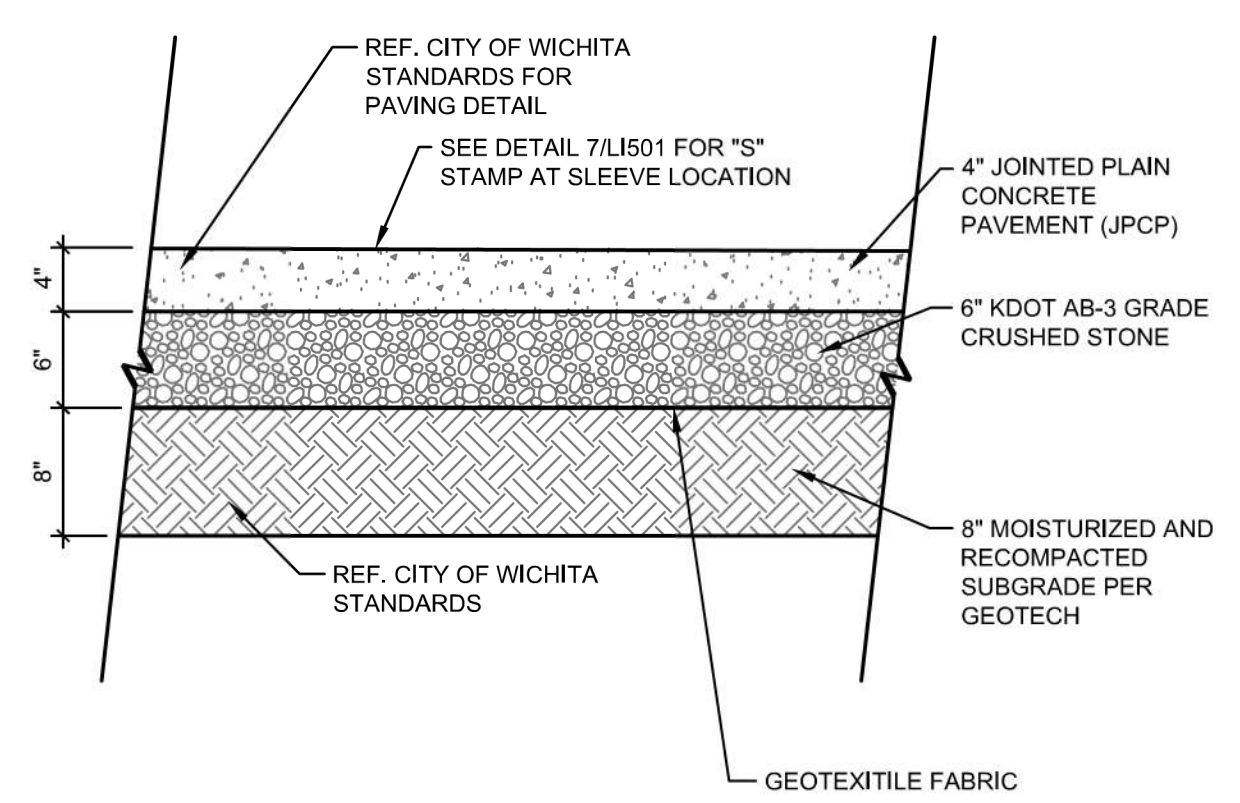

**3 4" CONCRETE PAVEMENT SECTION**  
1" = 1'-0"      VIEW-590674758

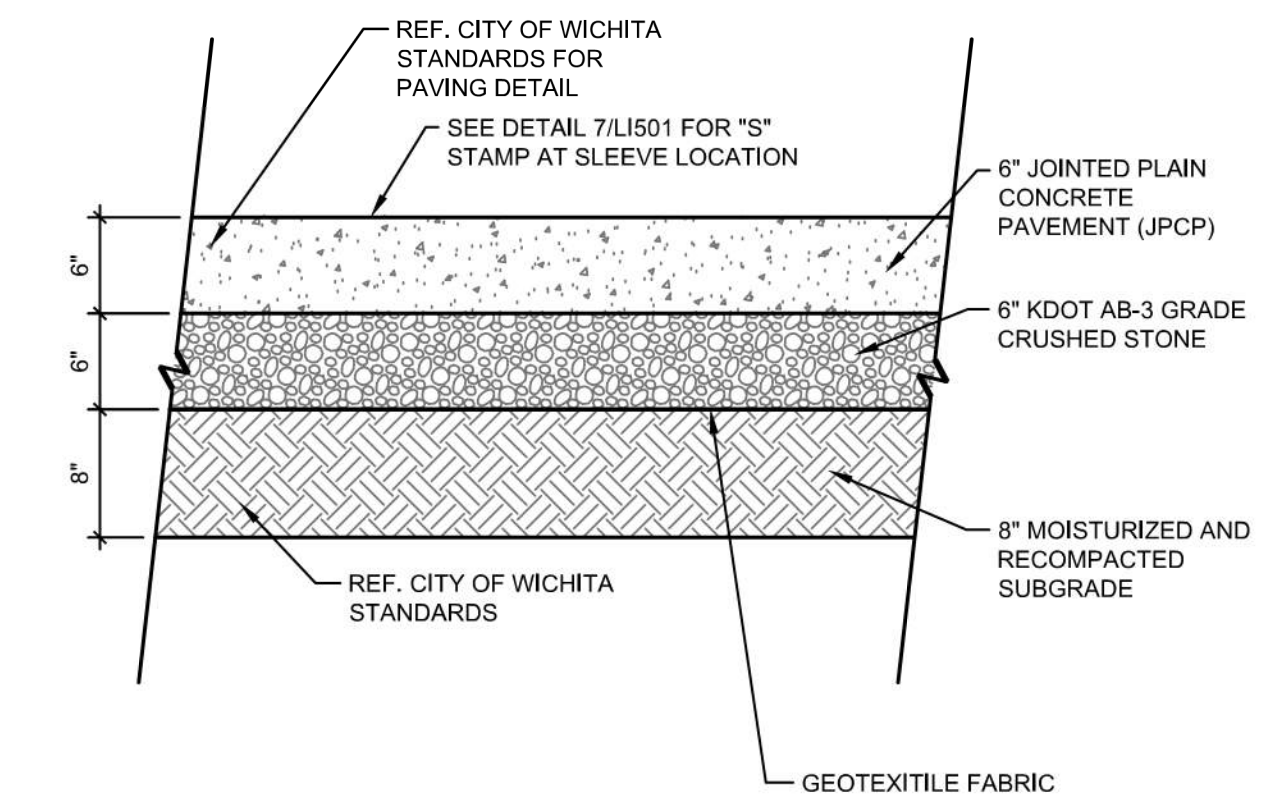

**4 6" CONCRETE PAVEMENT SECTION**  
1" = 1'-0"      VIEW-220152617

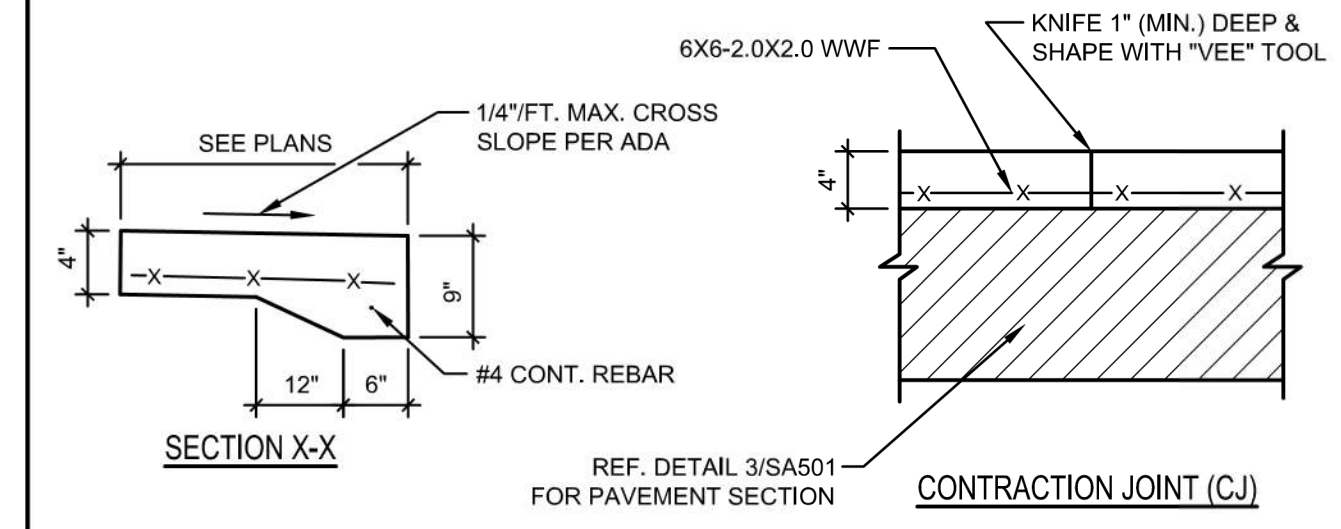

**1 CONCRETE SIDEWALK DETAIL**  
1" = 1'-0"      VIEW-964922190

**2 CONCRETE JOINT DETAIL**  
1" = 1'-0"      VIEW-556528271

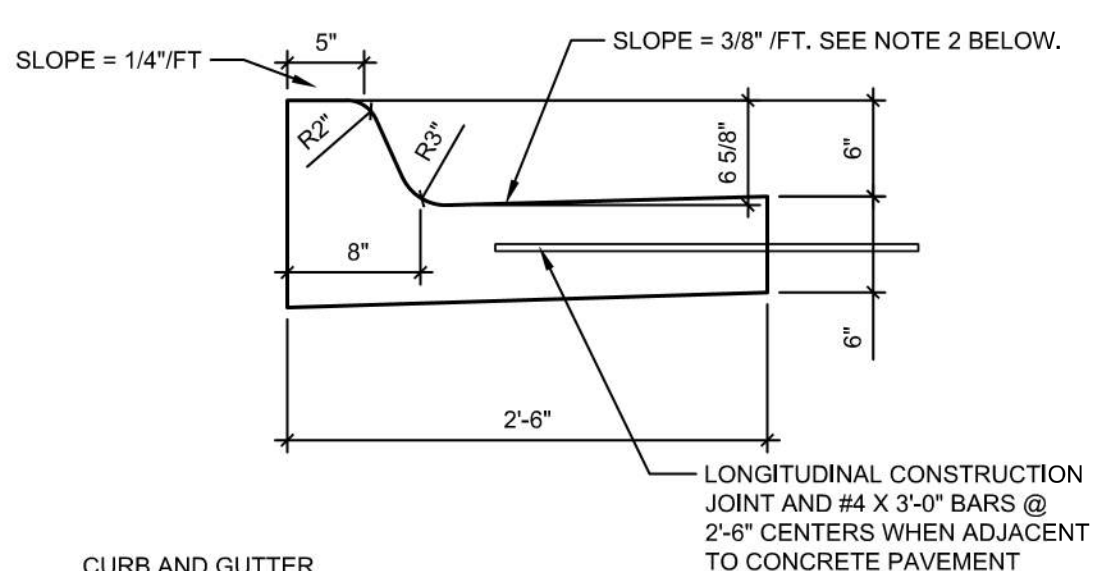

- CURB AND GUTTER**
- D = THICKNESS OF ADJACENT PAVEMENT.
  - SLOPE SAME AS ADJACENT PAVEMENT. CONTRACTOR SHALL VERIFY DIRECTION OF SLOPE WITH FINAL GRADING.
  - CONTRACTOR MAY OMIT BARS AND CONSTRUCTION JOINT FOR CURB AND GUTTER IF POURED MONOLITHIC WITH ADJACENT CONCRETE PAVEMENT.
  - JOINTS SHALL BE SAW-CUT AT RIGHT ANGLES TO THE CURB TO A DEPTH OF 1-1/4" (MIN.) AND HAVE A WIDTH NO GREATER THAN 3/8". SEALING OF JOINTS IS NOT REQUIRED. EXPANSION JOINTS SHALL BE CONSTRUCTED AT CURVE RETURNS AND AT A MAXIMUM SPACING OF 250' ON STRAIGHT RUNS. JOINT SPACING SHALL MATCH ADJACENT CONCRETE PAVEMENT.

**5 STANDARD CURB AND GUTTER**  
1" = 1'-0"      VIEW-297572554

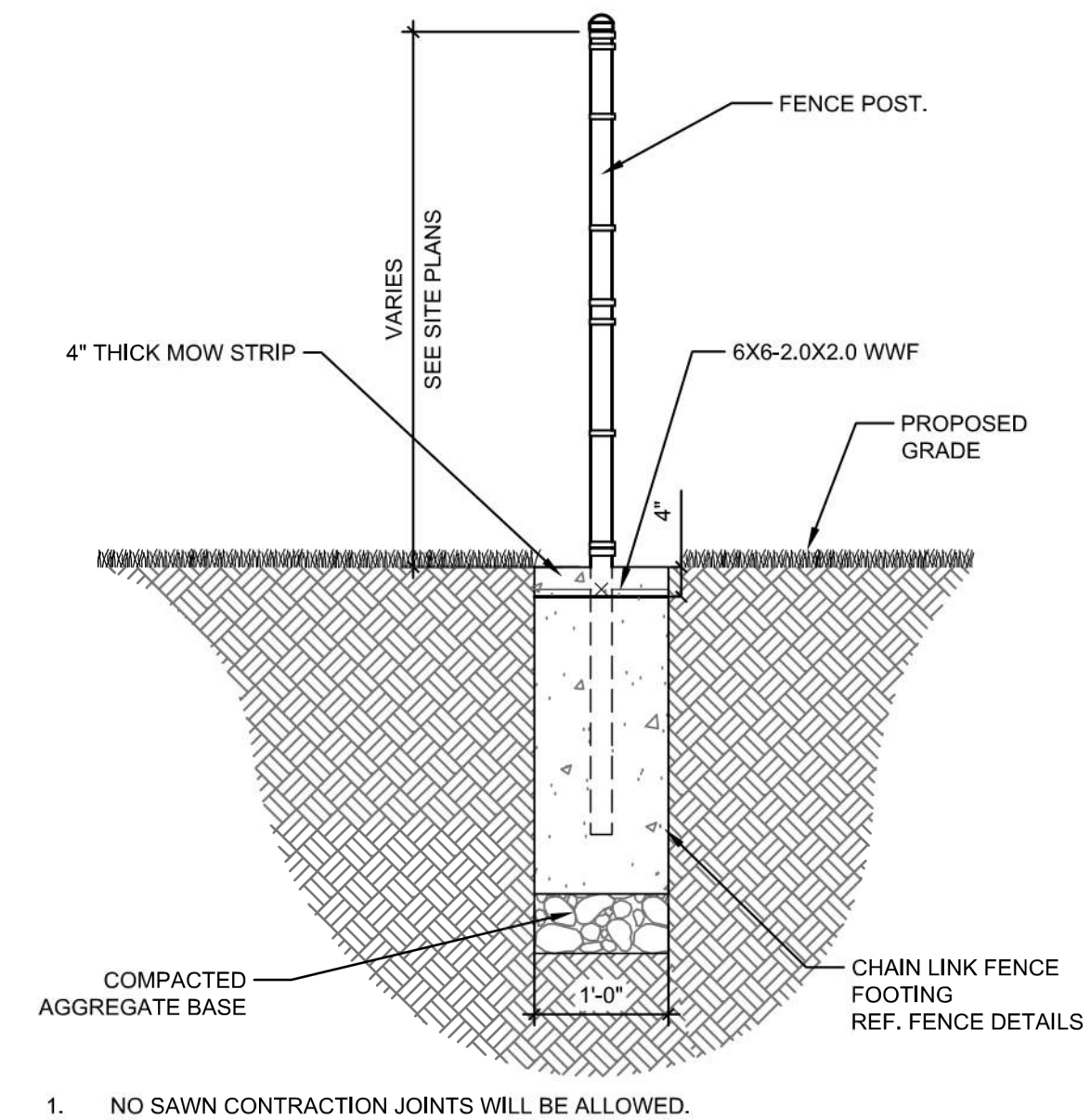

- NO SAWN CONTRACTION JOINTS WILL BE ALLOWED.

**6 CONCRETE MOW STRIP**  
1/2" = 1'-0"

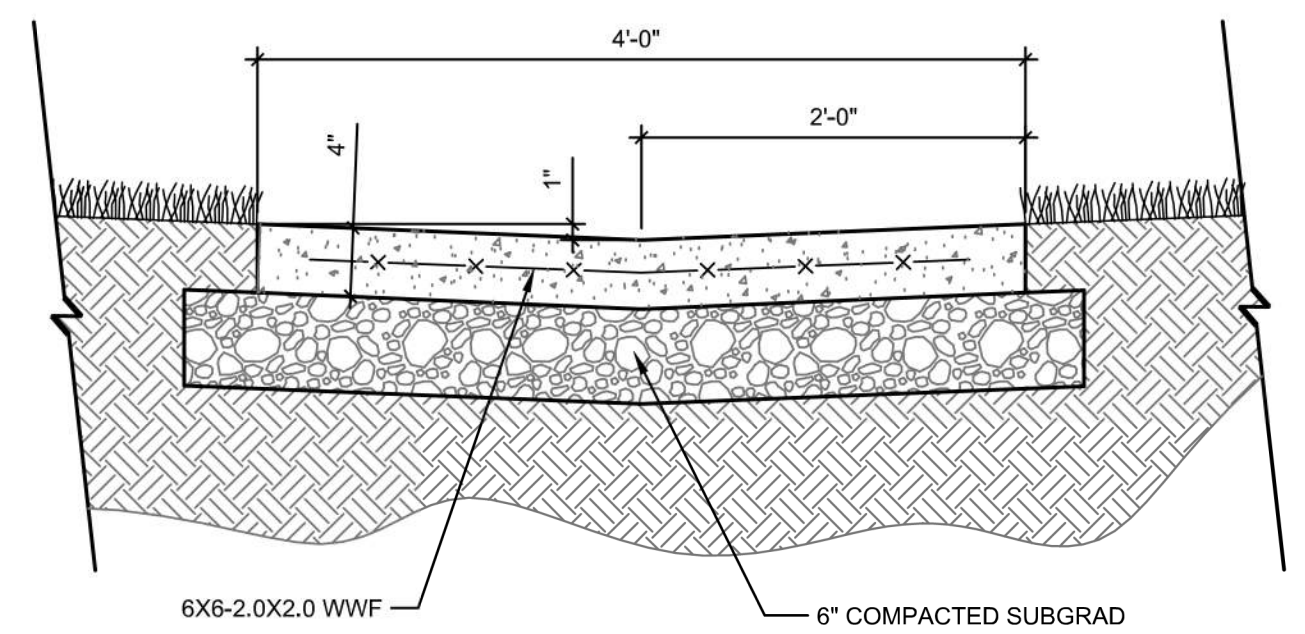

**7 CONCRETE FLUME DETAIL**  
1" = 1'-0"

SAVED 10/26/2023 3:32:16 AM BY ROY THOMAS  
 PLOTTED 10/26/2023 9:50:09 AM BY ROY THOMAS  
 U:\WICHITA-CIVIL\2022\220008\03\MUNICIPALDRAWINGS\220008-003-SA501.DWG