

SAVED 10/18/2023 4:17:43 PM BY ROY THOMAS  
 PLOTTED 10/26/2023 9:51:11 AM BY ROY THOMAS  
 U:\WICHITA-CIVIL\2022\220008\03\MUNICIPALDRAWINGS\220008-003-LS101.DWG

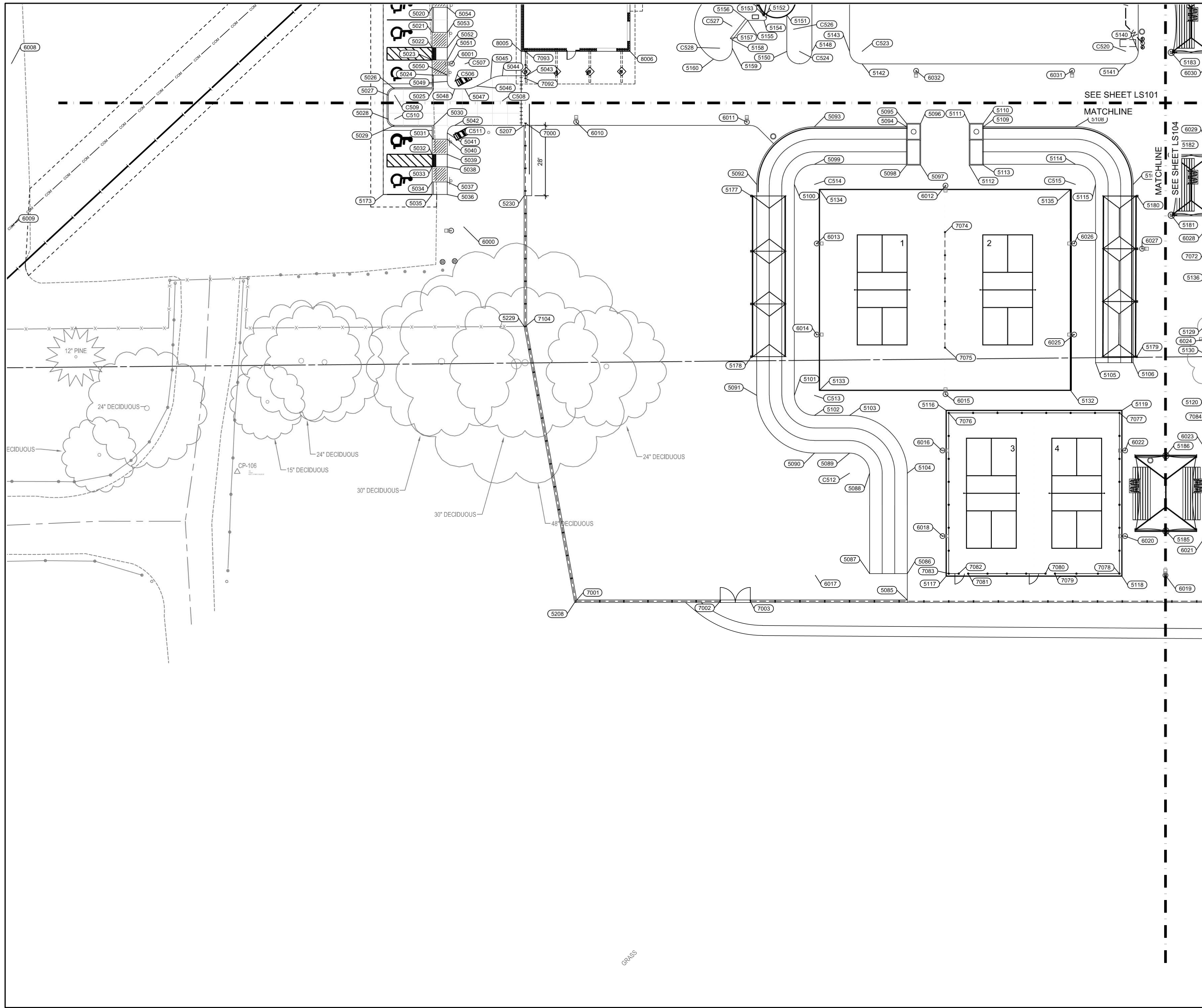

**COORDINATE NOTES**

1. REFERENCE SHEET LS201 FOR COORDINATE TABLES.
2. RADIUS POINTS ARE TO THE CENTER OF RADIUS.
3. COORDINATE POINTS ARE TO BACK OF CURB, EDGE OF PAVEMENT, OR CENTER OF STRUCTURE, UNLESS OTHERWISE NOTED.
4. BUILDING ALIGNMENT POINTS ARE FOR ORIENTATION OF BUILDING. REF. ARCHITECTURAL AND STRUCTURAL DRAWINGS FOR BUILDING PAD DIMENSIONS.

**LEGEND**

- (5000) = COORDINATE LABEL
- (C500) = RADIUS COORDINATE LABEL
- (6000) = LIGHT POLE COORDINATE POINTS
- (7000) = FENCE POINT LABEL
- (8000) = BUILDING ALIGNMENT POINTS

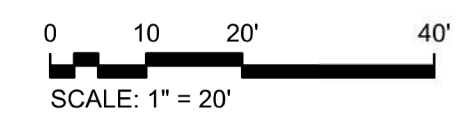

**GEOMETRY PLAN**



**SOUTH LAKES SPORTS PARK**  
 WICHITA, KS

Issue:		
100% PLANS		10/18/23
BID SETS		10/25/23

JOB NO.	220008-003
DATE	18 OCTOBER 2023
PM	NLS
DESIGNED BY	NLS
DRAWN BY	RFT
CHECKED BY	MEB

GEOMETRY PLAN

LS103