

PAVING STREETS AND INCIDENTAL DRAINAGE IN  
**HAWTHORNE THIRD ADDITION**

AN ADDITION TO THE CITY OF WICHITA  
 SEDGWICK COUNTY, KANSAS  
**WILLIAMSGATE CT. - PHASE 3**  
**PROJECT NO. 472-84083**

JIM ARMOUR, P.E. - CITY ENGINEER  
**OCA 765943**

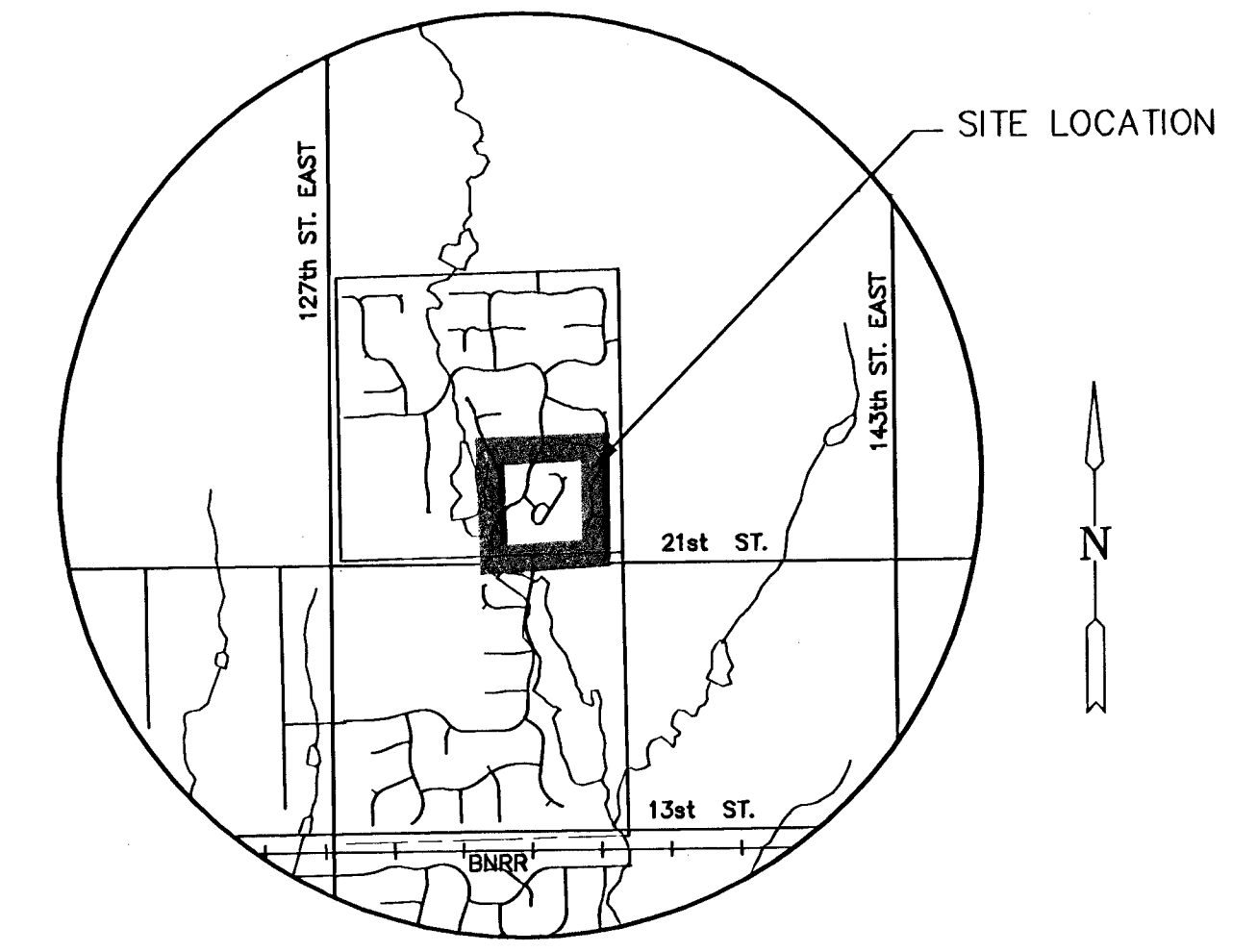

LOCATION MAP

**GENERAL NOTES**

- UNLESS SHOWN OR STATED OTHERWISE ON THESE DRAWINGS, MATERIALS AND CONSTRUCTION SHALL BE IN ACCORDANCE WITH CITY OF WICHITA CONCRETE PAVEMENT AND ASPHALTIC CONCRETE PAVEMENT SPECIFICATIONS.
- CONTRACTOR WILL BE REQUIRED TO PROVIDE A MINIMUM ADVANCE NOTICE OF SEVENTY-TWO (72) HOURS TO UTILITY COMPANIES PRIOR TO STARTING ANY EXCAVATION AS FOLLOWS:  
 KANSAS ONE-CALL 1-800-344-7233  
 OR 687-2470 (LOCAL WICHITA)
- THE CONTRACTOR MUST NOTIFY THE FOLLOWING IN CASE OF AN EMERGENCY:  
 SBC (TELEPHONE) 800-870-8390  
 COX COMMUNICATIONS (CABLE) 262-0661  
 WESTAR (ELECTRIC) 383-8600  
 KANSAS GAS SERVICE (GAS) 832-3101  
 CITY OF WICHITA WATER & SEWER MAINT. 262-6000  
 AQUILA (GAS) 946-0096
- THE CONTRACTOR SHALL BE RESPONSIBLE FOR PRESERVING PROPERTY IRONS. THE CONTRACTOR WILL BE REQUIRED TO RE-ESTABLISH ANY PROPERTY IRONS WHICH ARE DAMAGED OR DESTROYED BY HIS CONSTRUCTION OPERATIONS. SUCH IRONS SHALL BE RE-ESTABLISHED BY A LICENSED LAND SURVEYOR IN ACCORDANCE WITH STATE LAWS.
- EXISTING UTILITIES AND THEIR LOCATIONS, AS SHOWN ON THE PLANS REPRESENT THE BEST INFORMATION OBTAINABLE FOR DESIGN. LOCATION INFORMATION HAS BEEN OBTAINED FROM THE VARIOUS UTILITY COMPANIES AND IS EITHER FROM COMPANY RECORD DRAWINGS OR COMPANY PROVIDED FIELD LOCATIONS. THE PLAN LOCATIONS SHOWN ARE NOT GUARANTEED. ADDITIONAL EXISTING UTILITIES MAY ALSO BE ENCOUNTERED.
- RUBBLE FROM THE REMOVAL OF MISCELLANEOUS STRUCTURES AND EXCESS EXCAVATION WHICH IS TO BE WASTED SHALL BE DISPOSED OF ON SITES TO BE PROVIDED BY THE CONTRACTOR. THESE SITES SHALL BE APPROVED BY THE ENGINEER AS TO SUITABILITY, APPEARANCE AND SITE LOCATION. LOCATIONS THAT, IN THE OPINION OF THE ENGINEER, WILL LEAVE AN UNSIGHTLY APPEARANCE WILL NOT BE APPROVED. ALL DISPOSAL SITES MUST BE APPROVED BY THE KANSAS DEPARTMENT OF HEALTH AND ENVIRONMENT. MATERIAL EITHER STOCKPILED OR DISPOSED OF IN A FLOOD PLAIN WOULD REQUIRE A KANSAS STATE BOARD OF AGRICULTURE PERMIT. ANY MATERIAL DUMPED IN WATERS OF THE UNITED STATES OR WETLANDS IS SUBJECT TO U.S. CORPS OF ENGINEERS PERMITTING REGULATIONS. ANY MATERIAL BURIED OR STOCKPILED BEYOND APPROVED CONSTRUCTION LIMITS WOULD REQUIRE ADDITIONAL ARCHAEOLOGICAL INVESTIGATIONS UNLESS BURIED IN A PREVIOUSLY APPROVED BORROW LOCATION.
- THIS PROJECT INCLUDES A CERTAIN AMOUNT OF ROLL TYPE CURB CONSTRUCTION. ROLL CURBS SHALL BE DEPRESSED THROUGH ALL DRIVEWAY OPENINGS WHEN SUCH DRIVES ARE CONSTRUCTED AS A PART OF THE PROJECT. NO MORE THAN 2 DRIVES 20 FEET IN WIDTH OR EQUIVALENT COMBINATIONS THEREOF ARE TO BE CONSTRUCTED WITH THIS PROJECT.
- TRANSITION CURB FROM FULL HEIGHT COMBINATION CURB AND GUTTER TO ROLL TYPE COMBINATION CURB AND GUTTER IS TO BE PAID AS BID FOR LINEAL FEET COMBINED CURB AND GUTTER (3 5/8" ROLL).
- A SAW CUT OF AT LEAST ONE-HALF THE DEPTH OF THE EXISTING SURFACE COURSES OR ONE-FOURTH THE DEPTH OF THE EXISTING TOTAL PAVEMENT THICKNESS SHALL BE PROVIDED AT LOCATIONS WHERE PROPOSED CONSTRUCTION ABUTS AN EXISTING SURFACE OR PAVEMENT FOR WHICH PARTIAL REMOVAL OF THAT SURFACE OR PAVEMENT IS REQUIRED. SAW JOINT TO FACILITATE REMOVAL WITHIN THREE (3) FEET OF EXISTING JOINTS WILL NOT BE PERMITTED AND FOR SUCH INSTANCES THE LIMITS OF REMOVAL SHALL EXTEND TO THE EXISTING JOINT. SUCH SAW CUTS WILL NOT BE PAID FOR DIRECTLY AND THIS COST SHALL BE CONSIDERED AS SUBSIDIARY TO THE REMOVAL OF SURFACE OR PAVEMENT.
- REFER TO SHEET 16 FOR GRADING NOTES & DETAILS.
- REFER TO SHEET 18 FOR SEEDING & EROSION CONTROL MEASURES.
- INTENT OF ALT. #1 IS TO PROVIDE SITE GRADING BEYOND STREET GRADING LIMITS DEPICTED ON CROSS SECTIONS. SEE SHEET 17 FOR SITE GRADING PLAN. POND GRADING IS PART OF BASE BID.

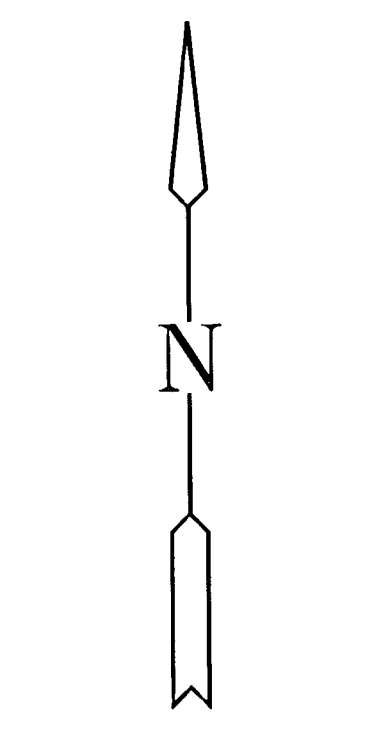

SCALE: 1" = 100'

**LEGEND**

- IRON

**INDEX TO DRAWINGS**

SHEET NO.	DESCRIPTION
1	TITLE SHEET
2-4	PAVING DETAILS
5-10	PAVING PLANS
11-13	STORM WATER DETAILS
14-15	SWS PLAN & PROFILE
16-17	BERM GRADING PLAN
18	EROSION PLAN
19-21	BMP DETAILS
22-35	CROSS SECTIONS
36	FINAL PLAT

**BENCHMARKS**

- BM #1 RR SPIKE IN FACE OF 1ST PP SOUTH OF 21ST ST., 218'± WEST AND 48'± SOUTH OF THE N 1/4 COR. SECTION 11-27S-2E ELEV.=1357.15
- BM #2 "□" ON NE COR. OF STORM INLET ON SOUTH SIDE OF WILLIAMSGATE ELEV.=1355.74
- BM #3 C.O.W. DISC TO SWS INLET ON EAST SIDE OF WILLIAMSGATE ELEV.=1357.98

LENGTH OF PROJECT	
WILLIAMSGATE CT.	1295.0 L.F.
BASE BID EARTHWORK SUMMARY	
EXCAVATION	2820 C.Y.
COMPACTED FILL	2450 C.Y.
ALT#1 EARTHWORK SUMMARY	
EXCAVATION	3150 C.Y.
BORROW	1430 C.Y.
COMPACTED FILL	3980 C.Y.

1.15% SHRINK FACTOR APPLIED

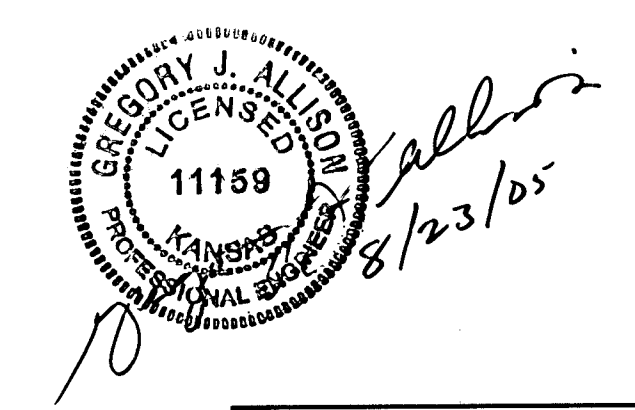

**MKEC ENGINEERING CONSULTANTS**  
 411 N. WEBB ROAD  
 WICHITA, KS. 67204  
 316 - 684 - 9600

**HAWTHORNE THIRD ADDITION - PHASE 3**  
**WILLIAMSGATE CT. (PATIO HOMES)**  
 PROJECT NAME

**TITLE SHEET**  
 SHEET TITLE

DESIGN BY: MKEC DRAWN BY: MKEC CHECKED BY: GJA  
 DATE: AUGUST 2005 JOB NO.: 02167 SHEET/OF: 1 / 36