

Curve #3
Rad = 334.99'
L = 170.97'
Δ = 29°14'30"

Curve #2
Rad = 290.00'
L = 431.98'
Δ = 85°20'50"

STA. 9+43.30' RT
INSTALL SNS
"TARA FALLS"
"TARA FALLS CT"
SEE SHEET NO. 7

CONSTRUCT VALLEY GUTTER PAVEMENT.
7" REINFORCED CONCRETE W/5" CRUSHED ROCK BASE, REINFORCED, AND MONOLITHIC EDGE CURB (6 5/8"). SEE DETAIL SHEET 16.

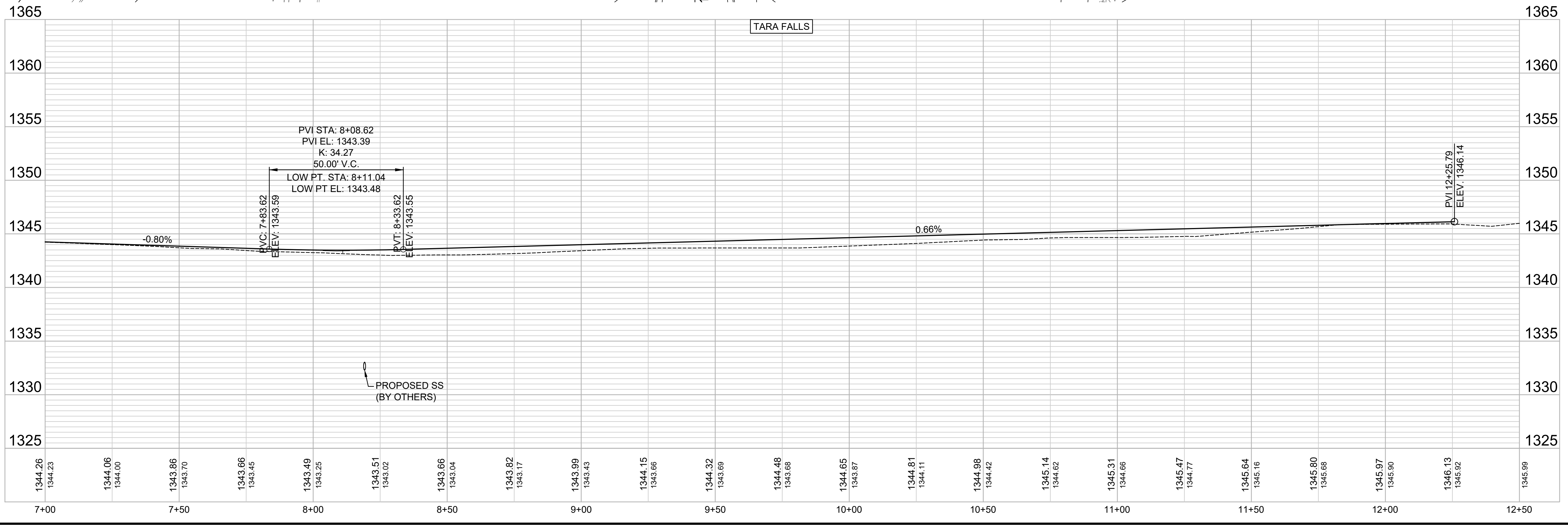
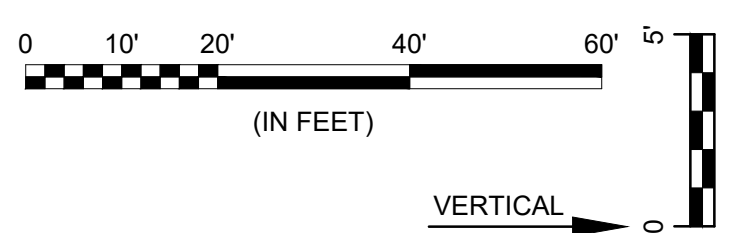

REV.	DATE	DESCRIPTION

TARA FALLS (3 OF 3)

JOB NO.: 22T41001
DATE: NOV 2023
DESIGNED BY: .
DRAWN BY: .

BAR IS ONE INCH ON ORIGINAL DRAWING
IF NOT ONE INCH ON THIS SHEET, ADJUST SCALES ACCORDINGLY.

DRAWING NUMBER