

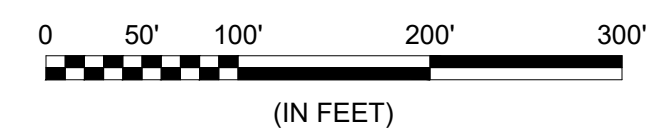

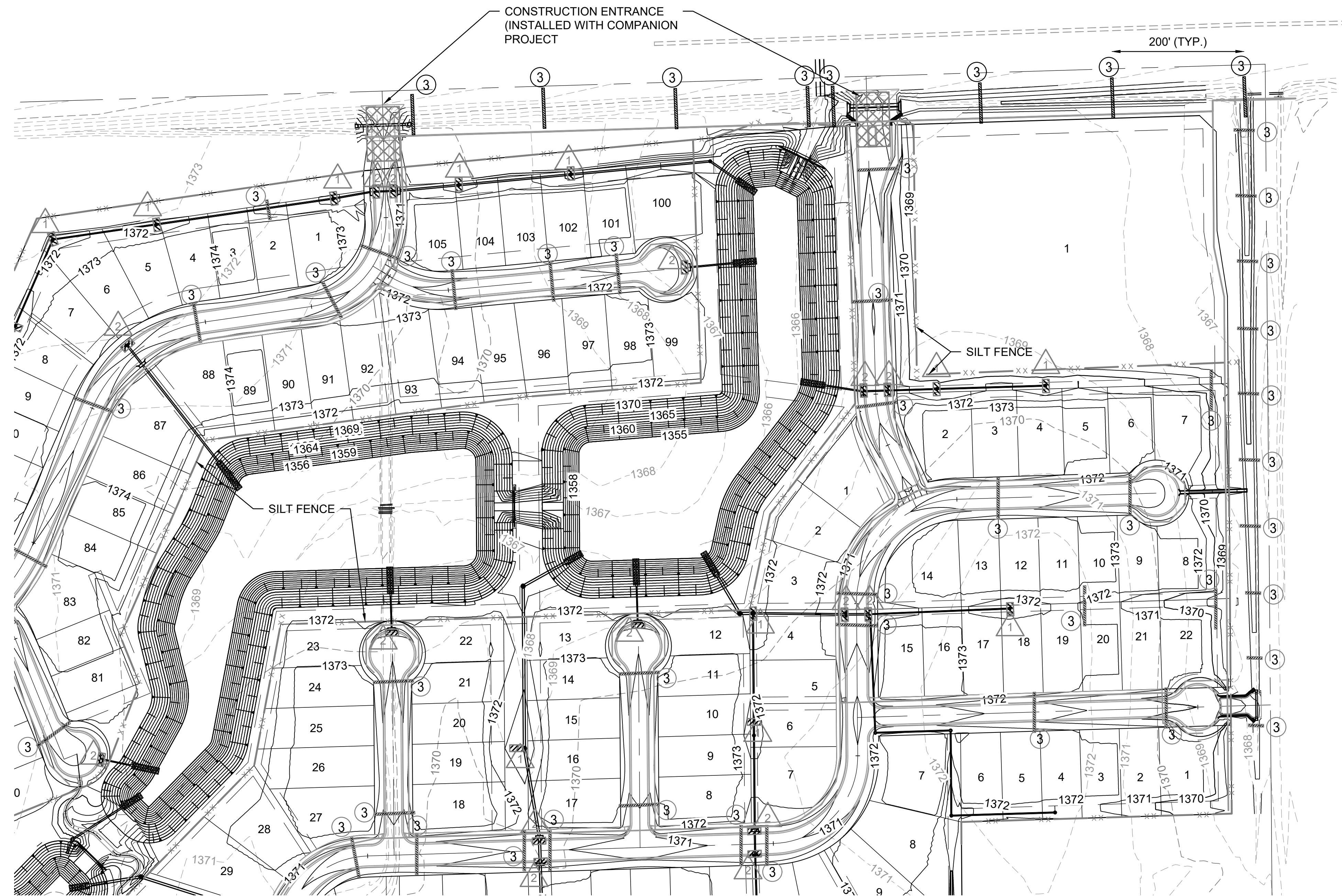



File: L:\2022\22141002 - Area 151 Addition\Drawings\C3D\22141002 EROSION CONTROL PLANS.dwg Last Save: 11/30/2023 2:57 PM Last saved by: DRStandrich
 Last plotted by: Standrich, Darryl R Plot Style: --- Plot Scale: 1:2.5849 Plot Date: 12/1/2023 9:52 AM Plotter Used: None



LEGEND

-  MAINTAIN CONSTRUCTION ENTRANCE (2 EACH)
-  MAINTAIN SILT FENCE (13,778 L.F.)
-  MAINTAIN DROP INLET PROTECTION (46 EACH)
-  MAINTAIN CURB INLET PROTECTION (44 EACH)
-  MAINTAIN LINEAR SEDIMENT BARRIER (117 EACH)
-  INSTALL ADDITIONAL LINEAR SEDIMENT BARRIERS (8 EACH)
 INSTALL IN SOUTH DITCH OF 21ST STREET NORTH. ALL OTHER EROSION CONTROL SHOWN IS TO BE INSTALLED WITH COMPANION PROJECTS FOR AREA 151 ADDITION, PHASE 1.

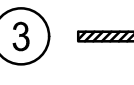

© 2023 GARVER, LLC
 THIS DOCUMENT, ALONG WITH THE IDEAS AND DESIGNS CONVEYED HEREIN, SHALL BE CONSIDERED INSTRUMENTS OF PROFESSIONAL SERVICE AND ARE PROPERTY OF GARVER, LLC. ANY USE, REPRODUCTION, OR DISTRIBUTION OF THIS DOCUMENT, ALONG WITH THE IDEAS AND DESIGN CONTAINED HEREIN, IS PROHIBITED UNLESS AUTHORIZED IN WRITING BY GARVER, LLC OR EXPLICITLY ALLOWED IN THE GOVERNING PROFESSIONAL SERVICES AGREEMENT FOR THIS WORK.

1995 Midfield Road
 Wichita, KS 67209
 (316) 264-8008

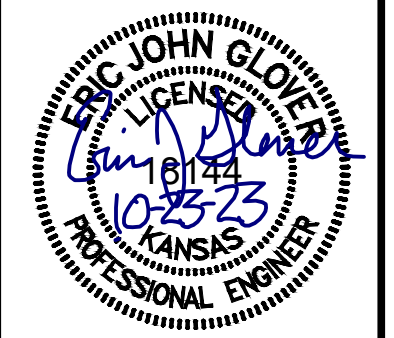

REV.	DATE	DESCRIPTION	BY



CITY OF WICHITA
 WICHITA, KANSAS
 21ST ST N & 151ST ST W
 WATER MAIN EXTENSIONS

**EC PLAN
 EXTERNAL
 WATER**

JOB NO.: 22T41002
 DATE: DEC. 2023
 DESIGNED BY: EJJ
 DRAWN BY: DRS

BAR IS ONE INCH ON ORIGINAL DRAWING
 IF NOT ONE INCH ON THIS SHEET, ADJUST SCALES ACCORDINGLY.

DRAWING NUMBER