

**WATERLINE IMPROVEMENTS
TO SERVE
CYPRESS GLEN ADDITION**

PAUL GUNZELMAN, P.E. - CITY ENGINEER
CITY OF WICHITA PROJECT NO. 448-2023-016042

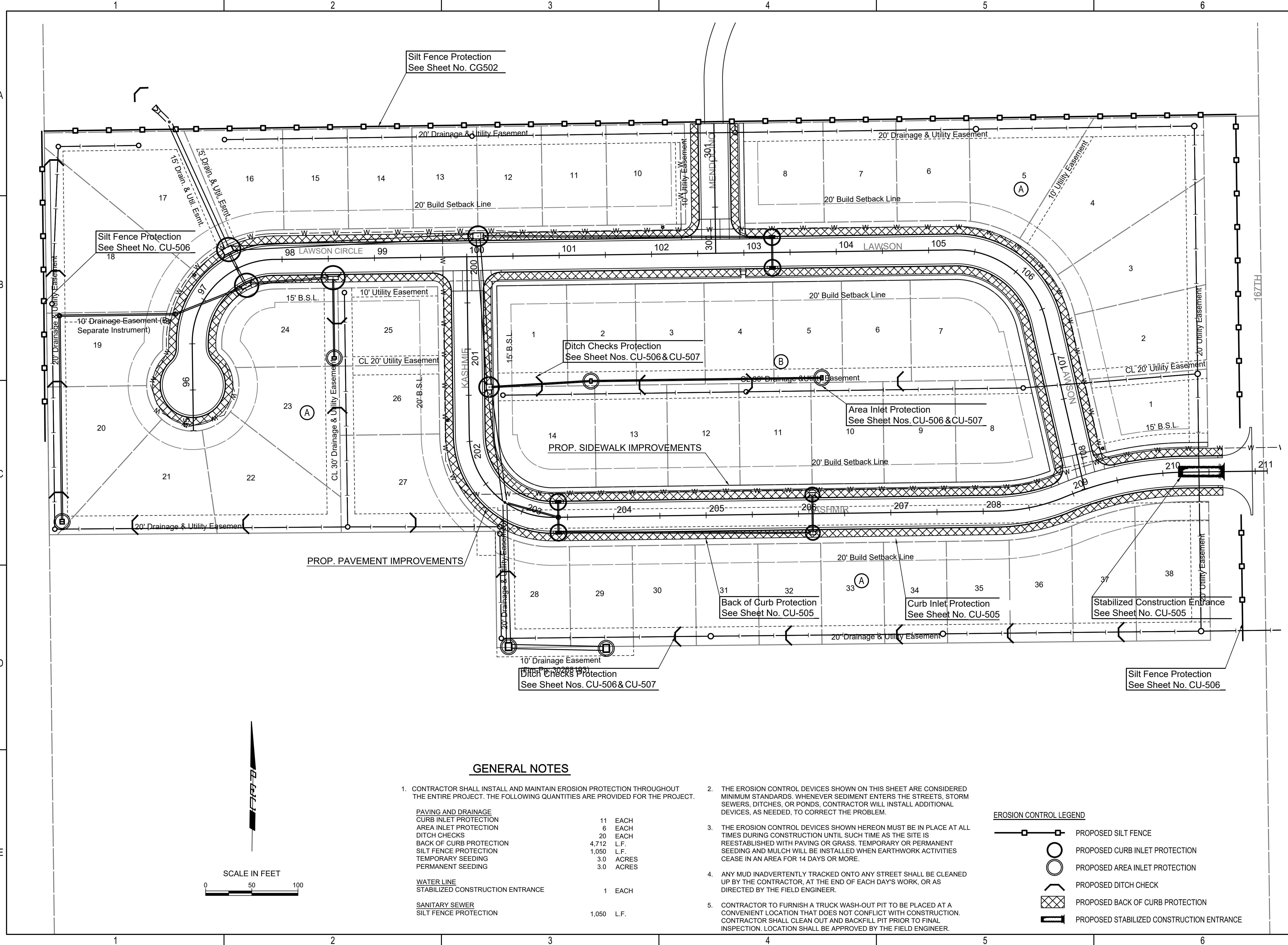

GENERAL NOTES

- CONTRACTOR SHALL INSTALL AND MAINTAIN EROSION PROTECTION THROUGHOUT THE ENTIRE PROJECT. THE FOLLOWING QUANTITIES ARE PROVIDED FOR THE PROJECT.

PAVING AND DRAINAGE		
CURB INLET PROTECTION	11	EACH
AREA INLET PROTECTION	6	EACH
DITCH CHECKS	20	EACH
BACK OF CURB PROTECTION	4,712	L.F.
SILT FENCE PROTECTION	1,050	L.F.
TEMPORARY SEEDING	3.0	ACRES
PERMANENT SEEDING	3.0	ACRES
- THE EROSION CONTROL DEVICES SHOWN ON THIS SHEET ARE CONSIDERED MINIMUM STANDARDS. WHENEVER SEDIMENT ENTERS THE STREETS, STORM SEWERS, DITCHES, OR PONDS, CONTRACTOR WILL INSTALL ADDITIONAL DEVICES, AS NEEDED, TO CORRECT THE PROBLEM.
- THE EROSION CONTROL DEVICES SHOWN HEREON MUST BE IN PLACE AT ALL TIMES DURING CONSTRUCTION UNTIL SUCH TIME AS THE SITE IS REESTABLISHED WITH PAVING OR GRASS. TEMPORARY OR PERMANENT SEEDING AND MULCH WILL BE INSTALLED WHEN EARTHWORK ACTIVITIES CEASE IN AN AREA FOR 14 DAYS OR MORE.
- ANY MUD INADVERTENTLY TRACKED ONTO ANY STREET SHALL BE CLEANED UP BY THE CONTRACTOR, AT THE END OF EACH DAY'S WORK, OR AS DIRECTED BY THE FIELD ENGINEER.
- CONTRACTOR TO FURNISH A TRUCK WASH-OUT PIT TO BE PLACED AT A CONVENIENT LOCATION THAT DOES NOT CONFLICT WITH CONSTRUCTION. CONTRACTOR SHALL CLEAN OUT AND BACKFILL PIT PRIOR TO FINAL INSPECTION. LOCATION SHALL BE APPROVED BY THE FIELD ENGINEER.

EROSION CONTROL LEGEND

- PROPOSED SILT FENCE
- PROPOSED CURB INLET PROTECTION
- PROPOSED AREA INLET PROTECTION
- PROPOSED DITCH CHECK
- PROPOSED BACK OF CURB PROTECTION
- PROPOSED STABILIZED CONSTRUCTION ENTRANCE

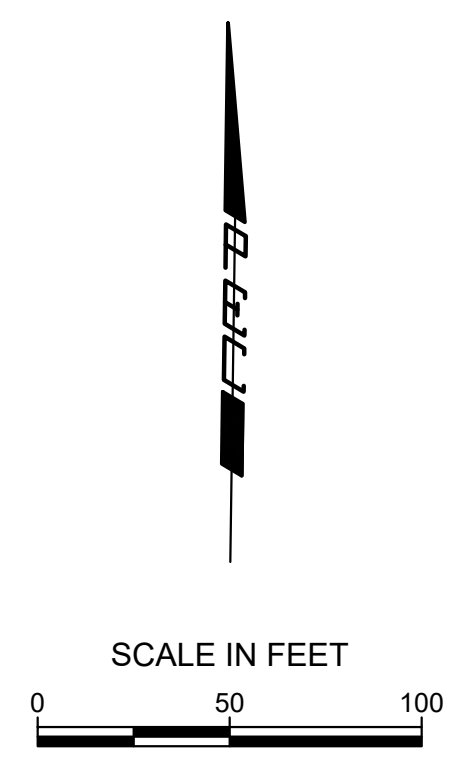

SAVED 10/10/2023 11:03:51 AM BY KURTIS.DEKAT
 PLOTTED 10/12/2023 10:09:55 AM BY KURTIS.DEKAT
 U:\WICHITA-CIVIL\2021\210975\007\PEC\DRAWINGS\210975-007-CU-504.DWG

JOB NO.	210975-007
DATE	SEPTEMBER 2023
PM	GAS
DESIGNED BY	SNW
DRAWN BY	AJH
CHECKED BY	GAS

EROSION CONTROL PLAN

CU-504
15 OF 21