

U:\WICHITA-CIVIL\2021\210975001\PEC\DRAWINGS\42-210975-004-CG101-EROSION CONTROL PLAN.DWG  
 PLOTTED 1/9/2024 4:28:19 PM BY BILL SEXSON  
 SAVED 1/9/2024 4:08:36 PM BY BILL SEXSON

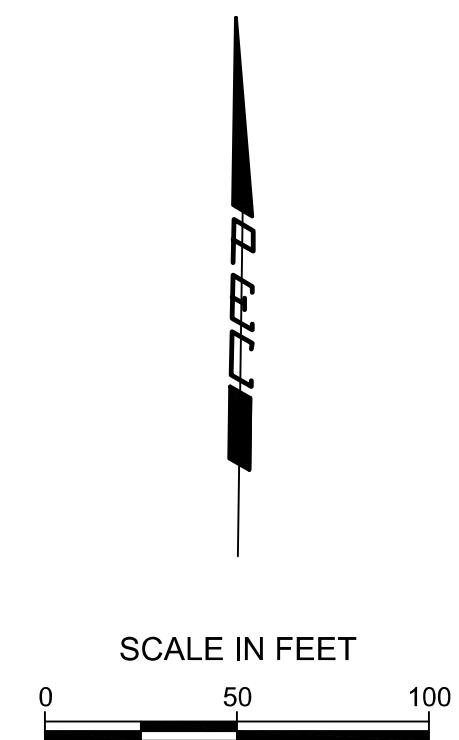
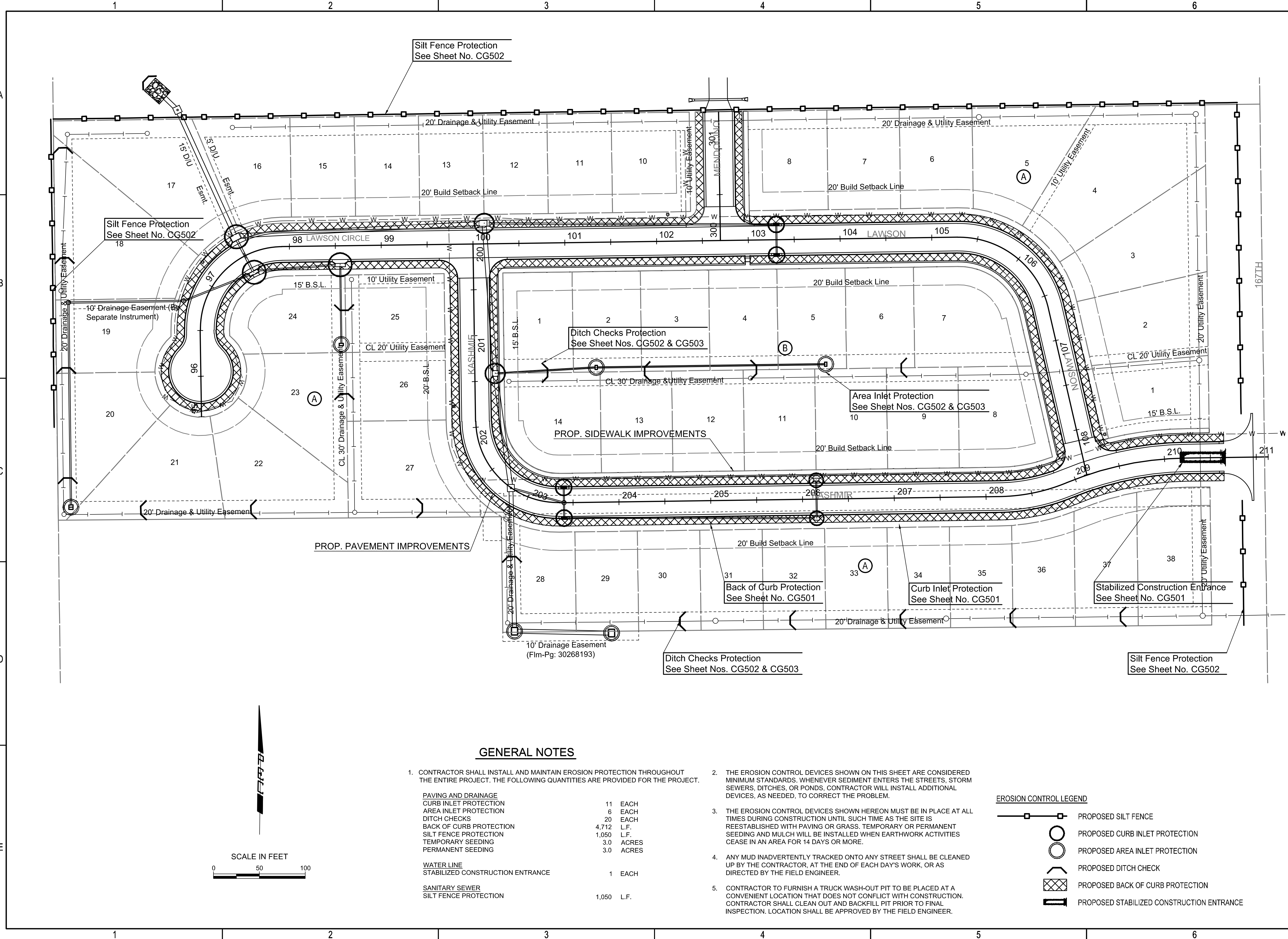

**GENERAL NOTES**

- CONTRACTOR SHALL INSTALL AND MAINTAIN EROSION PROTECTION THROUGHOUT THE ENTIRE PROJECT. THE FOLLOWING QUANTITIES ARE PROVIDED FOR THE PROJECT.
 

PAVING AND DRAINAGE	
CURB INLET PROTECTION	11 EACH
AREA INLET PROTECTION	6 EACH
DITCH CHECKS	20 EACH
BACK OF CURB PROTECTION	4,712 L.F.
SILT FENCE PROTECTION	1,050 L.F.
TEMPORARY SEEDING	3.0 ACRES
PERMANENT SEEDING	3.0 ACRES
- THE EROSION CONTROL DEVICES SHOWN ON THIS SHEET ARE CONSIDERED MINIMUM STANDARDS. WHENEVER SEDIMENT ENTERS THE STREETS, STORM SEWERS, DITCHES, OR PONDS, CONTRACTOR WILL INSTALL ADDITIONAL DEVICES, AS NEEDED, TO CORRECT THE PROBLEM.
- THE EROSION CONTROL DEVICES SHOWN HEREON MUST BE IN PLACE AT ALL TIMES DURING CONSTRUCTION UNTIL SUCH TIME AS THE SITE IS REESTABLISHED WITH PAVING OR GRASS. TEMPORARY OR PERMANENT SEEDING AND MULCH WILL BE INSTALLED WHEN EARTHWORK ACTIVITIES CEASE IN AN AREA FOR 14 DAYS OR MORE.
- ANY MUD INADVERTENTLY TRACKED ONTO ANY STREET SHALL BE CLEANED UP BY THE CONTRACTOR, AT THE END OF EACH DAY'S WORK, OR AS DIRECTED BY THE FIELD ENGINEER.
- CONTRACTOR TO FURNISH A TRUCK WASH-OUT PIT TO BE PLACED AT A CONVENIENT LOCATION THAT DOES NOT CONFLICT WITH CONSTRUCTION. CONTRACTOR SHALL CLEAN OUT AND BACKFILL PIT PRIOR TO FINAL INSPECTION. LOCATION SHALL BE APPROVED BY THE FIELD ENGINEER.

**EROSION CONTROL LEGEND**

- PROPOSED SILT FENCE
- PROPOSED CURB INLET PROTECTION
- PROPOSED AREA INLET PROTECTION
- PROPOSED DITCH CHECK
- PROPOSED BACK OF CURB PROTECTION
- PROPOSED STABILIZED CONSTRUCTION ENTRANCE

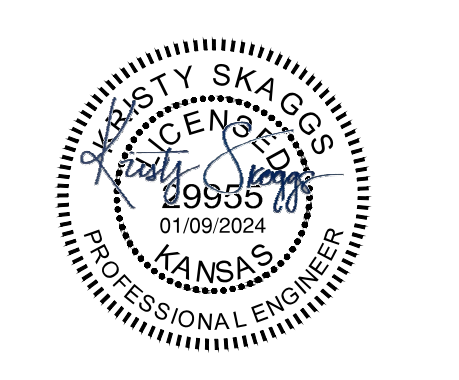

**PAVING AND INCIDENTAL DRAINAGE IMPROVEMENTS**  
**CYPRESS GLEN ADDITION-PHASE 1**  
 PAUL GUNZELMAN CITY ENGINEER  
 CITY OF WICHITA PROJECT NO. 472-2023-085915

Issue:	

JOB NO.	210975-004
DATE	OCTOBER 2023
PM	RJS
DESIGNED BY	KMS
DRAWN BY	BJS
CHECKED BY	TPA

EROSION CONTROL PLAN