

File: L:\2023\23F00200 - Edgemoor Park Plaza Repairs\Drawings\EDGPK-G-102.dwg Last Save: 10/18/2023 3:50 PM Last saved by: B\Gillespie
 Last plotted by: Thomas, Brent D. Plot Style: AECmonochrome.ctb Plot Scale: 1:1 Plot Date: 11/21/2023 12:05 PM Plotter used: _AutocAD PDF (General Documentation).pc3

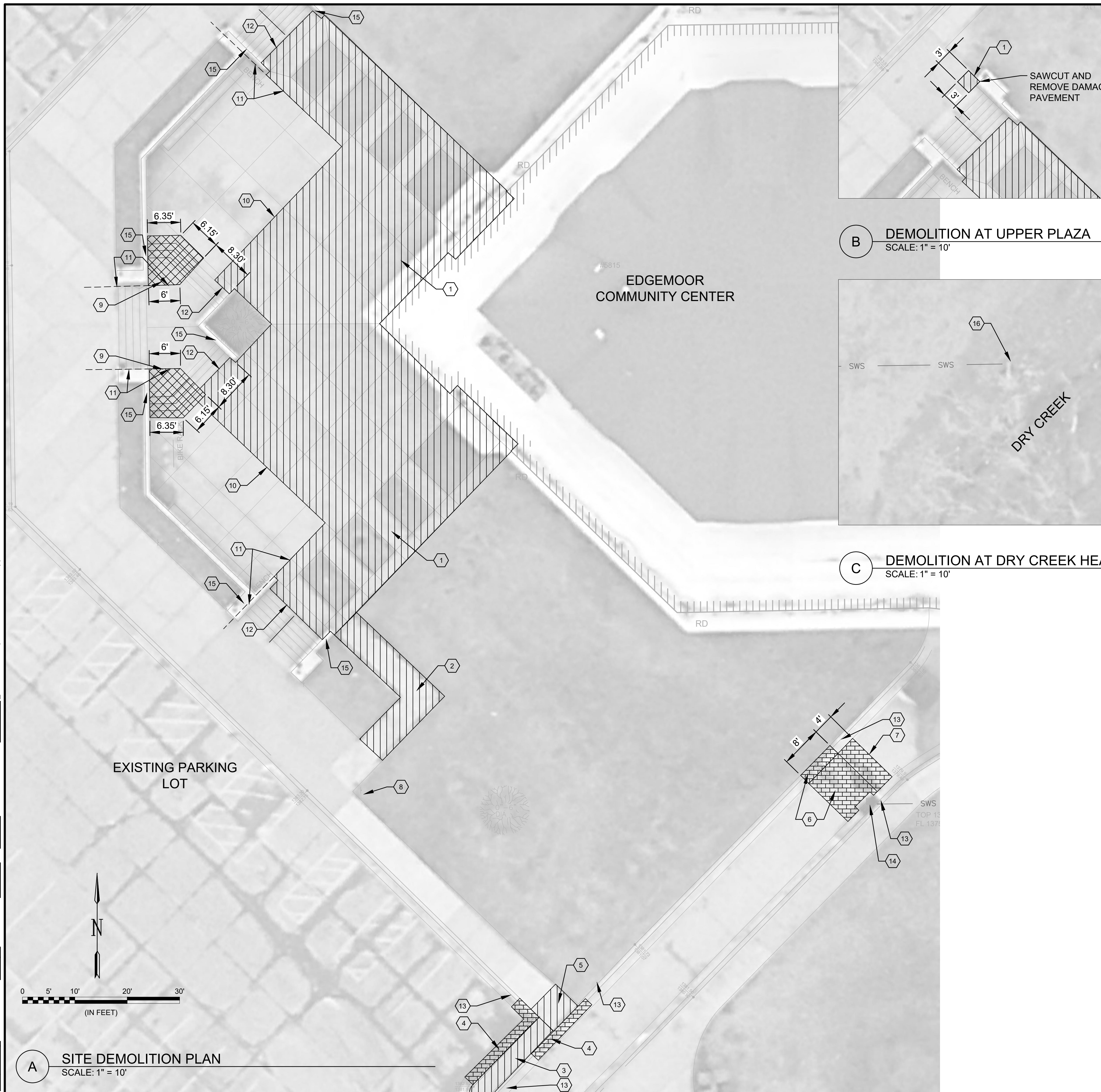

A SITE DEMOLITION PLAN
SCALE: 1" = 10'

B DEMOLITION AT UPPER PLAZA
SCALE: 1" = 10'

C DEMOLITION AT DRY CREEK HEADWALL
SCALE: 1" = 10'

DEMOLITION NOTES

1. CAUTION: UNDERGROUND UTILITIES LIE WITHIN AND ADJACENT TO THE LIMITS OF CONSTRUCTION. AN ATTEMPT HAS BEEN MADE TO LOCATE THESE UTILITIES ON THE PLANS, HOWEVER ALL EXISTING UTILITIES MAY NOT BE SHOWN AND THE ACTUAL LOCATIONS OF THE UTILITIES MAY VARY FROM LOCATIONS SHOWN. PRIOR TO BEGINNING ANY TYPE OF EXCAVATION, THE CONTRACTOR SHALL MARK THE VISIBLE UTILITIES & THE UTILITIES SHOWN ON THE PLANS IN THE FIELD. THE CONTRACTOR SHALL MAINTAIN THE UTILITY LOCATION MARKING UNTIL THEY ARE NO LONGER NECESSARY.
2. THE CONTRACTOR IS RESPONSIBLE FOR THE APPROPRIATE BARRICADES AND SAFETY PRECAUTIONS IN ALL EXCAVATED AREAS. EXCAVATED AREAS SHALL BE ADEQUATELY FILLED OR COVERED BY THE CONTRACTOR BEFORE LEAVING THE JOBSITE EACH DAY.
3. CONTRACTOR IS RESPONSIBLE FOR ANY DAMAGE CAUSED TO EXISTING STRUCTURES, PAVEMENTS, AND UTILITIES.
4. CONTRACTOR SHALL PROVIDE TEMPORARY ACCESS TO THE SITE DURING CONSTRUCTION.
5. THE CONTRACTOR SHALL MAINTAIN THE SITE IN AN ORDERLY AND CLEAN FASHION.
6. PROTECT EXISTING TREES DURING DEMOLITION AND EXCAVATION ACTIVITIES. DO NOT STORE MATERIALS, DRIVE WITHIN, OR EXCAVATE WITHIN DRIPLINE. HAND DIG ONLY WHEN NECESSARY.
7. PROTECT EXISTING PARK IMPROVEMENTS DURING ALL DEMOLITION AND CONSTRUCTION ACTIVITIES. LAY PLYWOOD OVER EXISTING PAVEMENTS WHERE VEHICLES WILL DRIVE OVER THEM TO PREVENT SURFACE MARRING.
8. ALL WASTE MATERIALS GENERATED FROM CONSTRUCTION BECOME THE PROPERTY OF THE CONTRACTOR. THE CONTRACTOR SHALL REMOVE THE WASTE MATERIALS FROM THE SITE AND DISPOSE OF IN A LEGAL MANNER.
9. ALL PAVEMENTS TO BE REMOVED SHALL BE SAW CUT IN A NEAT AND PROFESSIONAL MANNER TO FACILITATE DEMOLITION. SAW CUT SIDEWALKS TO NEAREST JOINT.

LEGEND

- REMOVE EXISTING CONCRETE SIDEWALK PAVEMENT (BOTH STANDARD GRAY AND RED STAMPED)
3,940 S.F.
- CONCRETE DRIVE PAVEMENT AND CURB & GUTTER REMOVAL
210 S.F.
- STAIR REMOVAL
160 S.F.

KEYNOTES

- ① REMOVE EXISTING CONCRETE SIDEWALK PAVEMENT, INCLUDING RED STAMPED CONCRETE
- ② REMOVE EXISTING ACCESSIBLE RAMP AND RAILING
- ③ REMOVE EXISTING CONCRETE PAVEMENT IN ISLAND
- ④ REMOVE CURB AND GUTTER
- ⑤ REMOVE EXISTING CURB RAMP
- ⑥ REMOVE FULL CONCRETE PANEL AND ADJACENT DEPRESSED CURB
- ⑦ REMOVE PARTIAL CONCRETE PANEL AS INDICATED
- ⑧ REMOVE AND SALVAGE ACCESSIBLE PARKING SIGN FOR RE-USE
- ⑨ SAWCUT AND REMOVE STAIRS AND ADJACENT SLAB AS INDICATED
- ⑩ REMOVE PAVEMENT TO EXISTING JOINT
- ⑪ PAVEMENT TO ALIGN WITH EDGE OF WALL AS INDICATED
- ⑫ REMOVE PAVEMENT TO BOTTOM OF STAIRS. PROTECT STAIRS.
- ⑬ PROTECT CURB TO REMAIN
- ⑭ PROTECT AREA INLET TO REMAIN
- ⑮ PROTECT BRICK WALL TO REMAIN
- ⑯ REMOVE DAMAGED HEADWALL AND PIPE SEGMENT AT DRY CREEK



© 2023 GARVER, LLC
 THIS DOCUMENT, ALONG WITH THE IDEAS AND DESIGNS CONVEYED HEREIN, SHALL BE CONSIDERED INSTRUMENTS OF PROFESSIONAL SERVICE AND ARE PROPERTY OF GARVER, LLC. ANY USE, REPRODUCTION, OR DISTRIBUTION OF THIS DOCUMENT, ALONG WITH THE IDEAS AND DESIGN CONTAINED HEREIN, IS PROHIBITED UNLESS AUTHORIZED IN WRITING BY GARVER, LLC OR EXPLICITLY ALLOWED IN THE GOVERNING PROFESSIONAL SERVICES AGREEMENT FOR THIS WORK.

1995 Midfield Road
 Wichita, KS 67209
 (316) 264-8008

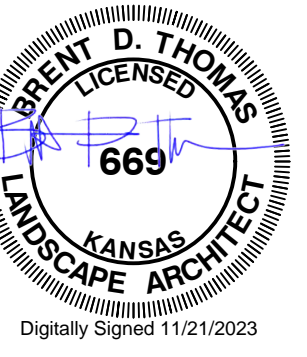

REV.	DATE	DESCRIPTION	BY

CITY OF WICHITA
 DEPT. OF PARK & RECREATION
 WICHITA, KANSAS

EDGEMOOR PARK
 PLAZA REPAIRS

SITE DEMOLITION PLAN

JOB NO.: 22F00030
 DATE: NOV 2023
 DESIGNED BY: BDT
 DRAWN BY: BIG

BAR IS ONE INCH ON ORIGINAL DRAWING
 IF NOT ONE INCH ON THIS SHEET, ADJUST SCALES ACCORDINGLY.

DRAWING NUMBER
CD-101

SHEET NUMBER