

SCALE: 1"=100'

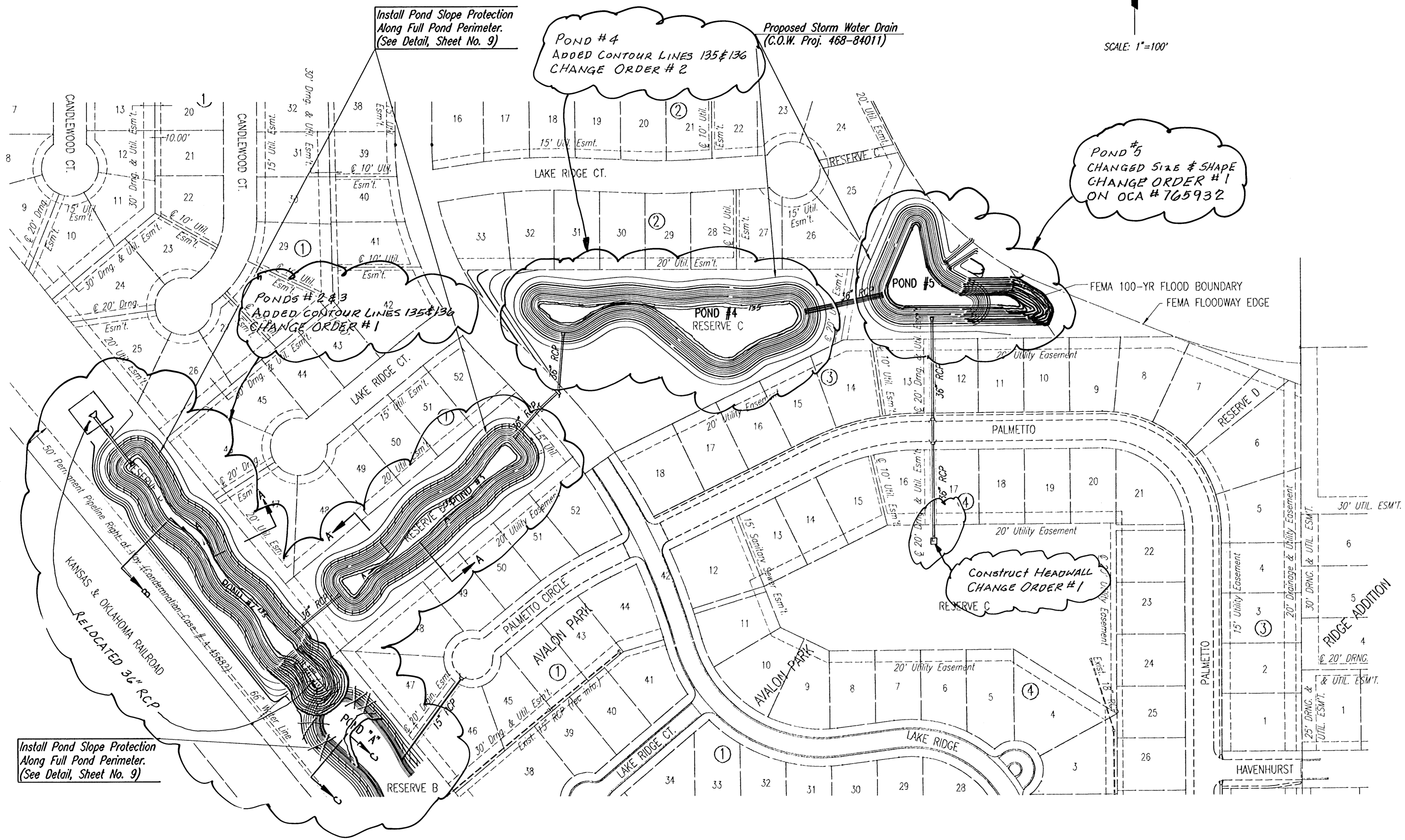

GENERAL NOTES

1. THE EROSION CONTROL DEVICES SHOWN ON THIS SHEET ARE CONSIDERED MINIMUM STANDARDS. WHENEVER SEDIMENT ENTERS THE STREETS, STORM SEWERS, DITCHES, OR PONDS, CONTRACTOR WILL INSTALL ADDITIONAL DEVICES, AS NEEDED, TO CORRECT THE PROBLEM.
2. THE EROSION CONTROL DEVICES SHOWN HEREON MUST BE IN PLACE AT ALL TIMES DURING CONSTRUCTION UNTIL SUCH TIME AS THE SITE IS REESTABLISHED WITH PAVING OR GRASS. TEMPORARY OR PERMANENT AND MULCH WILL BE INSTALLED WHEN EARTHWORK ACTIVITIES CEASE IN AN AREA FOR 14 DAYS OR MORE.
3. ANY MUD INADVERTENTLY TRACKED ONTO ANY STREET WILL BE CLEANED UP BY THE CONTRACTOR, AT THE END OF EACH DAY'S WORK.
4. CONTRACTOR TO FURNISH A TRUCK WASH-OUT PIT TO BE PLACED AT A CONVENIENT AND OBVIOUS LOCATION THAT DOES NOT CONFLICT WITH CONSTRUCTION. CONTRACTOR SHALL CLEAN OUT AND BACKFILL PIT PRIOR TO FINAL INSPECTION.

LEGEND

Pond Slope Protection (See Detail, Sheet No. 9)

[Signature]
02 OCT 04
RECORD DRAWING

DSNR: BLB OPER: BUS SCALE: 1"=100.00
 01/2005/05258/05258-C-EROSIONCONTROL 06-16-2005 10:56:29 am

| | <table border="1"> <tr> <th>No.</th> <th>Revision</th> <th>By</th> <th>Date</th> </tr> <tr> <td> </td> <td> </td> <td> </td> <td> </td> </tr> </table> | No. | Revision | By | Date | | | | | <p>AVALON PARK 3RD STORM WATER DRAIN NO. 265</p> <p>EROSION CONTROL (BMP) PLAN</p> <p>JAMES L. ARMOUR, P.E.-CITY ENGINEER CITY OF WICHITA PROJECT NO. 468-84012</p> <p>Professional Engineering Consultants, P.A. 303 S. TOPEKA • WICHITA, KANSAS 67202 316-262-2691 • FAX 316-262-3003</p> |
|----------------------|--|-------------------------|----------|------|------|--|--|--|--|---|
| | No. | Revision | By | Date | | | | | | |
| | | | | | | | | | | |
| | <p>Designed by: BOB, BLB</p> | <p>Job No. 35-05258</p> | | | | | | | | |
| <p>Drawn by: BJS</p> | <p>Date: February 2005</p> | | | | | | | | | |
| <p>SH. 16 of 35</p> | | | | | | | | | | |