

BENCHMARKS:
 BM #1: "□" Cut on T.C., 12' west of east end of N curb return on the north drive entrance of the Church of the Magdalen.
 Elev. = 190.48 (City Datum)

BM #2: RR spike on the west face of PP on the east side of 127th Street East, adjacent to the south line of The Fairmont Addition.
 Elev. = 187.25 (City Datum)

BM #3: RR spike on the east face of PP on the west side of 127th Street East, 37' N and 13' E of the NE corner of Lot 1, Block H, The Fairmont Addition.
 Elev. = 189.19 (City Datum)

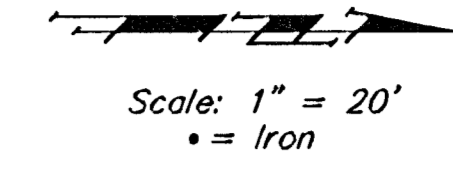

P.V.I.
 Elev. = 196.62
 No V.C.

Sta 2+12.00

Sta 2+48.76-PC

BOXTHORN

AYESBURY

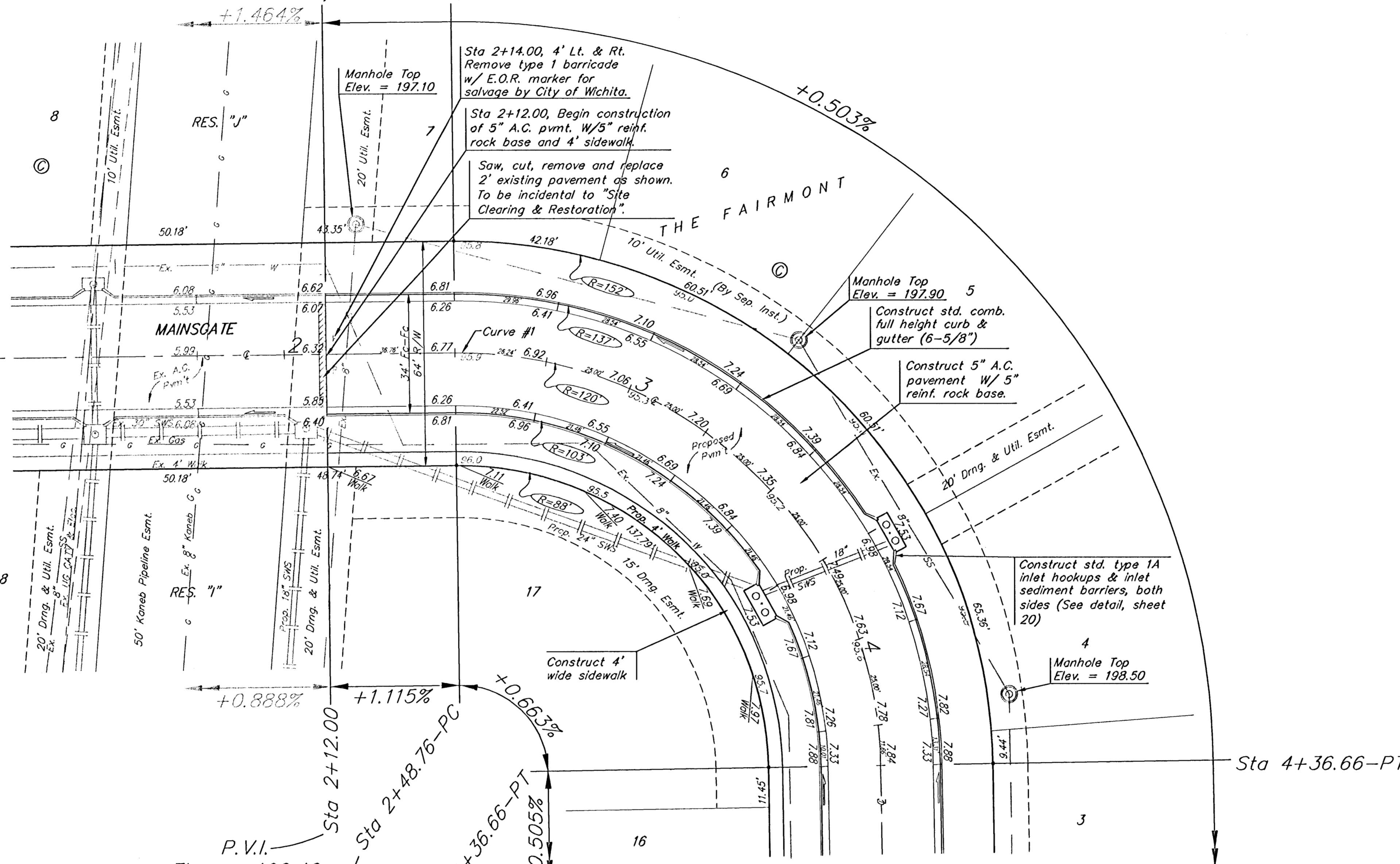

P.V.I.
 Elev. = 196.40
 No V.C.

P.V.I.
 Elev. = 196.81
 No V.C.

P.V.I.
 Elev. = 197.88
 No V.C.

Curve #1
 Curve Data Based on Centerline
 Rad. = 120' Delta = 89° 42' 58" Tangent = 119.41'
 Arc = 187.9' L.C. = 169.28' Def/Ft. = 14.32402 Min.

Station	Arc	FACE CHORD LENGTHS			Def.	I. Def.
		8' Lt.	8' Rt.	8' Ch.		
2+48.76	-	-	-	-	0'00"00"	0'00"00"
2+50.00	1.24'	1.50'	0.98'	0'17"46"	0'17"46"	0'17"46"
2+75.00	25.00'	30.15'	19.76'	5'58"06"	6'15"52"	6'15"52"
3+00.00	25.00'	30.15'	19.76'	5'58"06"	12'13"58"	12'13"58"
3+25.00	25.00'	30.15'	19.76'	5'58"06"	18'12"04"	18'12"04"
3+50.00	25.00'	30.15'	19.76'	5'58"06"	24'10"10"	24'10"10"
3+75.00	25.00'	30.15'	19.76'	5'58"06"	30'08"16"	30'08"16"
4+00.00	25.00'	30.15'	19.76'	5'58"06"	36'06"22"	36'06"22"
4+25.00	25.00'	30.15'	19.76'	5'58"06"	42'04"28"	42'04"28"
4+36.66	11.66'	14.08'	9.23'	2'47"01"	44'51"29"	44'51"29"

Subdivision Bench Marks

Street & Station	Location Description	Elevation
Mainsgate 7+98.11, 17.25' Rt.	Adjacent to Fire Hydrant near common lot corner of Lots 11 & 12, Block D.	
Mainsgate 13+97.74, 17.25' Rt.	Adjacent to Fire Hydrant near common lot corner of Lots 4 & 5, Block D.	

Baughman THE FAIRMONT - PHASE III
MAINSGATE
 STA 2+12.00 TO STA 4+36.66

Baughman Company, P.A. 315 E. 11th St. Wichita, KS 67211 P 316-262-7271 F 316-262-0149
 ENGINEERING | SURVEYING | PLANNING | LANDSCAPE ARCHITECTURE

PROJECT NUMBER 472-83485	DESIGN ATD	DRAWN TMS
REVISIONS:	APPROVED	DATE 09/05
SCALE Noted		SHEET 6 OF 27

FairmontPhaseIII/Str1 0404-E871