

DSNR: JPS OPER: MJW SCALE: 1"=200' / GEOMETRY/06471-GEOMETRY142.DGN LAST REV: 5-31-2007 BY: svb

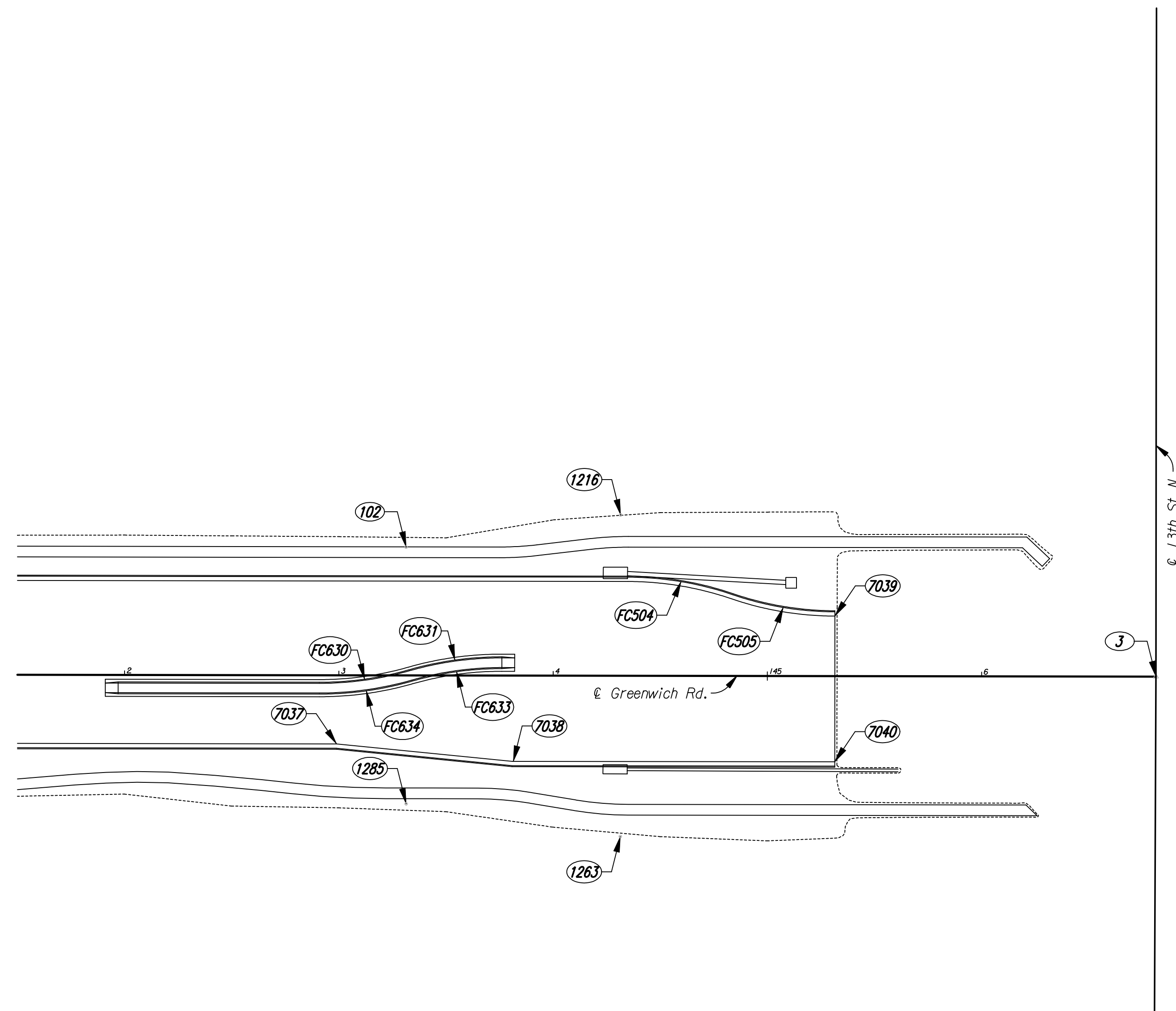

CONTROL POINTS					
POINT NO.	NORTH COORDINATE	EAST COORDINATE	STATION	OFFSET	DESCRIPTION
3	1,694,476.4532	1,686,290.3343	146+81.32	0.00' Rt.	NW Corner Sec. 15-T27S-R2E
101	1,694,545.1133	1,686,322.4167	147+49.37	33.35' Rt.	PK Nail
102	1,694,125.3898	1,686,236.9435	143+31.31	59.88' Lt.	#5 Bar
1216	1,694,225.1544	1,686,219.9320	144+31.37	75.04' Lt.	Property Iron
1285	1,694,127.8184	1,686,356.6941	143+31.52	59.90' Rt.	Property Iron
1263	1,694,228.0466	1,686,369.9277	144+31.49	74.98' Rt.	Property Iron

COORDINATE TABLE					
POINT NO.	NORTH COORDINATE	EAST COORDINATE	STATION	OFFSET	DESCRIPTION
7037	1,694,094.7868	1,686,329.4035	142+99.00	32.00' Rt.	Edge of Pvmf. P.I.
7038	1,694,177.4207	1,686,335.8755	143+81.50	40.00' Rt.	Edge of Pvmf. P.I.
7039	1,694,326.1367	1,686,265.1115	145+31.50	28.00' Lt.	Edge of Pvmf. / Edge of Curb
7040	1,694,327.3950	1,686,333.0998	145+31.50	40.00' Rt.	Edge of Pvmf. / Edge of Curb

NO.	Δ	R	T	L	E	P.C. COORDINATES				P.I. COORDINATES				P.T. COORDINATES		C.C. COORDINATES	
						NORTH		EAST		NORTH		EAST		NORTH	EAST	NORTH	EAST
FC504	18°47'49" Rt.	152.00'	25.16'	49.87'	2.07'	1,694,229.1558	1,686,248.9032	1,694,254.3107	1,686,248.4377	1,694,278.2740	1,686,256.1022	1,694,231.9684	1,686,400.8772				
FC505	18°42'48" Lt.	148.00'	24.50'	48.55'	2.01'	1,694,278.2740	1,686,256.1022	1,694,301.6067	1,686,263.5651	1,694,326.0997	1,686,263.1118	1,694,323.3610	1,686,115.1371				
FC630	16°02'46" Lt.	151.25'	21.32'	42.36'	1.50'	1,694,086.1861	1,686,300.8077	1,694,107.5015	1,686,300.4132	1,694,127.8773	1,686,294.1422	1,694,083.3873	1,686,149.5836				
FC631	16°02'46" Rt.	156.75'	22.09'	43.90'	1.55'	1,694,127.8773	1,686,294.1422	1,694,148.9941	1,686,287.6432	1,694,171.0846	1,686,287.2344	1,694,173.9852	1,686,443.9575				
FC633	16°02'46" Lt.	151.25'	21.32'	42.36'	1.50'	1,694,171.1864	1,686,292.7334	1,694,149.8710	1,686,293.1279	1,694,129.4952	1,686,299.3989	1,694,173.9852	1,686,443.9575				
FC634	16°02'46" Rt.	156.75'	22.09'	43.90'	1.55'	1,694,129.4952	1,686,299.3989	1,694,108.3783	1,686,305.8979	1,694,086.2879	1,686,306.3067	1,694,083.3873	1,686,149.5836				

	Revision		By	Date
	GREENWICH ROAD			
	<b>COORDINATE GEOMETRY PLAN</b> STA. 142+00 TO STA. 146+00 JAMES L. ARMOUR, P.E. - CITY ENGINEER CITY OF WICHITA PROJECT NO. 472-84435			
	<b>Professional Engineering Consultants, P.A.</b> 303 S. TOPEKA • WICHITA, KANSAS 67202 316-262-2691 • FAX 316-262-3003			
Designed by	JPS	Job No.	06471	Sht. 16 of 97
Drawn by	MJW	Date	June, 2007	