

# FALCON FALLS 3RD ADDITION WICHITA, SEDGWICK COUNTY, KANSAS

PT#	NORTHING	EASTING	DESC
1	5029.3262	7411.0722	IRON
2	5031.0446	7705.1666	IRON
3	5031.6633	7811.0653	IRON
4	5092.0123	7870.6146	IRON
5	5173.5697	7620.3325	IRON
6	5185.6048	7704.2636	IRON
7	5244.6954	7737.9243	IRON
8	5282.0071	7675.9627	IRON
9	5311.7322	7725.7690	IRON
10	5303.2225	7837.9634	IRON
11	5358.4632	7805.6452	IRON
12	5400.1632	7837.1496	IRON
13	5384.1694	7899.1190	IRON
14	5439.0509	7913.2834	IRON
15	5455.0446	7851.3140	IRON
16	5524.8252	7896.2837	IRON
17	5490.0576	7979.1258	IRON
18	5551.7137	7954.3613	IRON
19	5554.0576	7979.1258	IRON
20	5490.0576	8197.6676	IRON
21	5554.0576	8197.6676	IRON
22	5617.4616	8265.5121	IRON
23	5613.1359	8329.3657	IRON
24	5908.7099	8285.2422	IRON
25	5904.3842	8349.0959	IRON
26	6002.2123	8315.2685	IRON
27	6021.5665	8429.1005	IRON
28	6050.6922	8357.0502	IRON
29	6079.4612	8401.8203	IRON
30	6187.0889	8469.5193	IRON
31	6187.5686	8535.5175	IRON
32	6422.5889	8467.7542	IRON
33	6423.0686	8531.7525	IRON
34	6458.1501	8431.6560	IRON
35	6459.1668	8567.3136	IRON
36	6522.1483	8431.1764	IRON
37	6558.2465	8466.7375	IRON
38	6662.4129	8465.9568	IRON
39	6061.4236	8258.0695	IRON
40	6101.5048	8307.9644	IRON
41	6337.5731	8036.2352	IRON
42	6377.6542	8086.1300	IRON
43	6407.3554	8075.5525	IRON
44	6406.8757	8011.5543	IRON
45	6454.9987	8011.1937	IRON
46	6455.4784	8075.1919	IRON
47	5316.5529	7655.7519	IRON
48	5345.8412	7705.8138	IRON
49	5405.6012	7631.2583	IRON
50	5406.0359	7689.2566	IRON
51	5507.0966	7630.4976	IRON
52	5507.5313	7688.4959	IRON
53	5586.3851	7867.7829	IRON
54	5613.2736	7925.8605	IRON
55	5697.5094	7869.8856	IRON
56	5654.3826	7822.5984	IRON
57	5839.4506	7653.8134	IRON
58	5882.5773	7701.1007	IRON
59	5927.4102	7619.3471	IRON
60	5927.8898	7683.3453	IRON
61	6384.0343	7615.9247	IRON
62	6384.5139	7679.9229	IRON
63	6477.5667	7653.7946	IRON
64	6508.9813	7702.5504	IRON
65	6453.0217	7747.4114	IRON
66	6517.0199	7746.9317	IRON
67	6501.9538	7638.0814	IRON
68	6533.3684	7686.8372	IRON
69	6571.2920	7675.5229	IRON
70	6570.8573	7617.5246	IRON
71	6765.8239	7616.0633	IRON
72	6766.2586	7674.0617	IRON
73	6460.4722	8741.4780	IRON
74	6524.4704	8740.9983	IRON
75	6525.0100	8812.9963	IRON
76	6461.0118	8813.4760	IRON
77	6472.6839	8866.7646	IRON
78	6507.5660	8913.1030	IRON
79	6470.9128	8940.6944	IRON
80	6436.0307	8894.3560	IRON
81	6412.5017	8915.5782	IRON
82	6394.4236	8903.5901	IRON
83	6333.3670	8885.4347	IRON
84	6277.3584	8885.8545	IRON
85	6277.7931	8943.8528	IRON
86	6333.8017	8943.4330	IRON
87	6362.3694	8951.9278	IRON
88	6380.4475	8963.9159	IRON
89	6422.6839	9037.3658	IRON
90	6364.6839	9037.3658	IRON
91	6364.6839	9063.4767	IRON
92	6422.6839	9063.4767	IRON
93	6514.4610	9180.8948	IRON
94	6500.4533	9237.1779	IRON
95	6703.4813	9227.9380	IRON
96	6689.4737	9284.2211	IRON
97	6593.5177	8880.4848	IRON
98	6593.9974	8944.4830	IRON
99	6987.4223	8877.5325	IRON
100	6987.9019	8941.5307	IRON

PT#	NORTHING	EASTING	DESC
101	7075.4563	8910.2956	IRON
102	7110.9958	8960.5685	IRON
103	7056.4114	9009.6699	IRON
104	7120.4113	9009.8027	IRON
105	7055.7918	9308.1871	IRON
106	7119.7917	9308.3200	IRON
107	7146.4800	9362.4736	IRON
108	7107.5985	9413.3090	IRON
109	7207.4721	9489.6974	IRON
110	7246.3535	9438.8621	IRON
111	7287.5240	9452.8494	IRON
112	7287.3911	9516.8493	IRON
113	7356.3591	9516.9924	IRON
114	7356.4919	9452.9926	IRON
115	7357.3453	9041.8212	IRON
116	7379.3234	8954.5000	IRON
117	7399.5267	8954.5000	IRON
118	7421.3452	9041.9541	IRON
119	7420.3589	9517.1253	IRON
120	7448.7878	9572.5668	IRON
121	7411.5445	9624.6143	IRON
122	7526.0439	9627.8485	IRON
123	7488.8007	9679.8960	IRON
124	7567.9320	9677.4577	IRON
125	7510.3794	9705.4522	IRON
126	7583.2152	9771.4886	IRON
127	7605.3120	9779.6769	IRON
128	7605.4535	9711.4765	IRON
129	6998.4056	7396.3140	IRON
130	7001.5459	7815.3022	IRON
131	6657.5556	7817.8804	IRON
132	7124.8351	8736.4986	IRON
133	7163.2590	8810.1983	IRON
134	7223.1455	8915.7758	IRON
135	7240.5263	8954.5000	IRON
136	7607.0247	8954.5000	IRON
137	7521.7750	9445.0676	IRON
138	7372.3452	9445.0630	IRON
139	7238.5272	9366.0827	IRON
140	6959.4237	9677.0829	IRON
141	6959.2123	9308.0833	IRON
142	6726.3400	9790.9244	IRON
143	6355.1224	9687.8530	IRON
144	5884.2252	9422.9453	IRON
145	5755.5586	9297.0687	IRON
146	5685.6290	9036.2818	IRON
147	5607.7868	8944.9549	IRON
148	5452.1227	8881.7671	IRON
149	5175.7087	8720.5365	IRON
150	5121.7327	8668.4636	IRON
151	5040.1692	8411.0920	IRON
152	5095.1683	8410.7706	IRON

PT#	NORTHING	EASTING	DESC
700	5999.6514	8091.4054	SWS
701	6114.9400	8231.5361	SWS
702	6126.6341	8222.1421	SWS
703	6103.2459	8240.9301	SWS
704	6138.9511	8261.4263	SWS
705	6150.6452	8252.0322	SWS
706	6127.2570	8270.8203	SWS
707	6209.5010	8334.3850	SWS
708	6307.4109	8333.5762	SWS
709	5144.1445	7773.4503	SWS
710	5141.8635	7683.0326	SWS
711	5156.7108	7680.8976	SWS
712	5127.0162	7685.1676	SWS
713	5141.6825	7642.0134	SWS
714	5156.5548	7643.9666	SWS
715	5126.8103	7640.0602	SWS
716	5144.9366	7515.2086	SWS
717	5304.9324	7514.0095	SWS
718	6214.8420	8482.1450	SWS
719	6229.8416	8482.0326	SWS
720	6199.8425	8482.2574	SWS
721	6215.1293	8520.4773	SWS
722	6230.1289	8520.3648	SWS
723	6200.1298	8520.5897	SWS
724	6213.7110	8677.9777	SWS

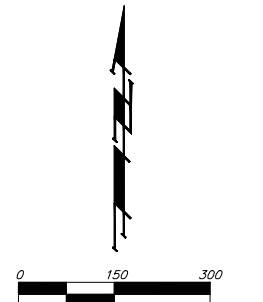

- = #4 REBAR W/ "BAUGHMAN" CAP (FOUND)
- = #4 REBAR W/ "BAUGHMAN" CAP (SET)
- = #1 PIPE (FOUND)
- = 1/2" PIPE (FOUND)
- = 3/4" PIPE (FOUND)
- = STONE (FOUND)
- = SECTION CORNER (FOUND)

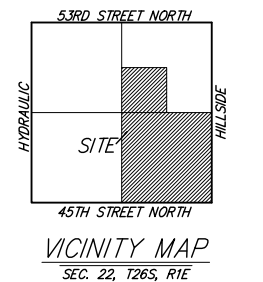

	FALCON FALLS 3RD ADDITION - PH. I	
	<b>STAKING COORDINATE SHEET</b>	
SWS IMPROVEMENTS		
Baughman Company, P.A. 315 8th St. Wichita, KS 67211 P 3162627271 F 3162620149		
ENGINEERING   SURVEYING   PLANNING   LANDSCAPE ARCHITECTURE		
PROJECT NUMBER 468-8409	DATE 7-26-06	DRAWN TJW
REVISIONS:	APPROVED ABC	DATE 7-26-06
	SCALE Noted	
<b>16 OF 17</b>		
F:\STAKE\FALCON FALLS 3RD\SWS\coords.DWG		06-04-E534